

Operating Guide

AB-QM DN 125-250 / 73693690

AB-QM DN 125-250

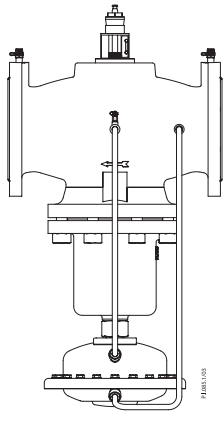

AB-QM DN 125

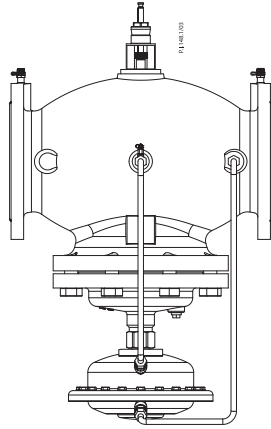

AB-QM DN 150

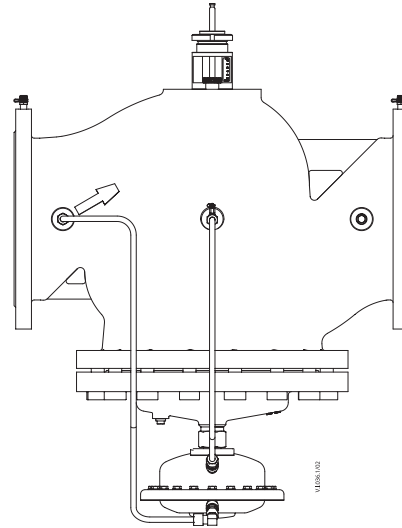

AB-QM DN 200/250

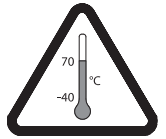

Installation

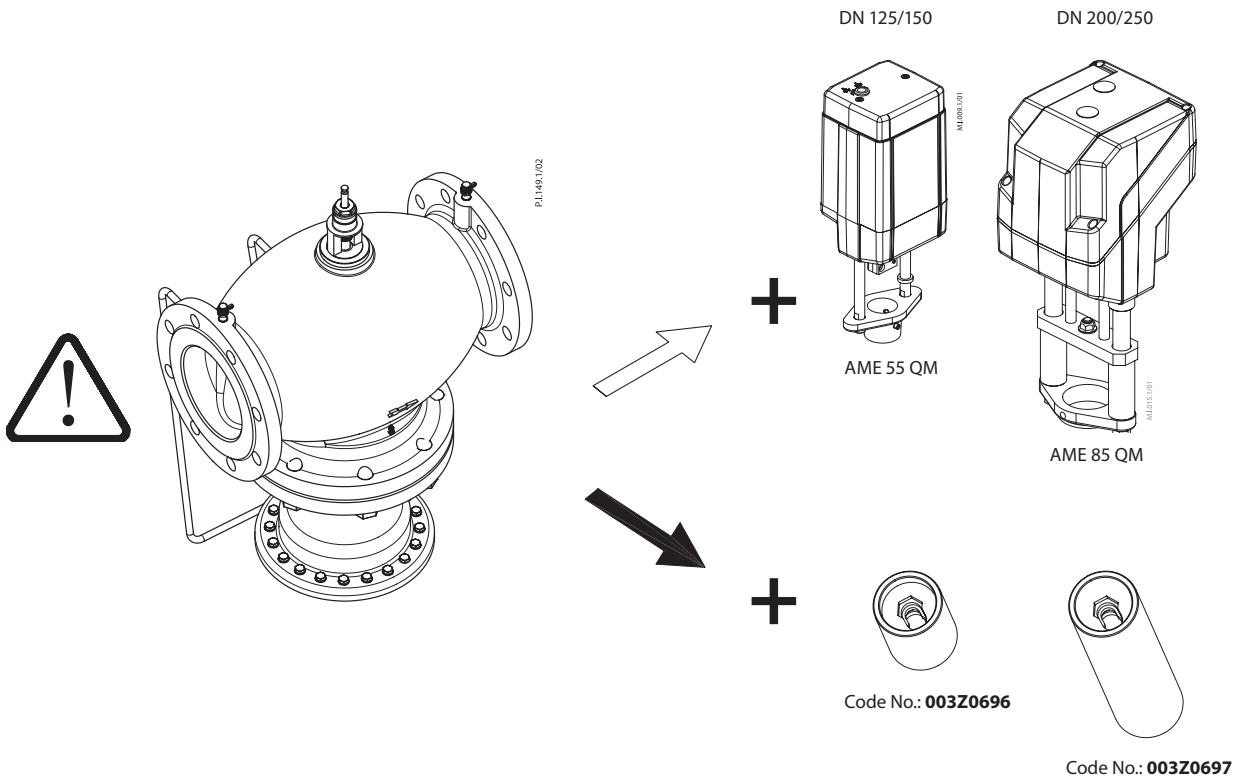

AB-QM DN 125-250

Installation

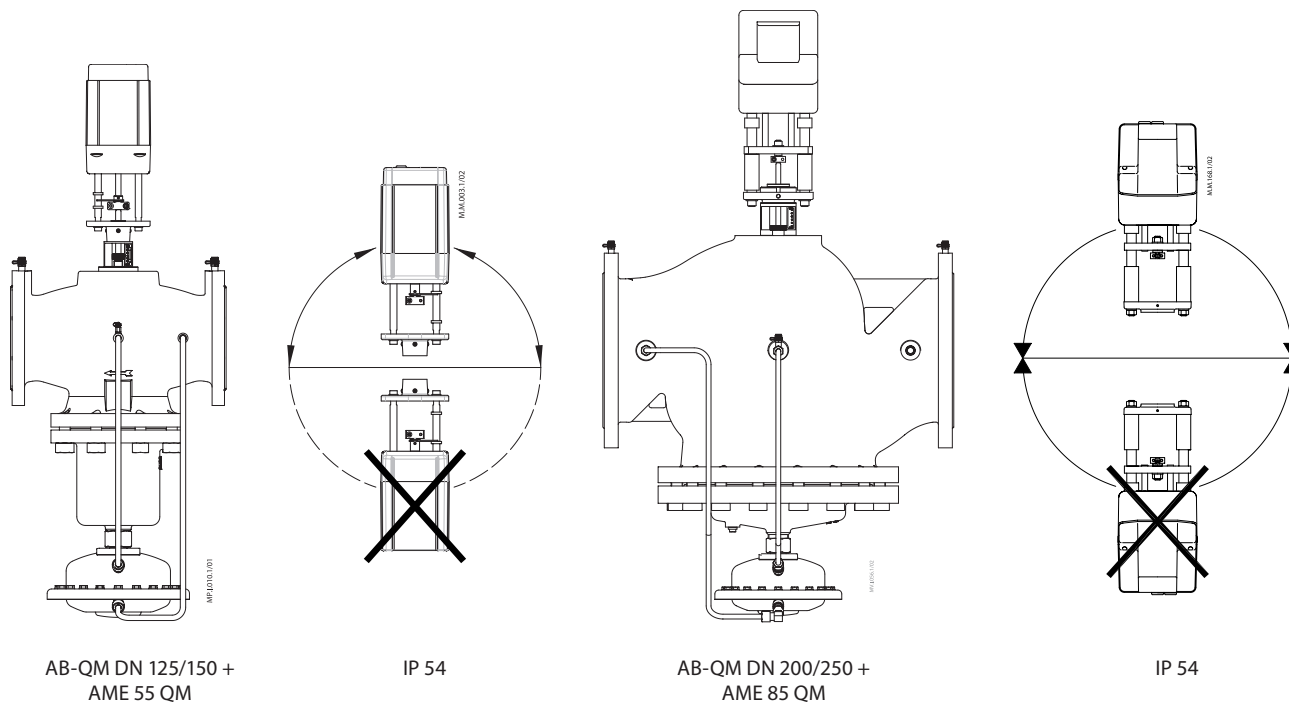

Temp. -10 ... 120 °C

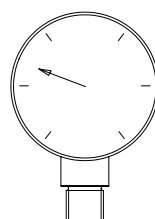

PN 16

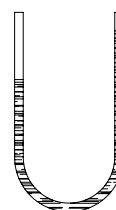

$\Delta p_{max.} = 600 \text{ kPa}^*$

* In case AB-QM is used above 400 kPa differential pressure contact Danfoss design center to assure proper design.

AB-QM DN 125-250

Setting

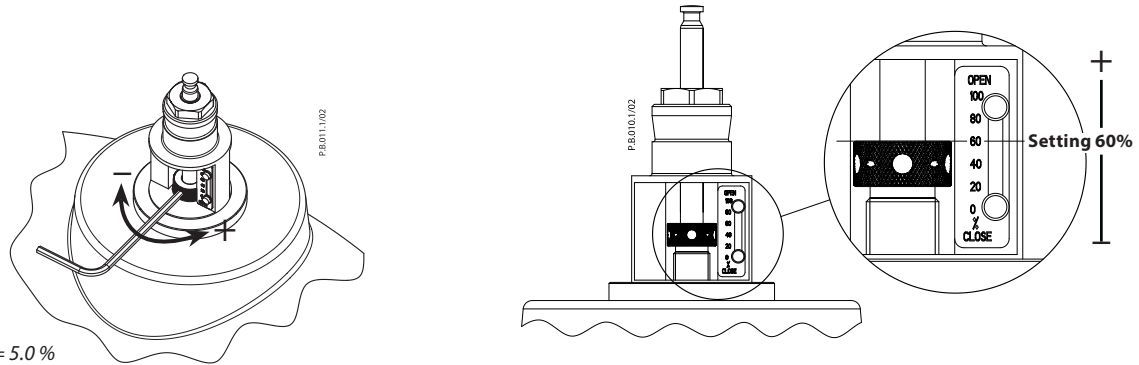

Note:
1 turn = 5.0 %

Measuring

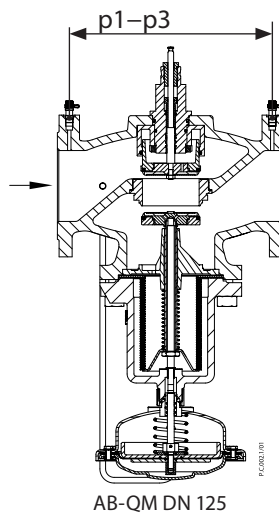
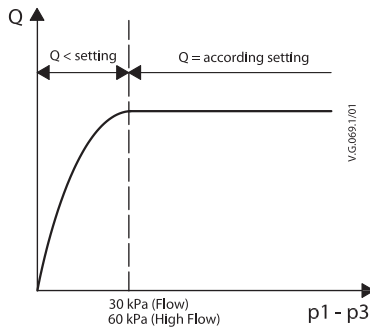

DN 125	Flow			High Flow		
	L/h	L/s	GPM	L/h	L/s	GPM
40%	36.000	10,00	158	44.000	12,22	194
45%	40.500	11,25	178	49.500	13,75	218
50%	45.000	12,50	188	55.000	15,28	242
55%	49.500	13,75	218	60.500	16,81	266
60%	54.000	15,00	238	66.000	18,33	290
65%	58.500	16,25	257	71.500	19,86	315
70%	63.000	17,50	277	77.000	21,39	339
75%	67.500	18,75	297	82.500	22,92	363
80%	72.000	20,00	317	88.000	24,44	387
85%	76.500	21,25	337	93.500	25,97	411
90%	81.000	22,50	356	99.000	27,50	436
95%	85.500	23,75	376	104.500	29,03	460
100%	90.000	25,00	396	110.000	30,56	484
105%	95.000	26,39	418	115.000	31,94	506
110%	100.000	27,78	440	120.000	33,33	528

Note: 1 turn = 5,0%

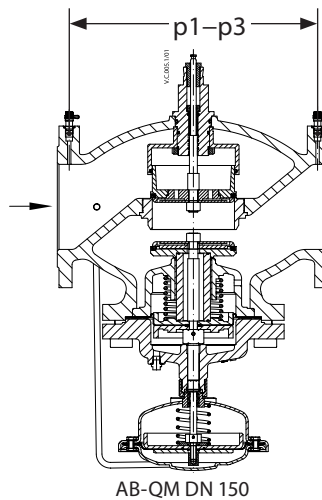

DN 150	Flow			High Flow		
	L/h	L/s	GPM	L/h	L/s	GPM
40%	58.000	16,11	255	76.000	21,11	334
45%	65.250	18,13	287	85.500	23,75	376
50%	72.500	20,14	319	95.000	26,39	418
55%	79.750	22,15	351	104.500	29,03	460
60%	87.000	24,17	383	114.000	31,67	502
65%	94.250	26,18	415	123.500	34,31	543
70%	101.500	28,19	447	133.000	36,94	585
75%	108.750	30,21	479	142.500	39,58	627
80%	116.000	32,22	510	152.000	42,22	669
85%	123.250	34,24	542	161.500	44,86	711
90%	130.500	36,25	574	171.000	47,50	752
95%	137.750	38,26	606	180.500	50,14	794
100%	145.000	40,28	638	190.000	52,78	836
105%	152.500	42,36	671	209.500	58,19	922
110%	160.000	44,44	704	229.000	63,61	1.008

Note: 1 turn = 5,0%

AB-QM DN 125-250

Measuring

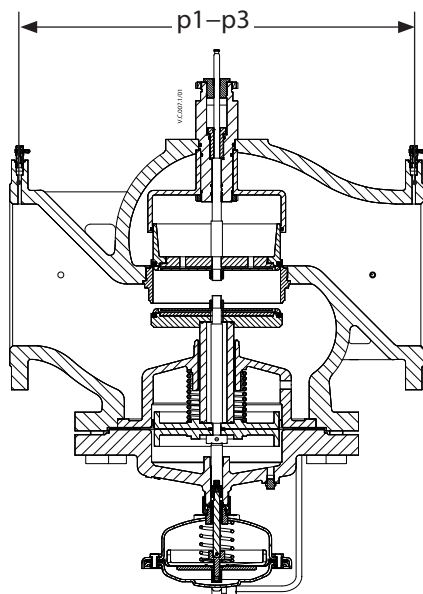
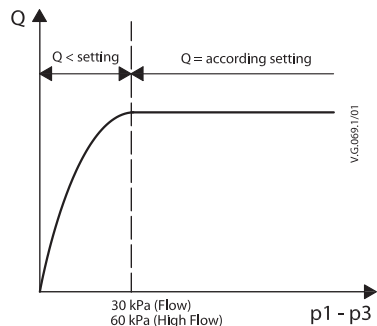

AB-QM DN 200/250

DN200	Flow			High Flow		
	L/h	L/s	GPM	L/h	L/s	GPM
40%	80.000	22,22	352	108.000	30,00	475
45%	90.000	25,00	396	121.500	33,75	535
50%	100.000	27,78	440	135.000	37,50	594
55%	110.000	30,56	484	148.500	41,25	653
60%	120.000	33,33	528	162.000	45,00	713
65%	130.000	36,11	572	175.500	48,75	772
70%	140.000	38,89	616	189.000	52,50	832
75%	150.000	41,67	660	202.500	56,25	891
80%	160.000	44,44	704	216.000	60,00	950
85%	170.000	47,22	748	229.500	63,75	1010
90%	180.000	50,00	792	243.000	67,50	1069
95%	190.000	52,78	836	256.500	71,25	1129
100%	200.000	55,56	880	270.000	75,00	1188
105%	210.000	58,33	924	285.000	79,17	1254
110%	220.000	61,11	968	300.000	83,33	1320

Note: 1 turn = 5,0%

DN250	Flow			High Flow		
	L/h	L/s	GPM	L/h	L/s	GPM
40%	120.000	33,33	528	148.000	41,11	651
45%	135.000	37,50	594	166.500	46,25	733
50%	150.000	41,67	660	185.000	51,39	814
55%	165.000	45,83	726	203.500	56,53	895
60%	180.000	50,00	792	222.000	61,67	977
65%	195.000	54,17	858	240.500	66,81	1058
70%	210.000	58,33	924	259.000	71,94	1140
75%	225.000	62,50	990	277.500	77,08	1221
80%	240.000	66,67	1056	296.000	82,22	1302
85%	255.000	70,83	1122	314.500	87,36	1384
90%	270.000	75,00	1188	333.000	92,50	1465
95%	285.000	79,17	1254	351.500	97,64	1547
100%	300.000	83,33	1320	370.000	102,78	1628
105%	315.000	87,50	1386	388.500	107,92	1709
110%	330.000	91,67	1452	407.000	113,06	1791

Note: 1 turn = 5,0%

ІМПОРТЕР:

UA: ТОВ з ІІ «Данфосс ТОВ», вул. Вікентія Хвойки, 15/15/6, м. Київ, 04080, Україна

Danfoss A/S

Climate Solutions • danfoss.com • +45 7488 2222

Any information, including, but not limited to information on selection of product, its application or use, product design, weight, dimensions, capacity or any other technical data in product manuals, catalogues descriptions, advertisements, etc. and whether made available in writing, orally, electronically, online or via download, shall be considered informative, and is only binding if and to the extent, explicit reference is made in a quotation or order confirmation. Danfoss cannot accept any responsibility for possible errors in catalogues, brochures, videos and other material. Danfoss reserves the right to alter its products without notice. This also applies to products ordered but not delivered provided that such alterations can be made without changes to form, fit or function of the product.

All trademarks in this material are property of Danfoss A/S or Danfoss group companies. Danfoss and the Danfoss logo are trademarks of Danfoss A/S. All rights reserved.