

BROGRUND

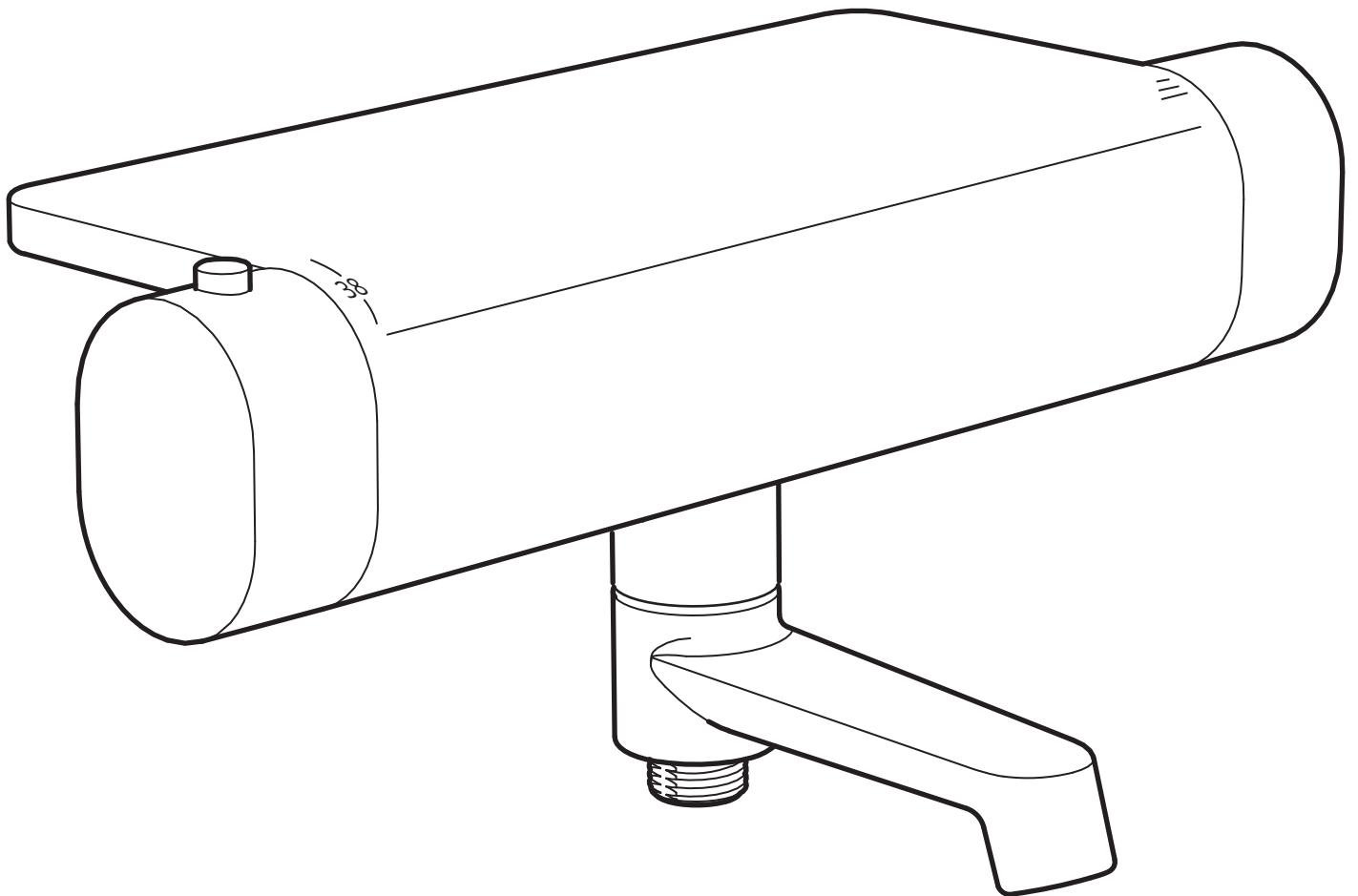

Design and Quality
IKEA of Sweden

Svenska**Innehåll:**

Verktyg	4
Montering av produkt	7
Illustration av produkt, delar och artikelnummer.	16

English**Contents:**

Tools	4
Product assembly	7
Illustration of product, parts and part numbers	16



Svenska

Stäng av huvudkranen innan du byter blandare.

English

Switch off main shut-off valve before changing mixer tap.



Svenska

Installationen ska utföras i enlighet med branschreglerna Säker Vatteninstallation.

English

Installation shall be carried out in accordance with Industry Regulations Säker Vatteninstallation.



Accepterad
monteringsanvisning
2026:1



TG 1382



1913

EN 1111 | EN 1717

Svenska

RSK Nr: 8350395

English

RSK No: 8350395



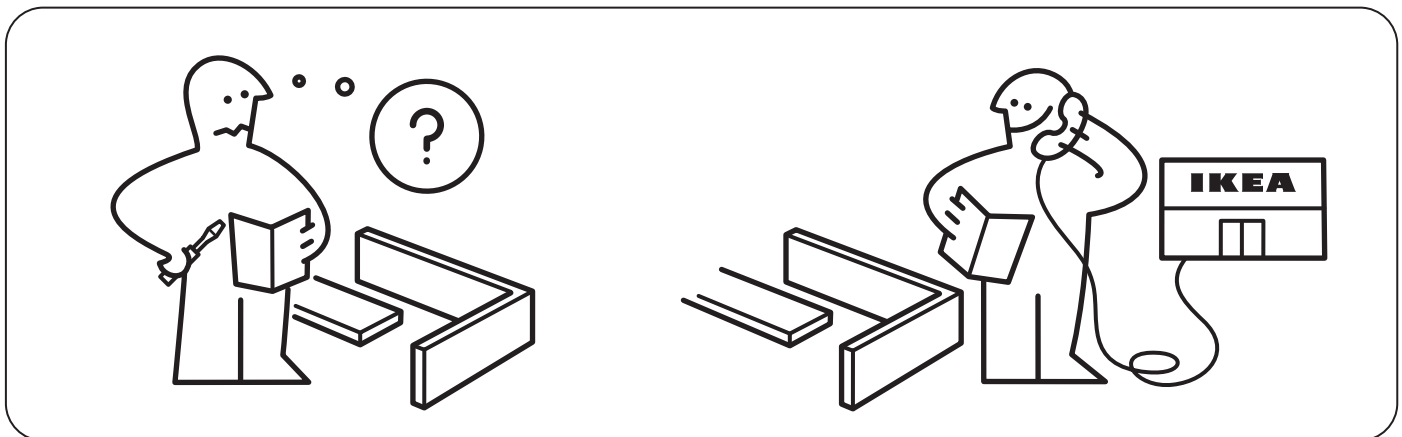
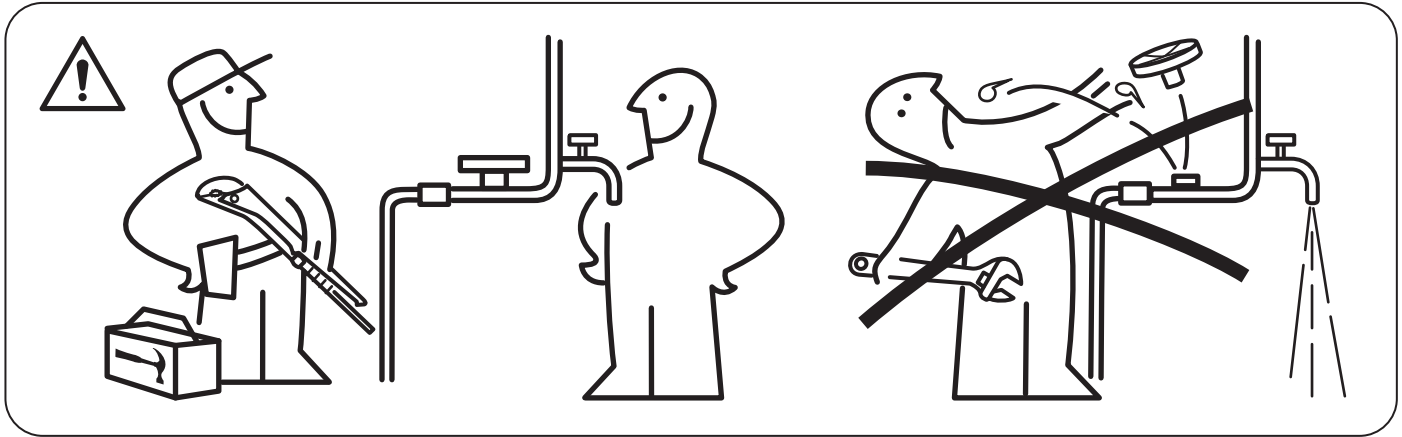
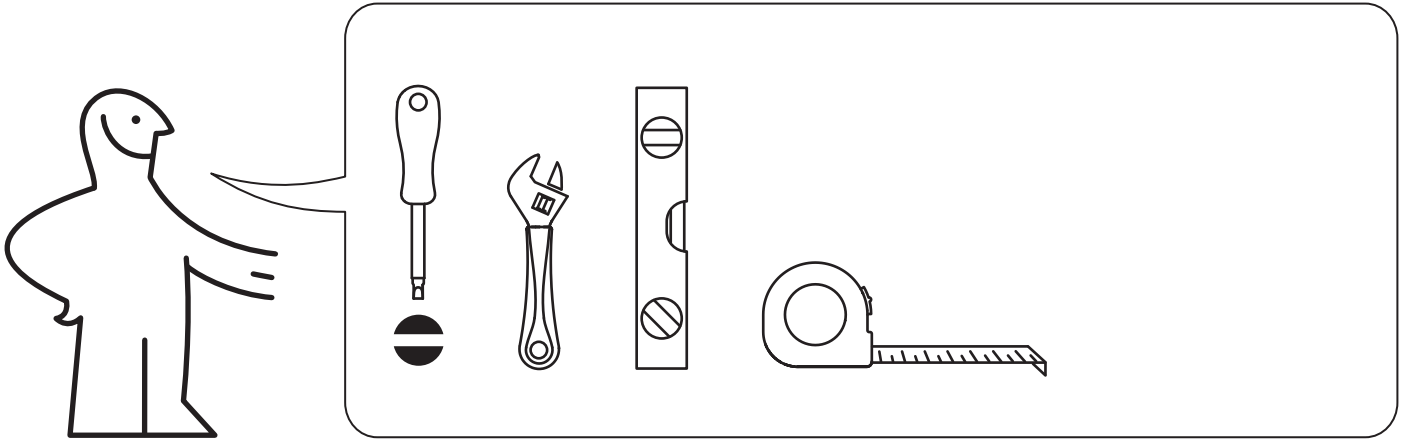

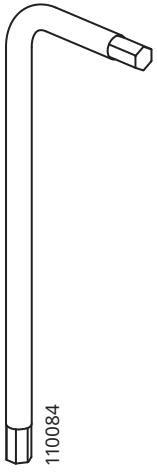

1x

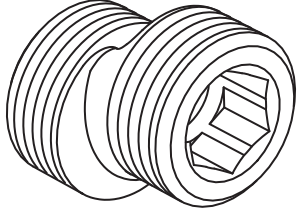

2x

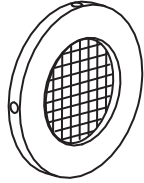

2x

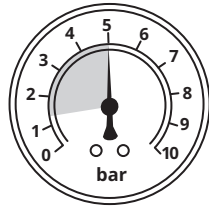

Svenska

Rekommenderad
varmvattentemperatur: 60°C
Max. varmvattentemperatur:
80°C

English

Recommended hot water
temperature: 60°C
Max. hot water temperature:
80°C

Svenska

Rekommenderat arbetstryck:
1,4 - 5 bar
Max. statiskt tryck: 10 bar
Max. provningstryck: 16 bar

English

Recommended working
pressure: 1,4 - 5 bar
Max. static pressure: 10 bar
Max. test pressure: 16 bar

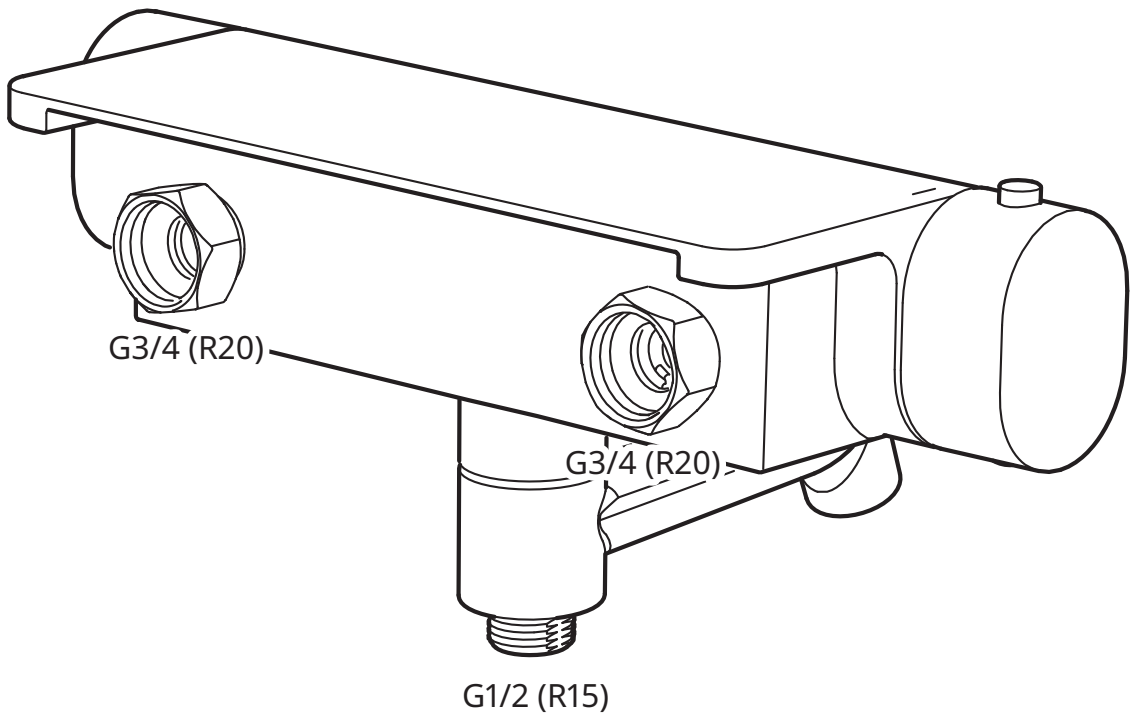

M26

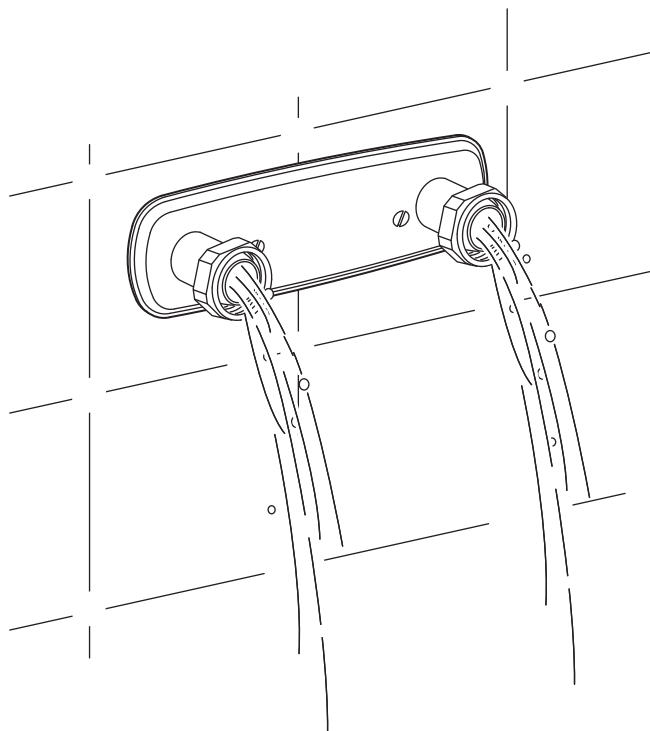

G3/4 (R20)

**Svenska**

Innan du ansluter produkten till vattenförsörjningssystemet bör man spola vatten genom systemet för att avlägsna skräp.

English

Before connecting the product to the water supply system, water should be flushed through the system to remove all debris.

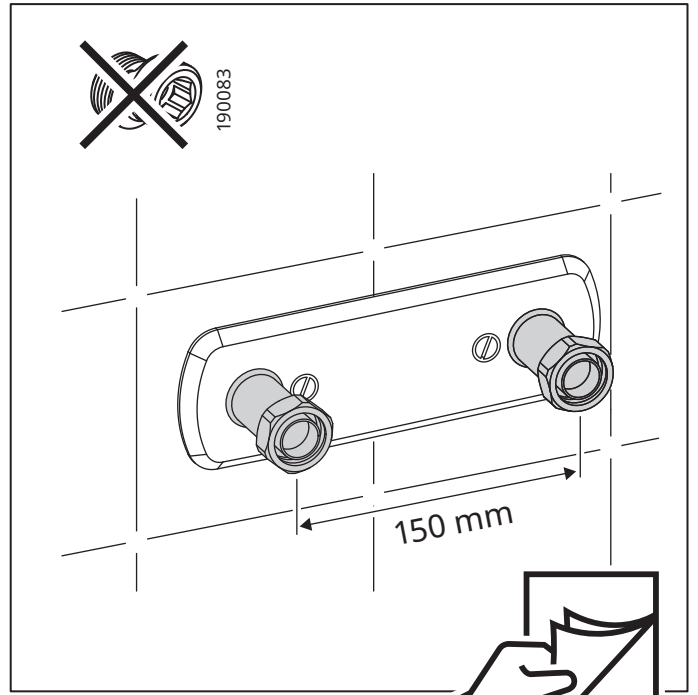
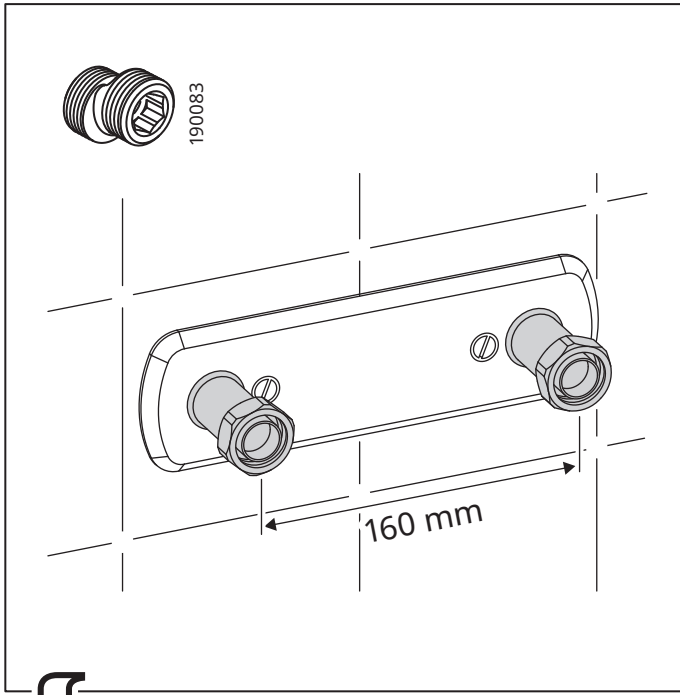

1

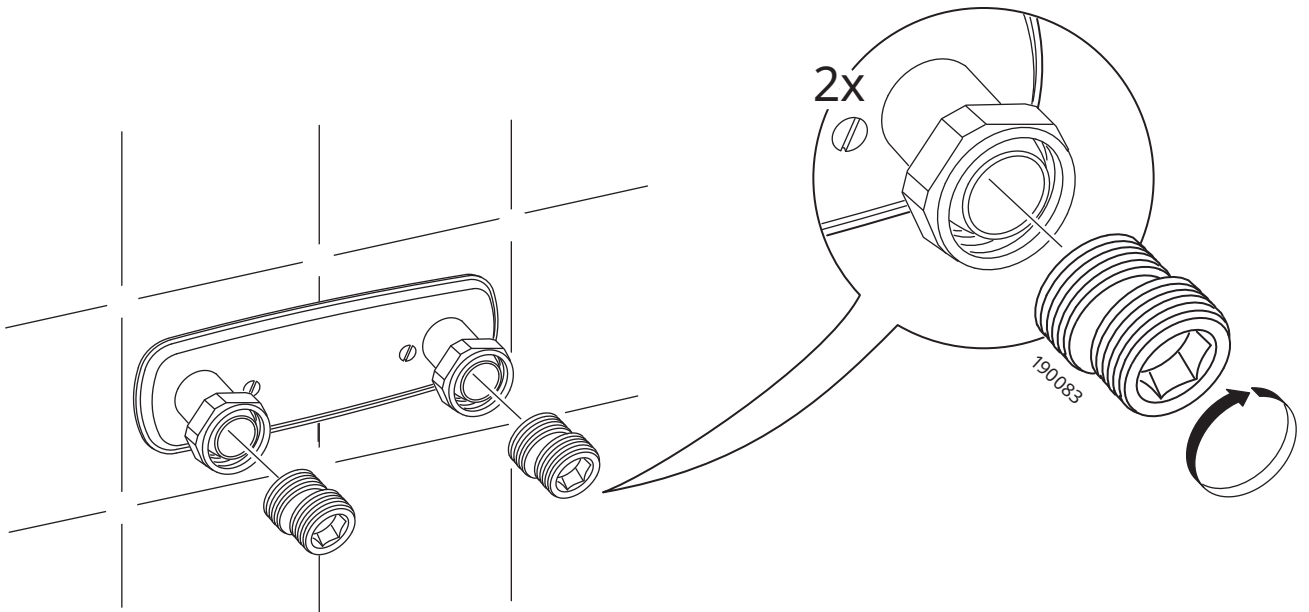

2

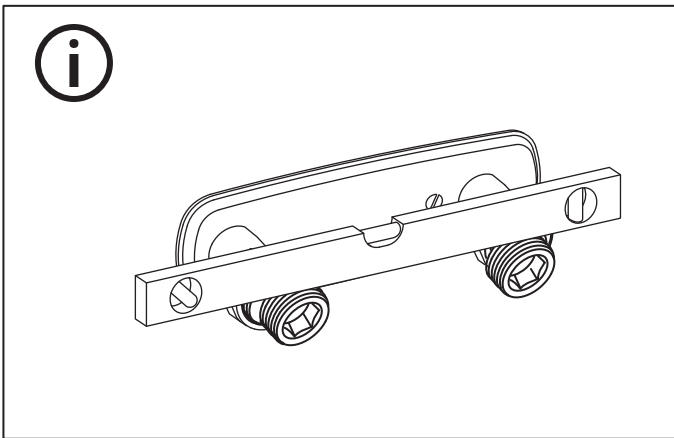
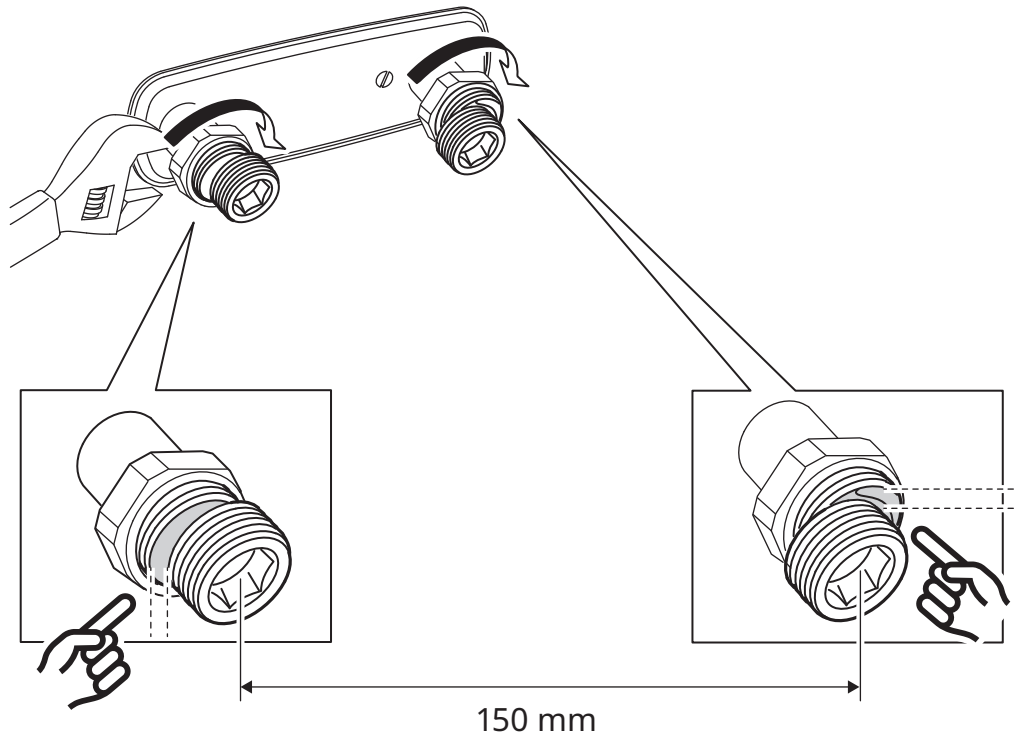

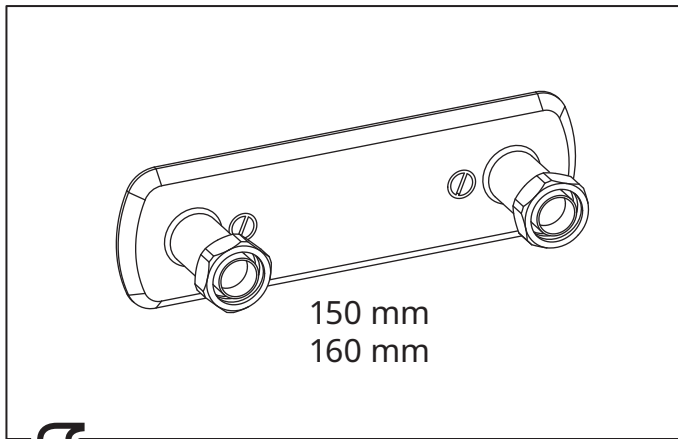

3

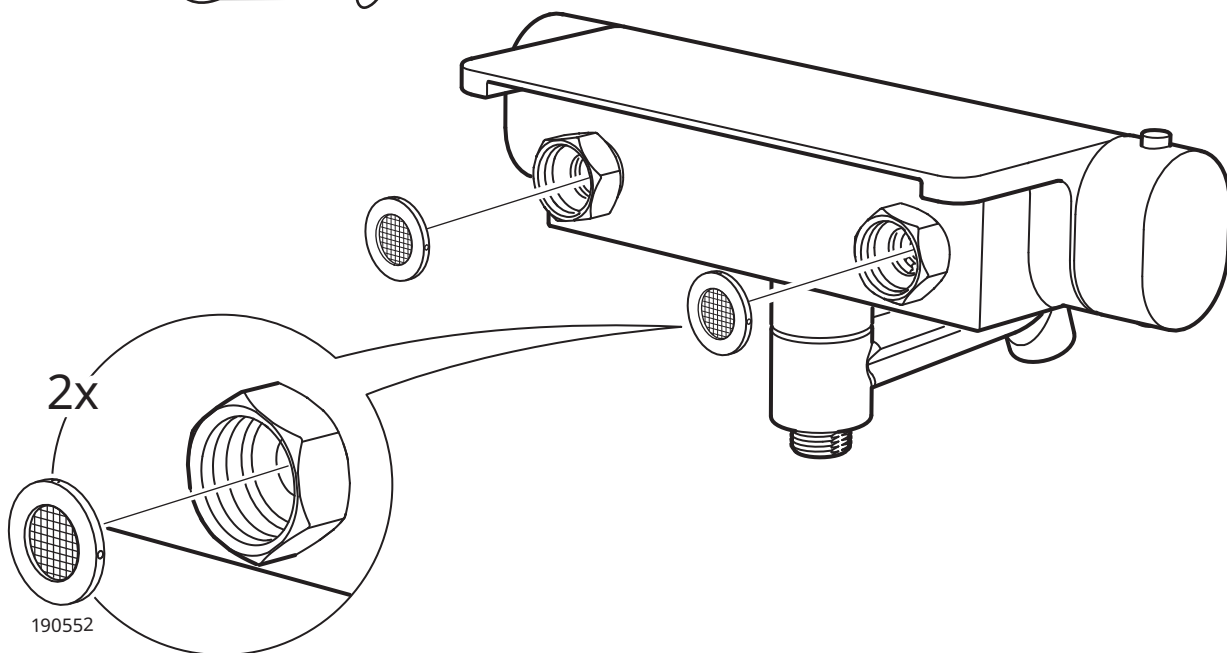

4

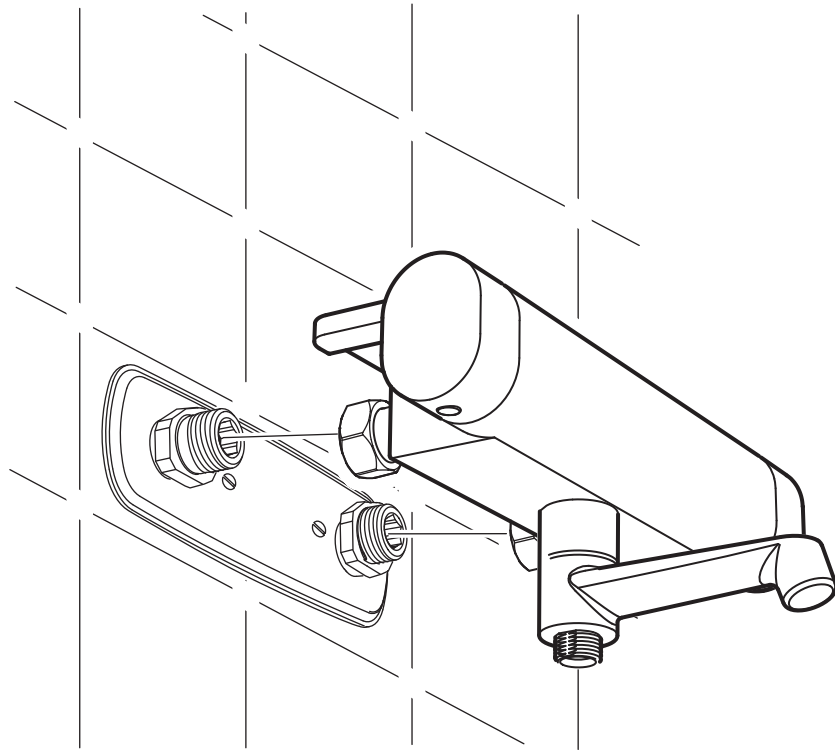

5

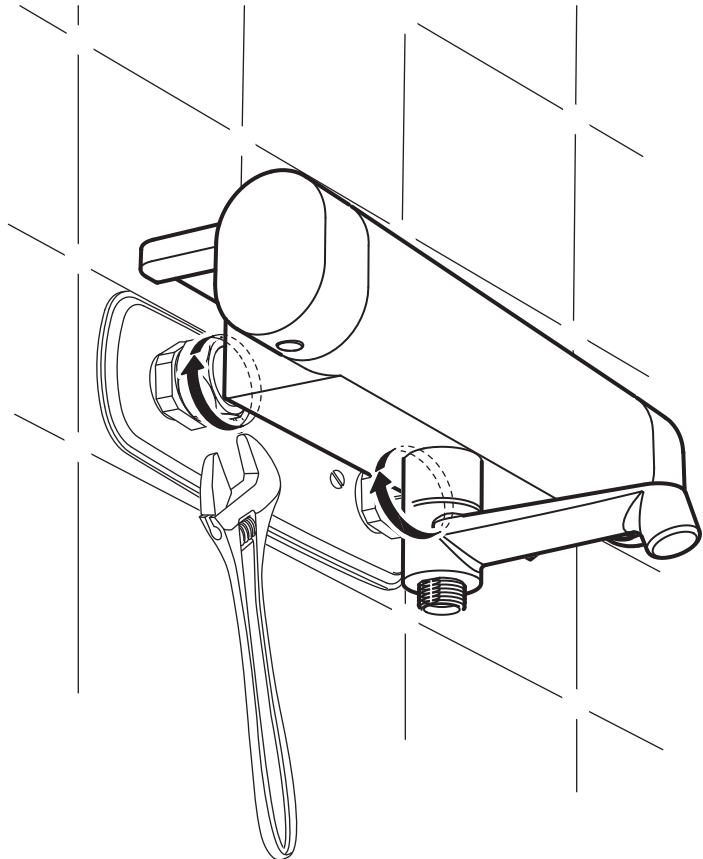

Svenska

OBS! Dra aldrig åt för hårt; slangar och packningar kan skadas.

English

IMPORTANT! Do not tighten too hard: this can damage hoses/pipes and washers.

6

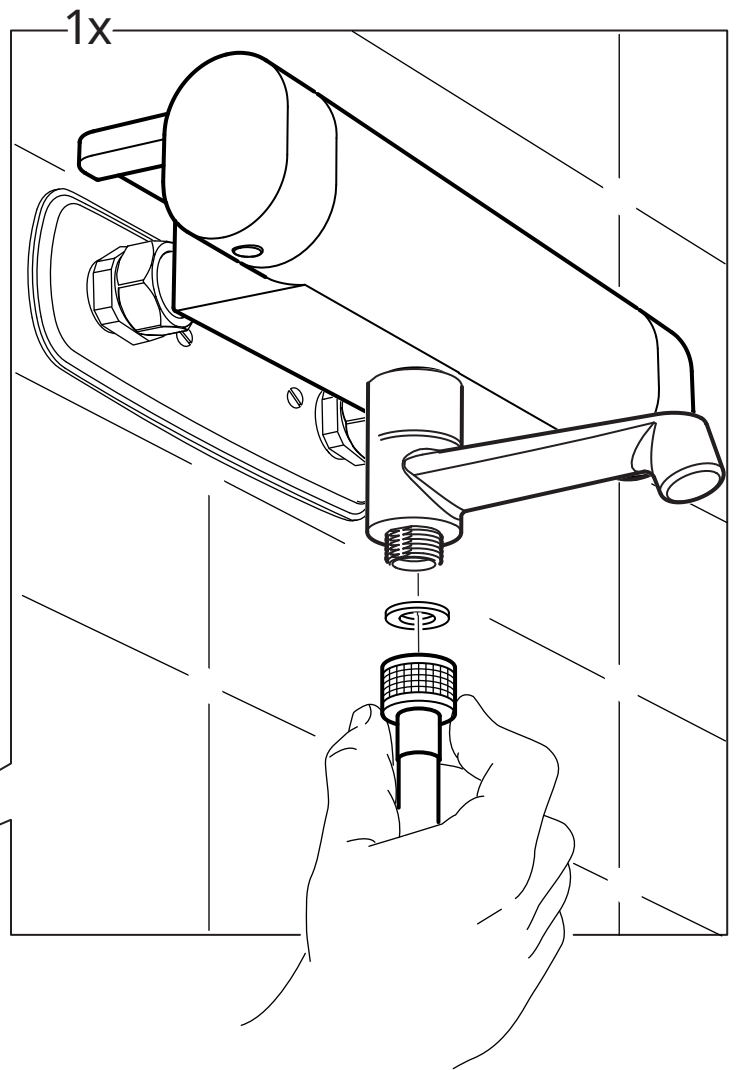
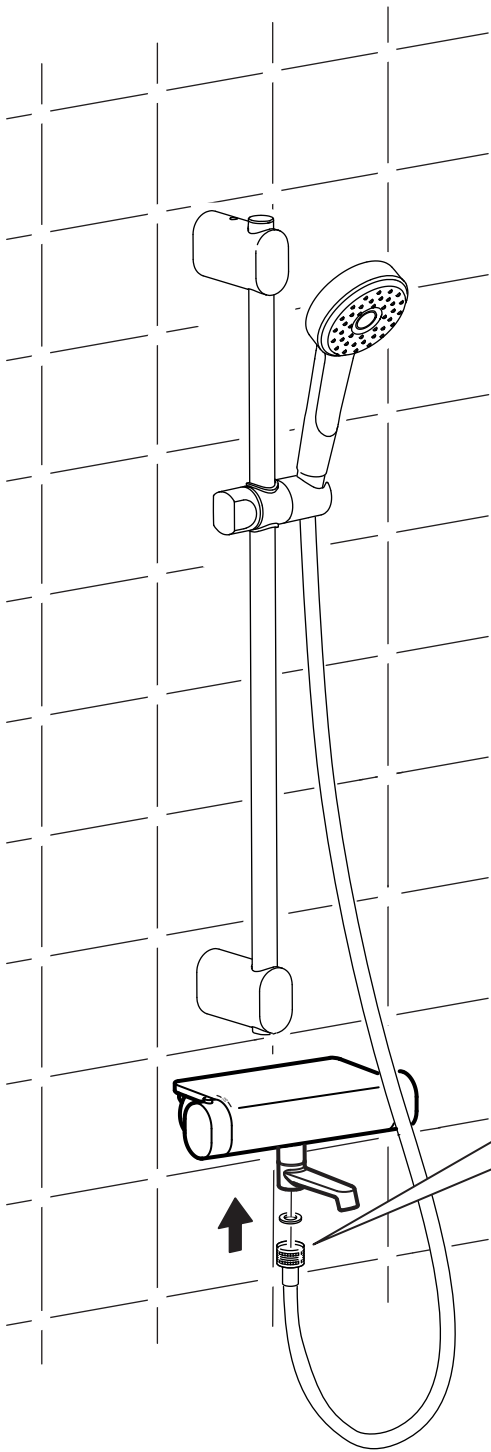

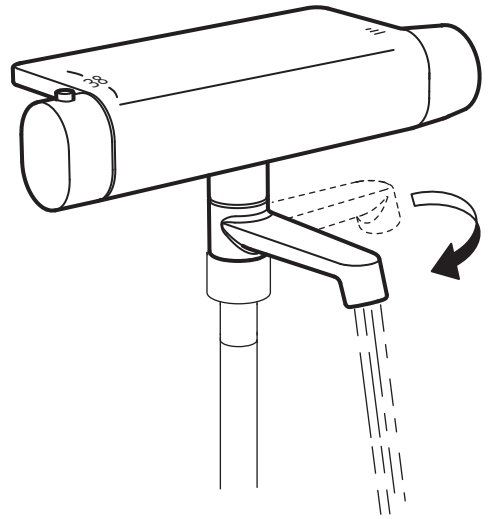
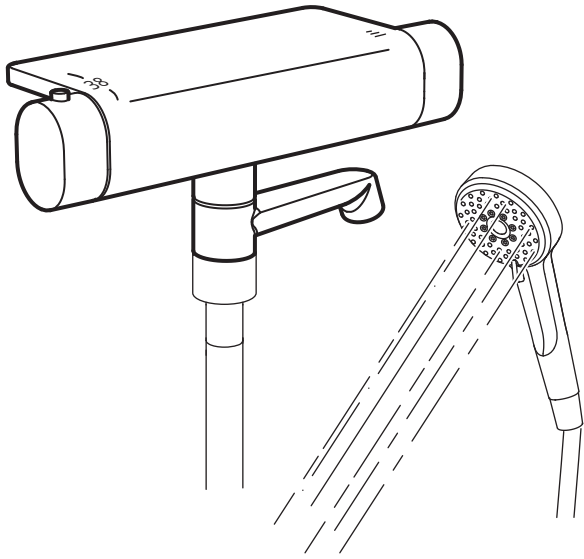

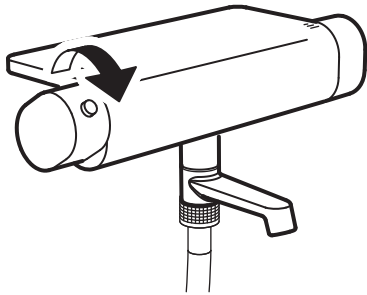

Svenska
Kallt.

English
Cold.

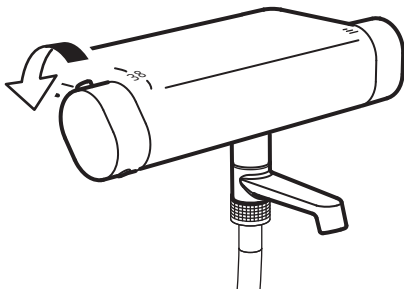

Svenska
Varmt.

English
Hot.

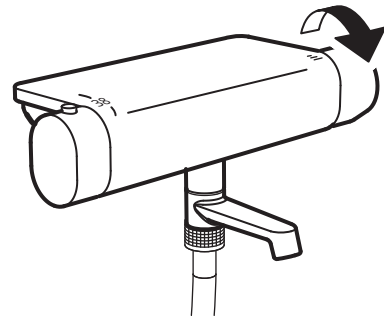
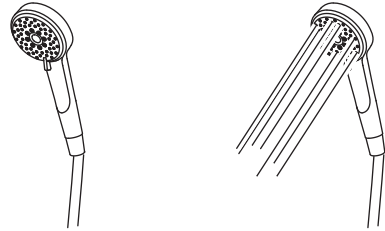

Max. 48C°

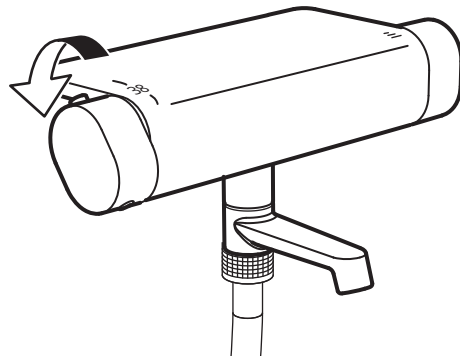
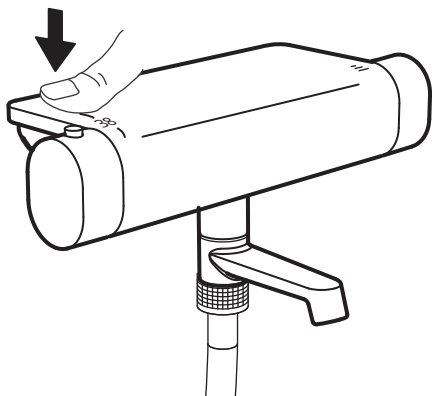

Svenska

Beroende på den individuella försörjningen kan det vara nödvändigt att justera mixern att leverera korrekt och säker vattentemperatur.

English

Depending on your individual supply system it might be necessary to adjust the mixer to supply the correct and safe water temperature.

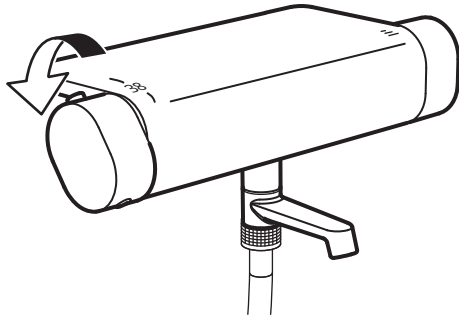

Max 48C°

1

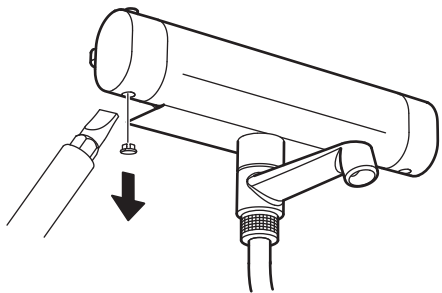

2

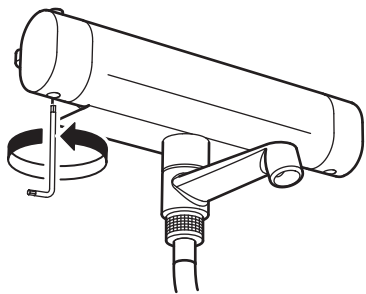

3

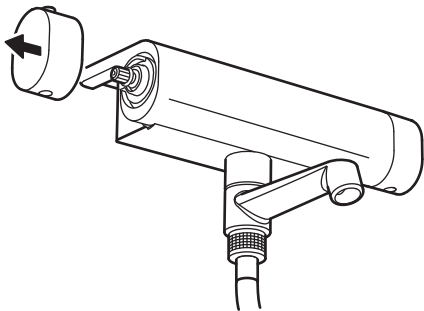

4

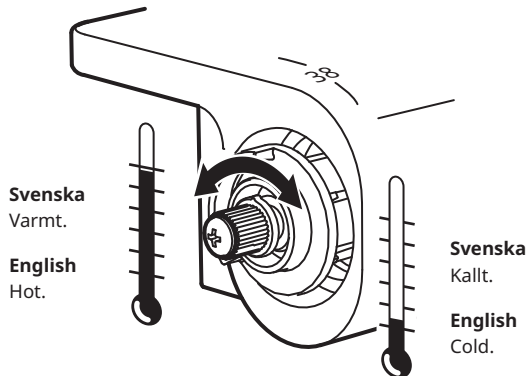

5

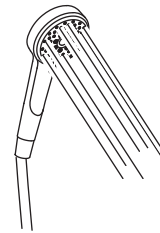

37 - 39° C

6

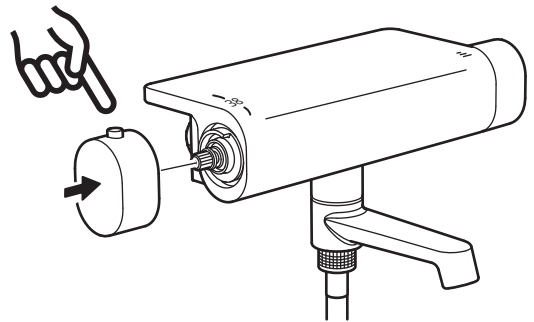

7

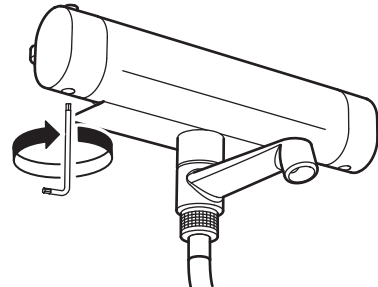

8

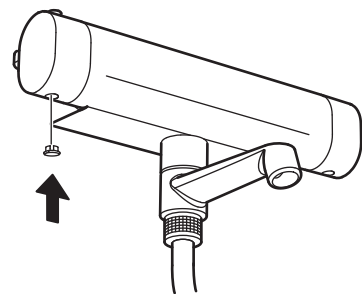



Svenska

Kontrollera regelbundet att installationen är tät.

English

Check at regular intervals to make sure that the installation is not leaking.

