

# Alterna

## Leone Badkar

Monteringsanvisning

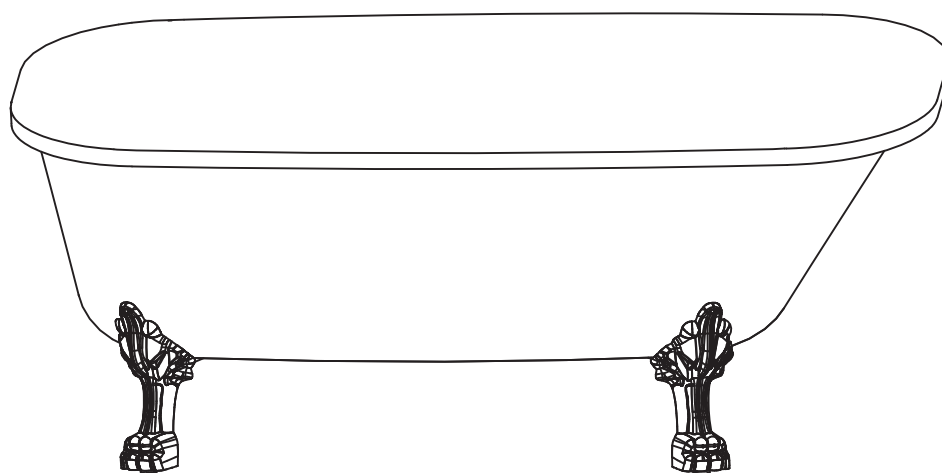

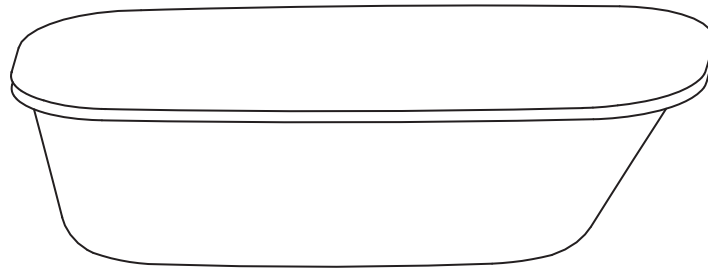

Ovansida

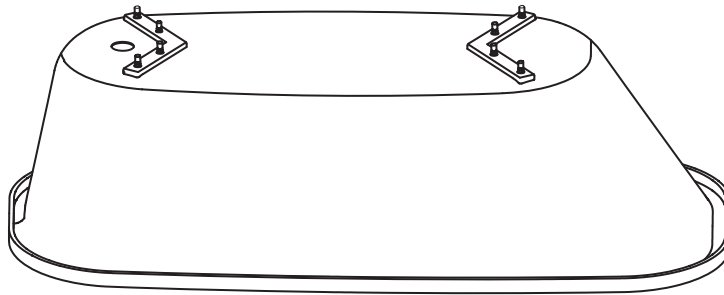

Undersida

## Verktyg för montage



(a)

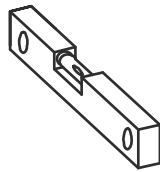

(b)

---

## Innehåll i förpackning:

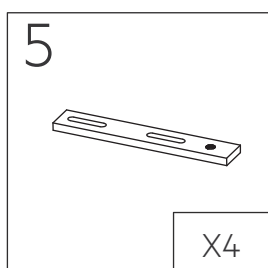
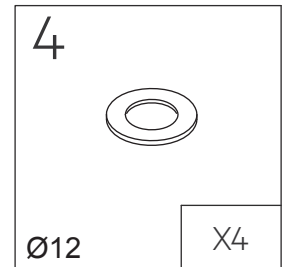
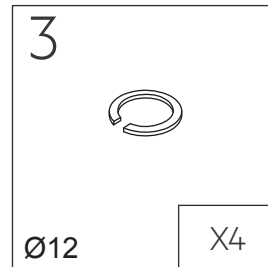
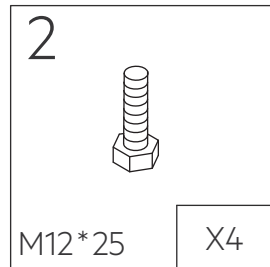
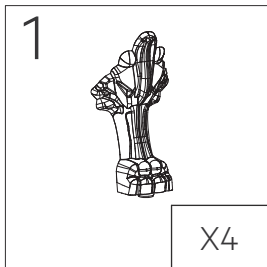

1

Ta bort skyddet på badkaret.

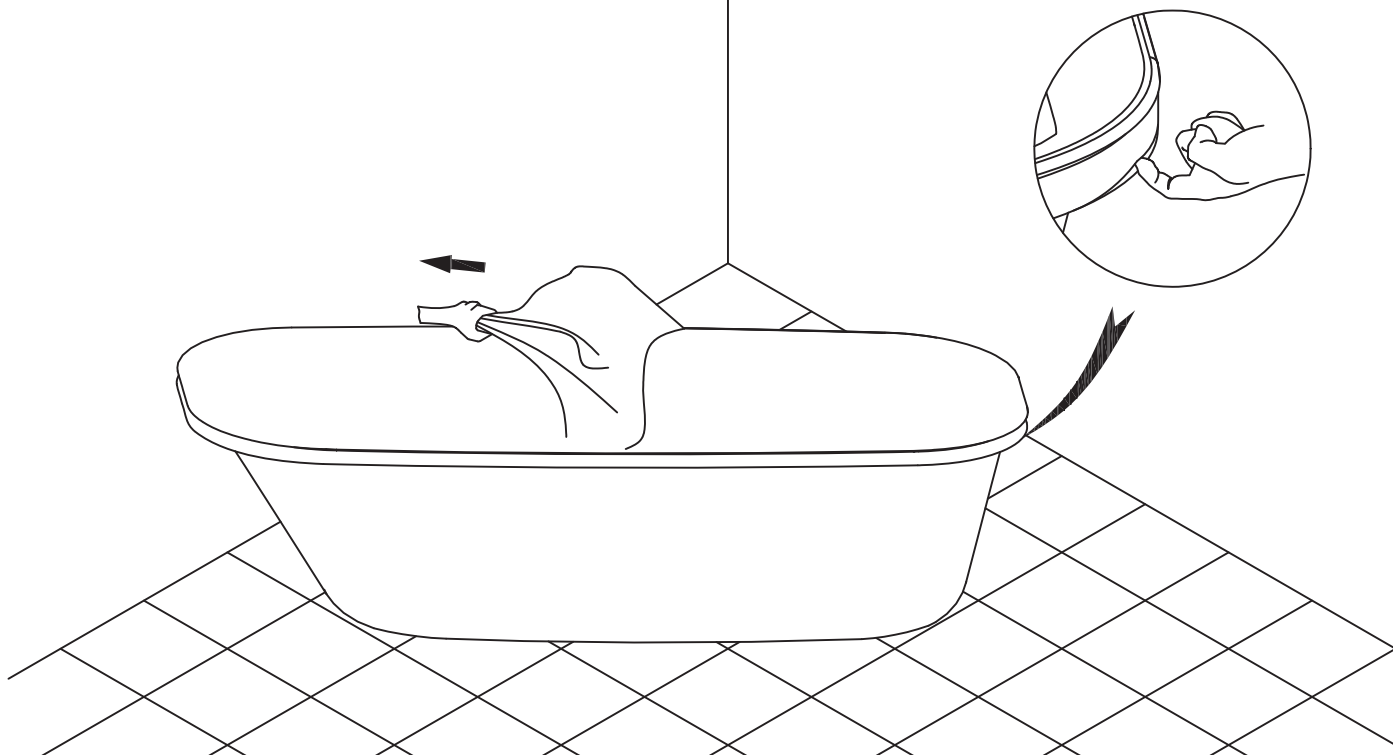

2

Vänd badkaret upp och ner och lägg det på ett mjukt och rent underlag.

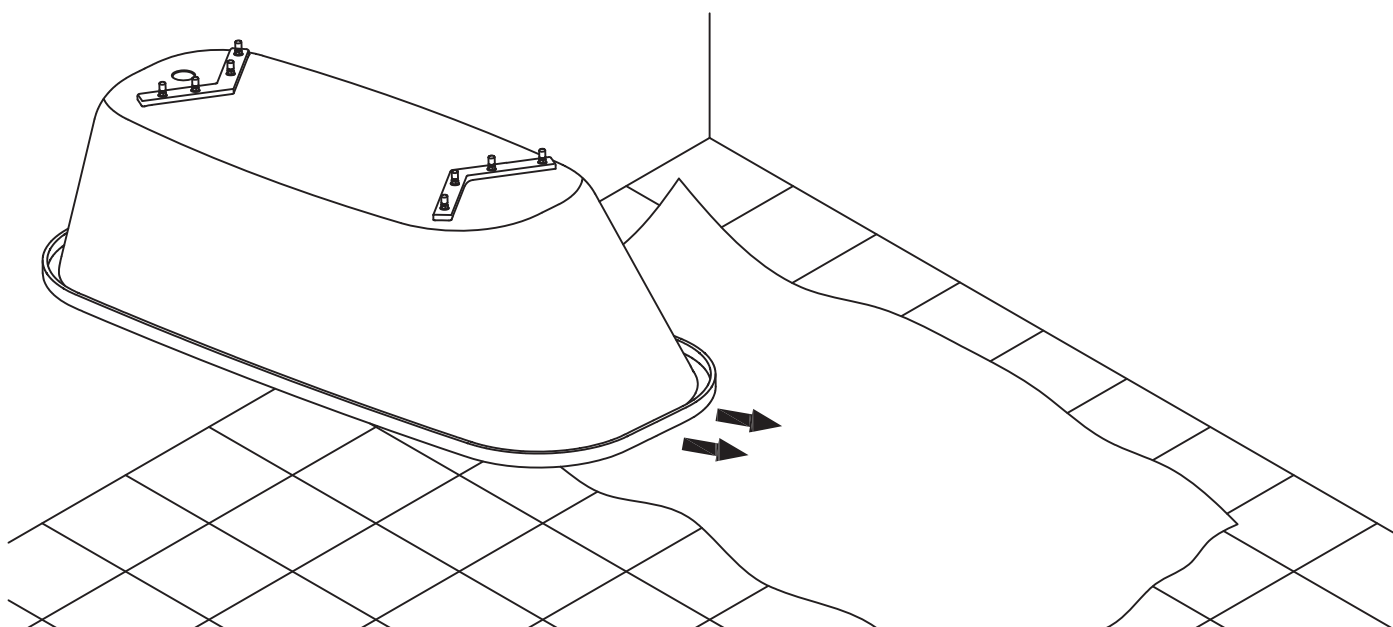

3

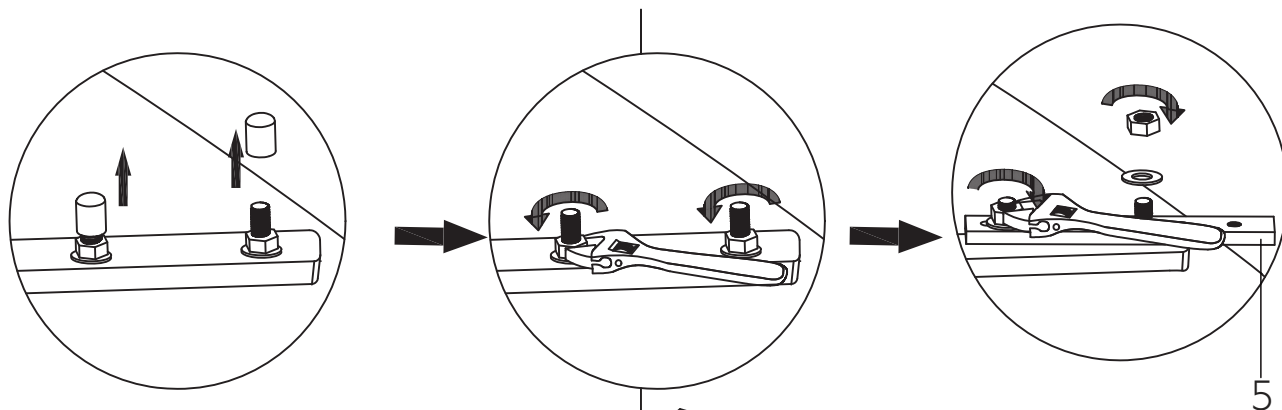

**Avlägsna gummihöljet och installera justeringsjärnet**

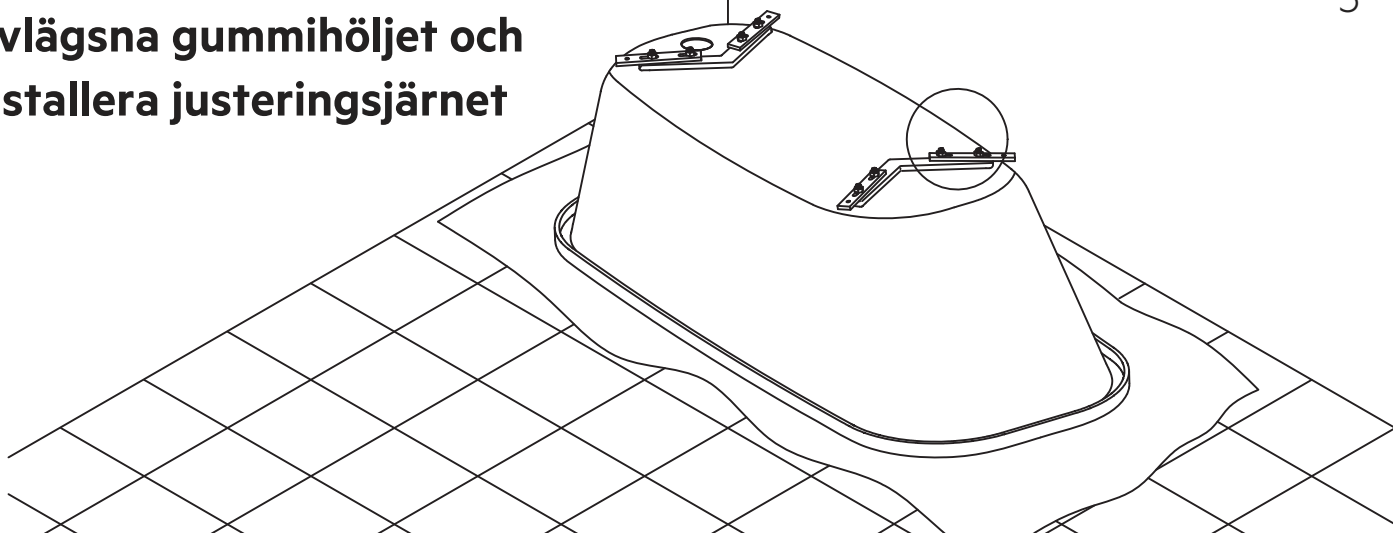

4

**Montera badkarsfötterna på justeringsjärnen.  
Fixera sedan i lämpligt läge.**

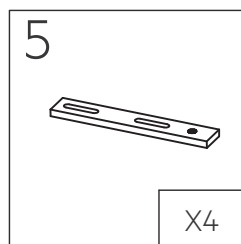
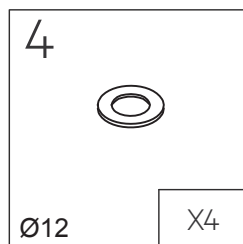
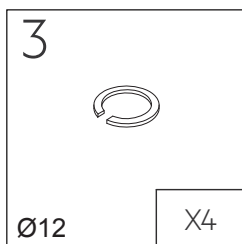
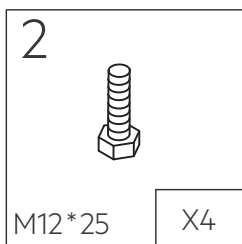
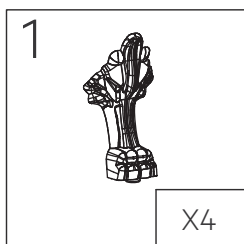
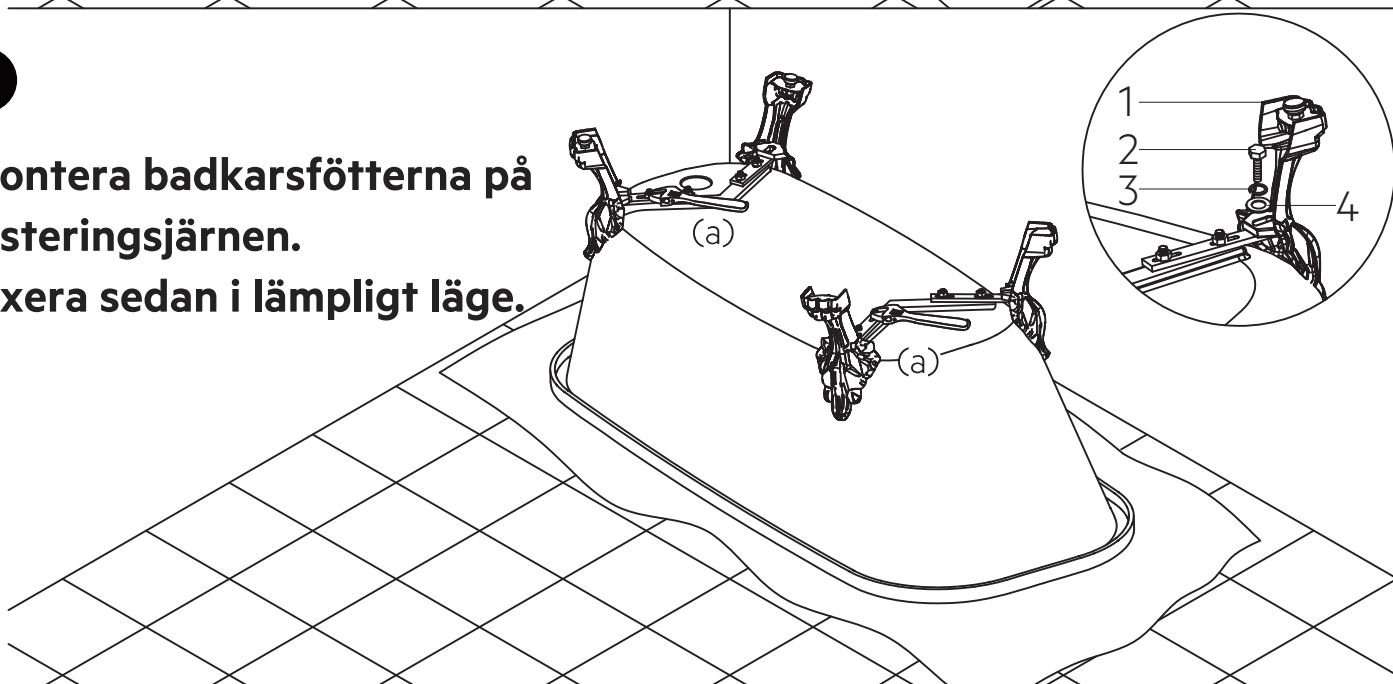

Väg av badkaret med  
justeringsskruvarna i fötterna.

