

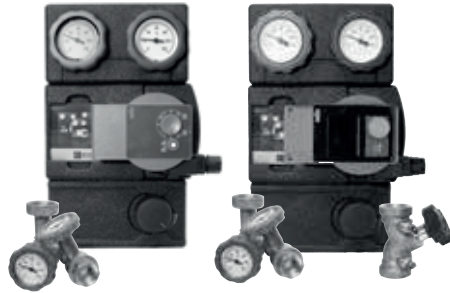

ESBE AB  
Bruksgatan 22  
SE-333 75 Reftele  
www.esbe.eu

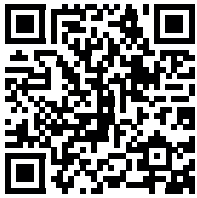

ESBE System Units  
**CIRCULATION UNIT DN20,  
GRB300**



Series GRB301  
Series GRB361



PED 2014/68/EU, article 4.3  
EnEV 2014

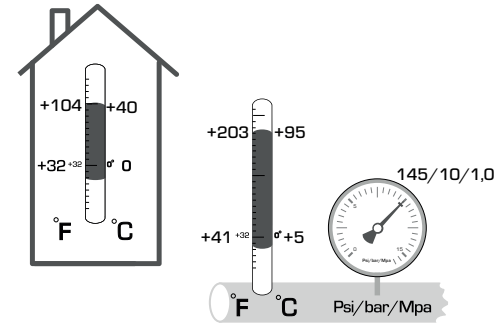

SERIES	FUNCTION
ESBE GRB301	<p>Optional actuator/ controller. Not included.</p>
ESBE GRB361	<p>Optional actuator/ controller. Not included.</p>

Mtrl.no. 98141128 • Dwg. 7958 • vers. C • Rev. 2026-01-09



**Mounting position**

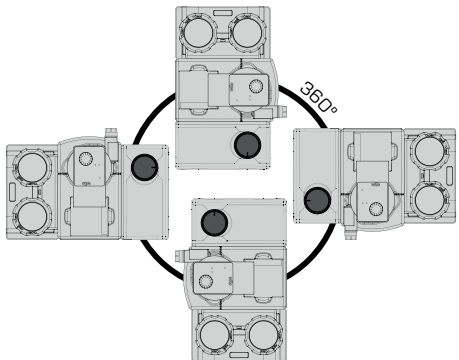
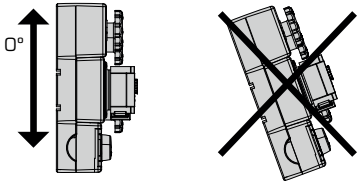

**Cabling • Dimensions**

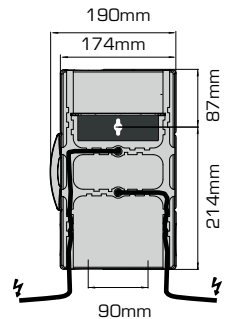

**1 Remove knob**

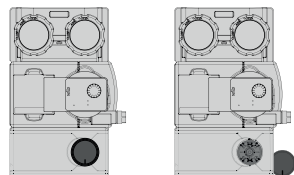

**2 Disassembly insulation**

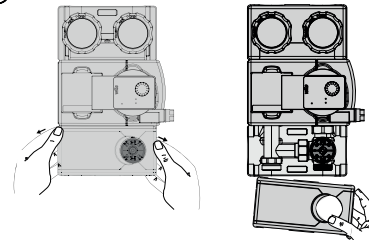

**Pull up insulation 7mm and remove**

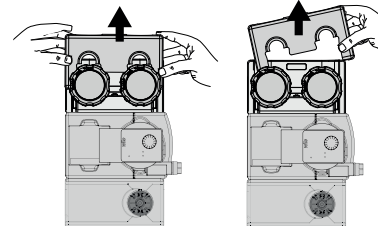

**3 Assembling on wall**

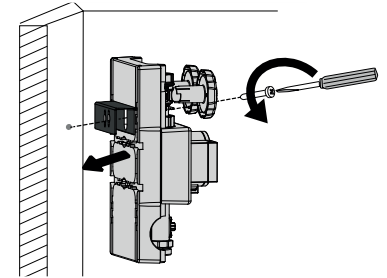

**Adjust wallbracket**

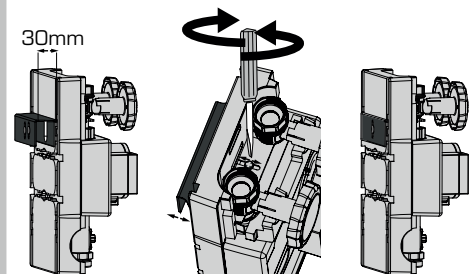

4

### Fit supply pipes

c/c 90mm

Add balancing valves

Add ballvalves

30-40Nm

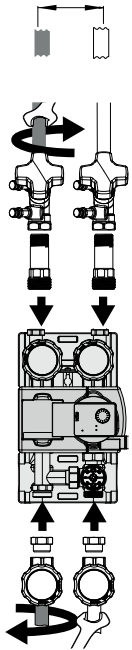

5

### Assemble insulation

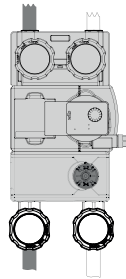
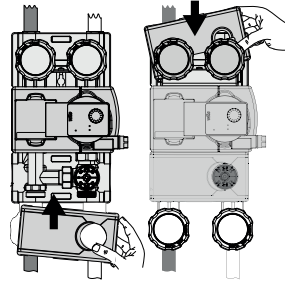

6

### Assemble actuator/controller

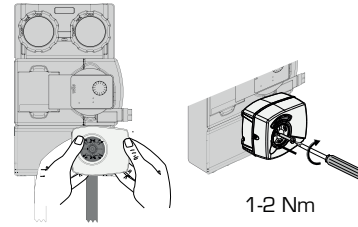

1-2 Nm

### Mounting position actuator/controller

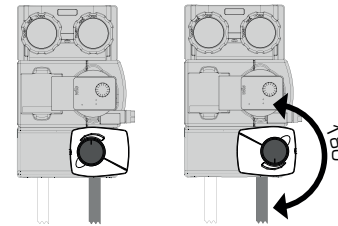

90°

i

### Commissioning

#### Preparation

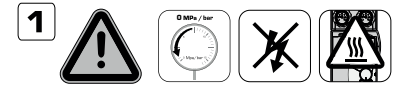

#### Assemble removed knob

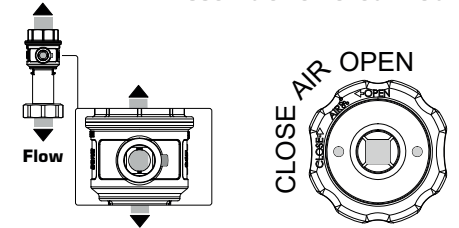

#### Open/Close Shut off valve

Open

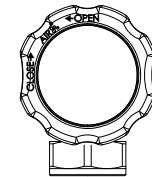

Closed 90°

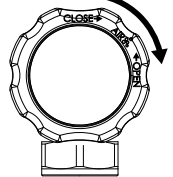

i

### Electric installation

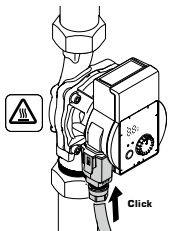
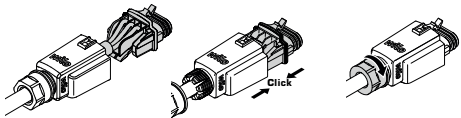
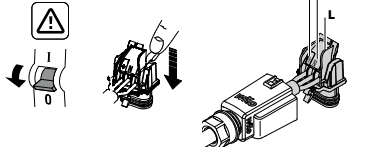

max 10 A

[www.esbe.eu](http://www.esbe.eu)

i

### Commissioning actuator/controller

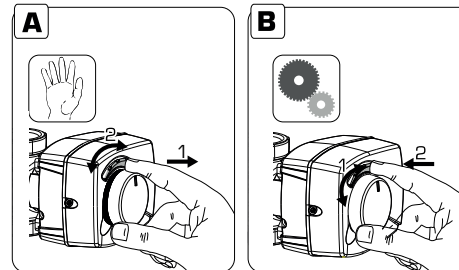
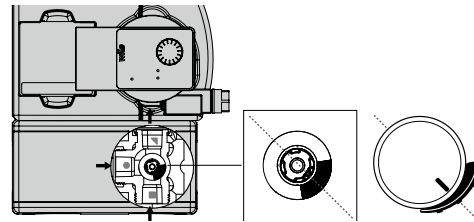

[www.esbe.eu/group/products/controllers](http://www.esbe.eu/group/products/controllers)  
[Download area]



[www.esbe.eu/group/products/rotary-actuators](http://www.esbe.eu/group/products/rotary-actuators)  
[Download area]

i

### Commissioning Balancing valve



<https://www.esbe.eu/group/products/circulation-units/grb300>  
[Download area]



## Pump GRB301 Display

**Fault signal LED**

**LED display**

• Display of the setpoint H of the delivery head (differential pressure) in m.

• Display of selected constant speed (c1 = I, c2 = II, c3 = III).

• Display of the current power consumption in W, alternating with the current flow rate in m<sup>3</sup>/h.

• Display of warning and fault signals.

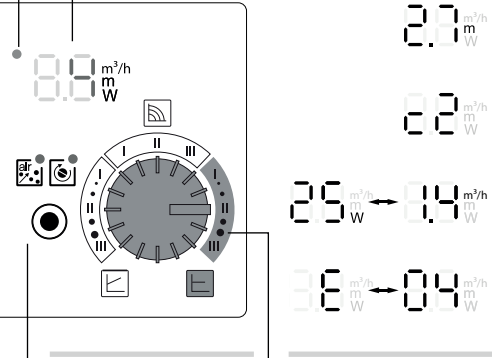

**Function key/Press**

- Start pump venting function.
- Activate pump manual restart.

**Operating button/Turn**

- Select application/control mode.
- Set setpoint H of the delivery head (differential pressure).
- Select constant rotation speed.



## Recommended pump settings

Variable differential pressure (Δp-v)

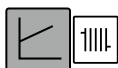

3.6 m<sup>3</sup>/h  
W

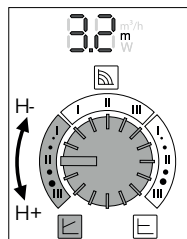

5 sec

3.6 m<sup>3</sup>/h  
W  
0.8 m<sup>3</sup>/h  
W

Constant differential pressure (Δp-c)

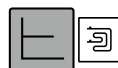

2.9 m<sup>3</sup>/h  
W

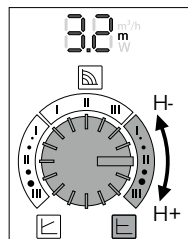

5 sec

2.9 m<sup>3</sup>/h  
W  
1.0 m<sup>3</sup>/h  
W

Constant speed I II III:



2.8 m<sup>3</sup>/h  
W

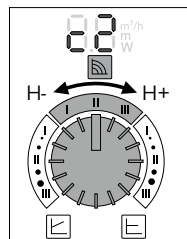

5 sec

2.8 m<sup>3</sup>/h  
W  
0.9 m<sup>3</sup>/h  
W



## Venting

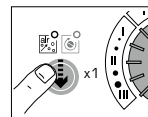
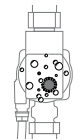

5 sec

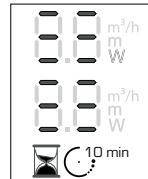

10 min

## Manual restart

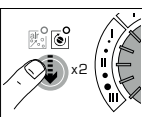
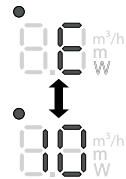

5 sec

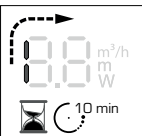

10 min



## WILO - Faults, Causes and Remedies

LED Indicator	Faults	Causes	Remedies
	Pump is not running although the power supply is switched on	Electrical fuse defective Pump has no voltage	Check fuses Resolve the power interruption
	Pump making noises	Cavitation due to insufficient suction pressure	Increase the system pressure within the permissible range Check the delivery head and set it to a lower head if necessary
	Building does not get warm	Thermal output of the heating surfaces is too low	Increase setpoint Set control mode to Δp-c
Warning signals is indicated by the <b>LED display</b> . <b>Fault signal LED</b> does not light up.			
E07	Generator operation	Water is flowing through the pump hydraulics, but pump has no mains voltage	Check mains voltage
E11	Dry run	Air in the pump	Check volumetric flow rate/ water pressure
E21	Overload	Sluggish motor; pump is operated outside of its specifications (e.g. high module temperature). The speed is lower than during normal operation.	Check the ambient conditions
Fault signals is indicated by the <b>LED display</b> . <b>Fault signal LED</b> lights up red.			
E04	Undervoltage	Power supply too low on mains side	Check mains voltage
E05	Overvoltage	Power supply too high on mains side	Check mains voltage
E10	Blocking	Rotor blocked	Activate manual restart or contact customer service
E23	Short-circuit	Motor current too high	Request customer service
E25	Contacting/ winding	Winding defective	Request customer service
E30	Excessive temperature of module	Module interior too warm	Check conditions of use
E36	Module defective	Electronics defective	Request customer service

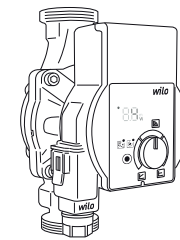

<https://www.esbe.eu/group/products/circulation-units/grb300>  
(Download area)

7

## Expose application info using leaflet

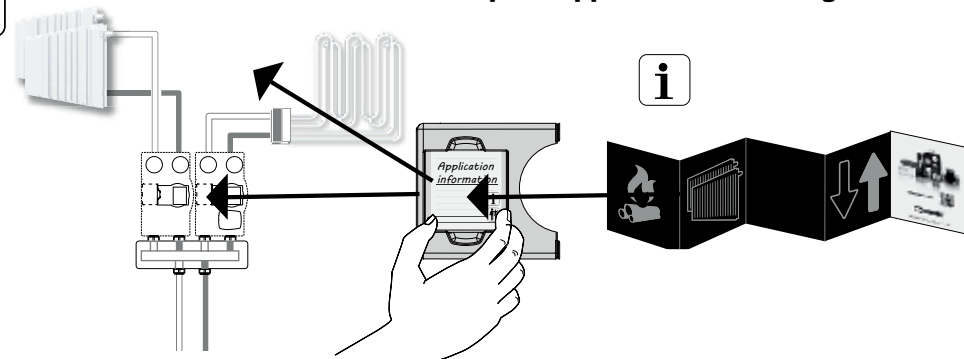



# Pump GRB361 Display

## Language

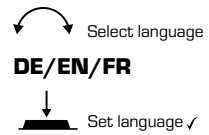

After selecting the language, the display changes to the home screen (factory setting = Dynamic Adapt plus) and the pump can be operated via the main menu.

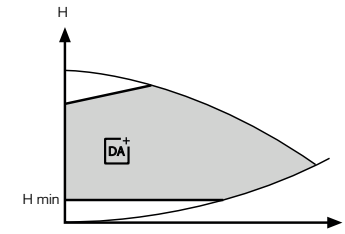
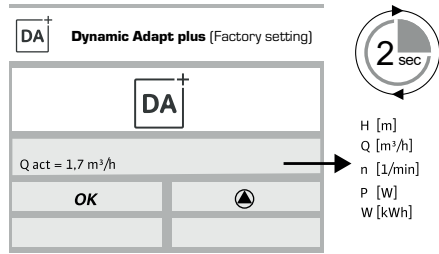

## Home screen

## Pump setting

### Setting assistant

#### No. of radiators

1...15, 20, 30

Stratos PICO ...	0,5-4m	0,5-6m	0,5-8m
Max.	15	20	30

#### Floor surface

1...220, 300m²

Stratos PICO ...	0,5-4m	0,5-6m	0,5-8m
Max.	120 m²	220 m²	300 m²

#### Manual setting

Control mode

- DA+ Dynamic Adapt plus\*
- Δp-v
- Δp-c
- Speed n-const

#### Setpoint

- Δp-v H set = 0.5 ... 4, 6, 8 m
- Δp-c H set = 0.5 ... 4, 6, 8 m
- Speed n-const Speed I, speed II, speed III

#### Night set back

ON/OFF

#### Pressure ind. valve

ON/OFF

## Device setting

Brightness 0 - 100 %

Language **German, English, French**

- m, m³/h\*
- kPa, m²/h
- kPa, l/s
- USPGM, ft

Units

Keylock ON Cancel 5 sec

Factory setting Reset energy counter/ Cancel

## External module

Bluetooth

Bluetooth Connectable Dynamic PIN

<https://www.esbe.eu/group/products/circulation-units/grb300>  
(Download area)

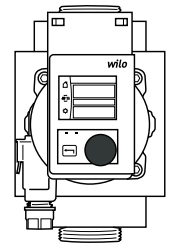

## Maintenance

Pump venting ON Stop

Manual restart ON Stop

Key lock ON Cancel 5 sec

Energy counter 0 kWh

Installer contact

## Fault, causes and remedies

Warning: E011	E007	
Pump running dry	E011	
	E021	
	E038	
Error: E004	E004	E023
Undervoltage	E005	E025
	E009	E030
	E010	E031
	E020	E036
	E021	



<https://www.esbe.eu/group/products/circulation-units/grb300>  
(Download area)