

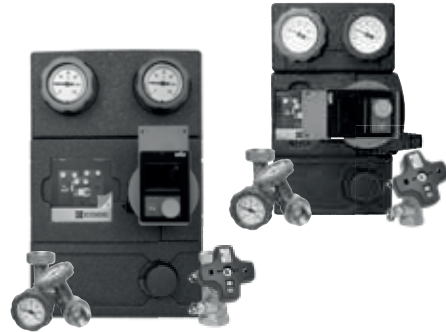

ESBE AB
Bruksgatan 22
SE-333 75 Reftele
www.esbe.eu

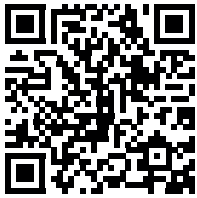

ESBE System Units
CIRCULATION UNIT DN25-DN32, DN20

SERIES GRAx61



Series GRA261
Series GRA361

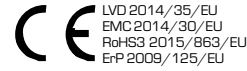

PED 2014/68/EU, article 4.3

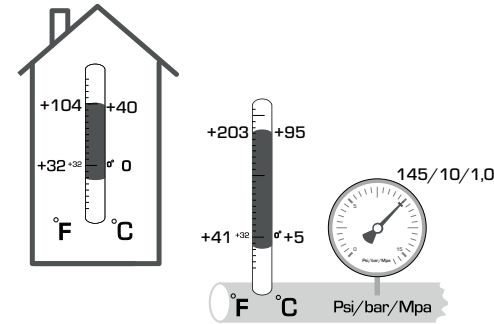

SERIES	FUNCTION
ESBE GRA261 DN25-DN32	
ESBE GRA361 DN20	

Mtrl.no. 98141192 • Dwg. 11112 • vers. A • Rev. 2026-01-09



Mounting position

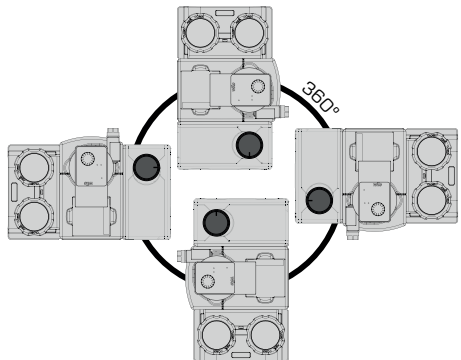
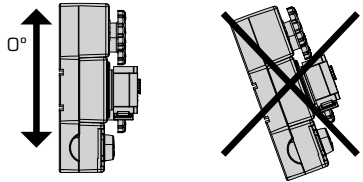

Cabling • Dimensions

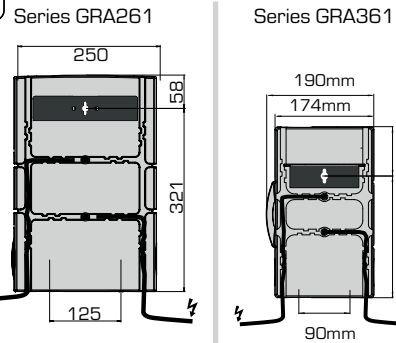

Remove knob

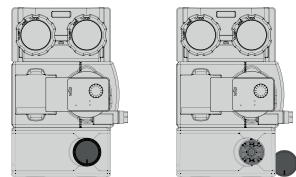

Disassembly insulation

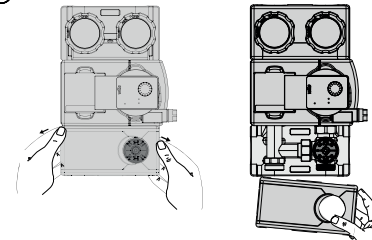

Pull up insulation 7mm and remove

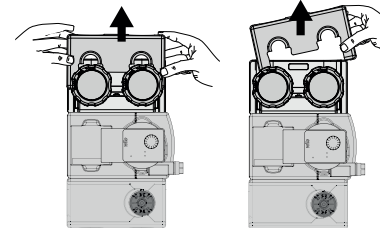

Assembling on wall

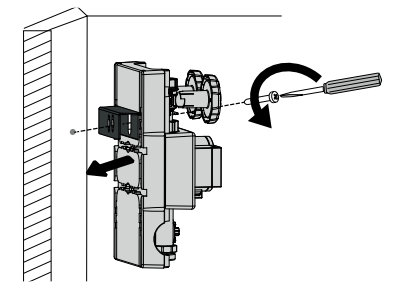

Adjust wallbracket

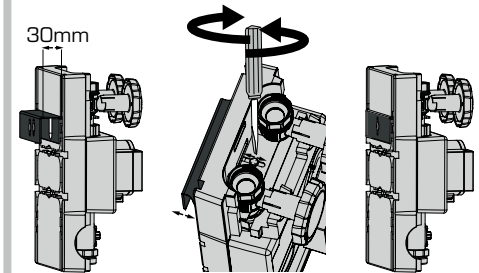

4a**Fit supply pipes DN20**

c/c 90mm

Add balancing valves

Add ballvalves

30-40Nm

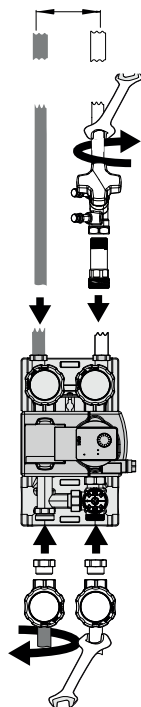
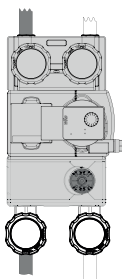
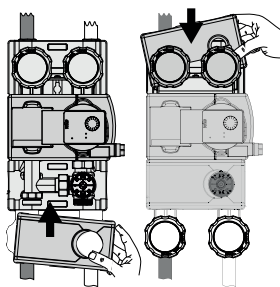
**Assemble insulation****4b****Fit supply pipes DN25/32**

c/c 125mm

Add balancing valves

Add ballvalves

40-50Nm

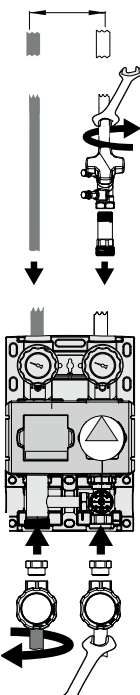
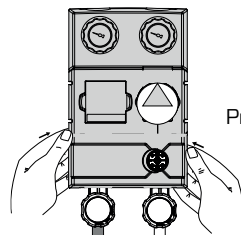
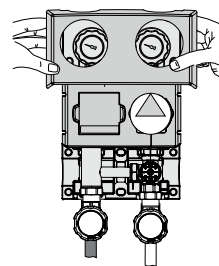
**Assemble insulation**

Press

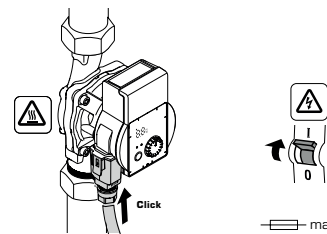
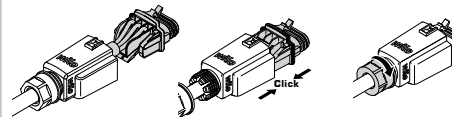
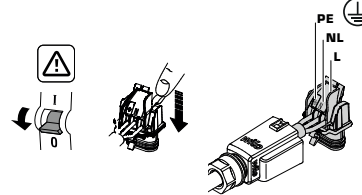
i**Electric installation****i** www.esbe.eu**i****Commissioning
Balancing valve**

<https://www.esbe.eu/group/products/circulation-units>
[Download area]

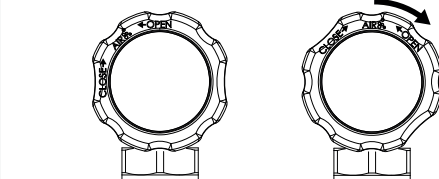
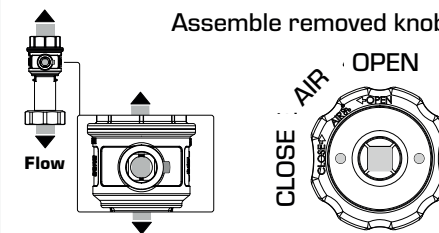
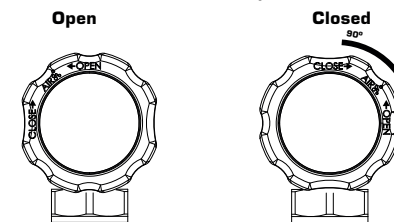
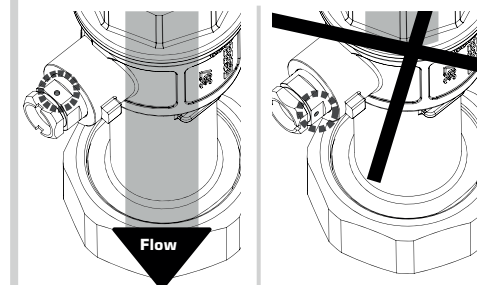
i**Commissioning****Preparation****Filling and venting****Assemble removed knob****Checkvalve position****Drilled mark, indicate
check valve position**

5

Assemble actuator/controller

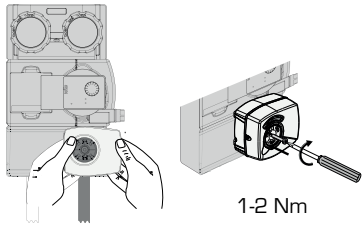

Mounting position actuator/controller

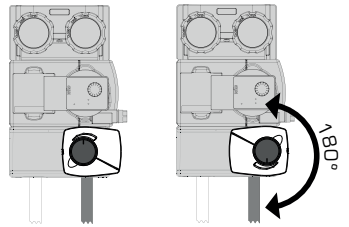

i

Commissioning actuator/controller

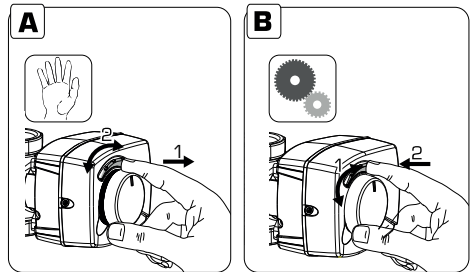
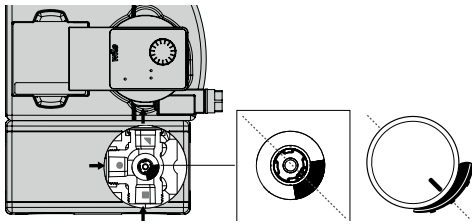

www.esbe.eu/group/products/controllers
[Download area]



www.esbe.eu/group/products/rotary-actuators
[Download area]



Pump GRAX61 Display

Language

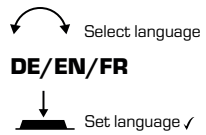

After selecting the language, the display changes to the home screen (factory setting = Dynamic Adapt plus) and the pump can be operated via the main menu.

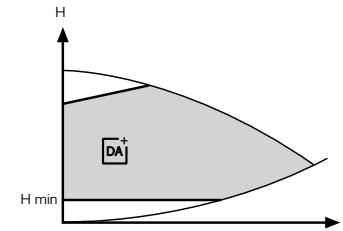
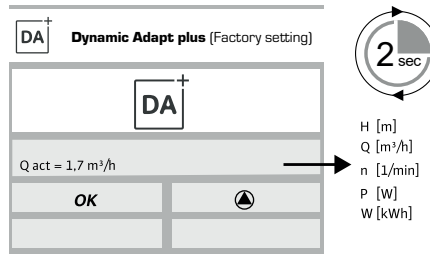

Home screen

Pump setting

Setting assistant

No. of radiators

1...15, 20, 30

Stratos PICO ...	0.5-4m	0.5-6m	0.5-8m
Max.	15	20	30

Floor surface

1... 220, 300m²

Stratos PICO ...	0.5-4m	0.5-6m	0.5-8m
Max.	120 m ²	220 m ²	300 m ²

Manual setting

- Control mode
 - DA+ Dynamic Adapt plus*
 - Δp-v
 - Δp-c
 - Speed n-const

Setpoint

- Δp-v H set = 0.5 ... 4, 6, 8 m
- Δp-c H set = 0.5 ... 4, 6, 8 m
- Speed n-const Speed I, speed II, speed III

Night set back

ON/OFF

Pressure ind. valve

ON/OFF

Device setting

Brightness

0 - 100 %

Language

German, English, French

Units

- m, m³/h*
- kPa, m³/h
- kPa, l/s
- USPGM, ft

Keylock

ON Cancel 5sec

Factory setting

Reset energy counter/ Cancel

External module

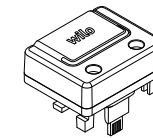
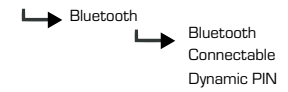

<https://www.esbe.eu/group/products/circulation-units>
(Download area)

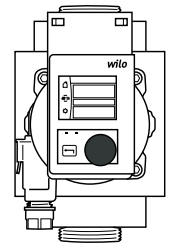

Maintenance

Pump venting

ON Stop

Manual restart

ON Stop

Key lock

ON Cancel 5sec

Energy counter

0 kWh

Installer contact

Fault, causes and remedies

Warning: E011	E007	
Pump running dry	E011	
	E021	
	E038	
Error: E004	E004	E023
Undervoltage	E005	E025
	E009	E030
	E010	E031
	E020	E036
	E021	



<https://www.esbe.eu/group/products/circulation-units>
(Download area)