

ESBE SERIES CRB100



Series CRB110
Series CRB120



LVD 2006/95/EC
EMC 2004/108/EC
RoHS 2002/95/EEC
EN 300202

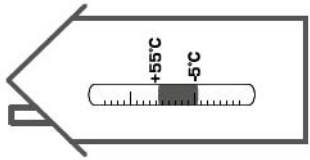

1A



Series CRB120

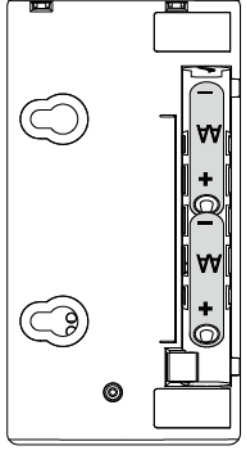
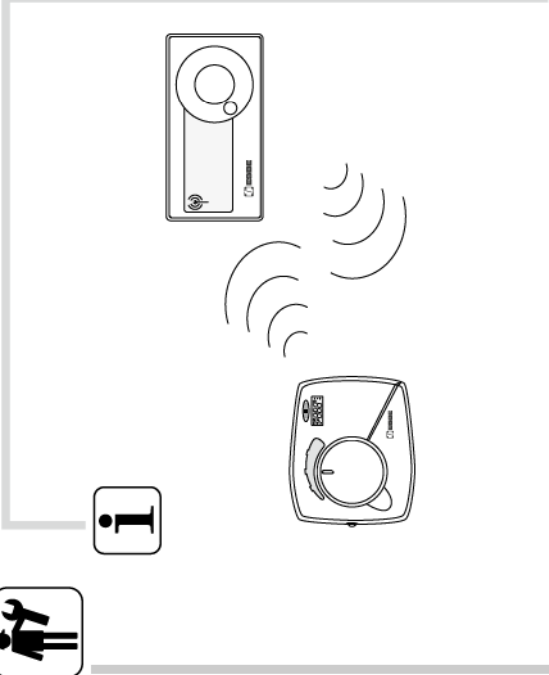
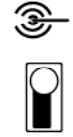

X 2

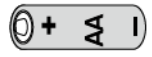

1B



Series CRB110

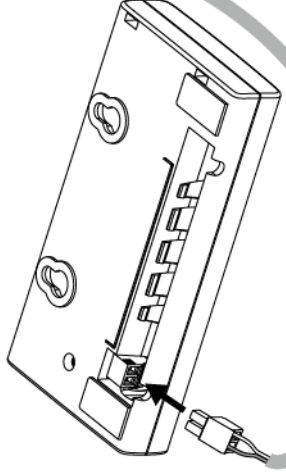
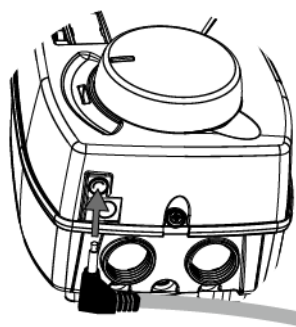
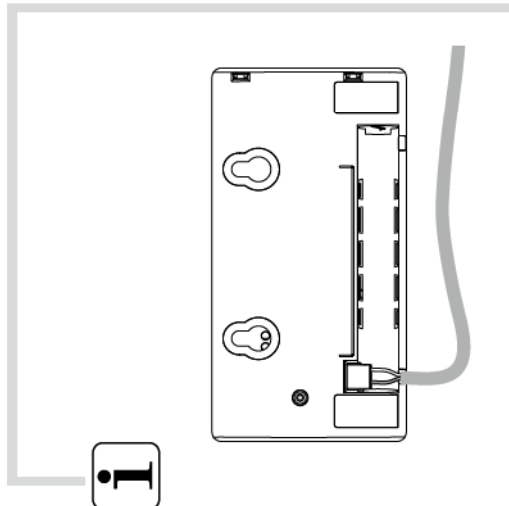

180°

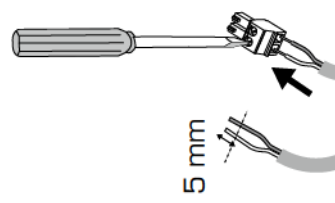

5 mm

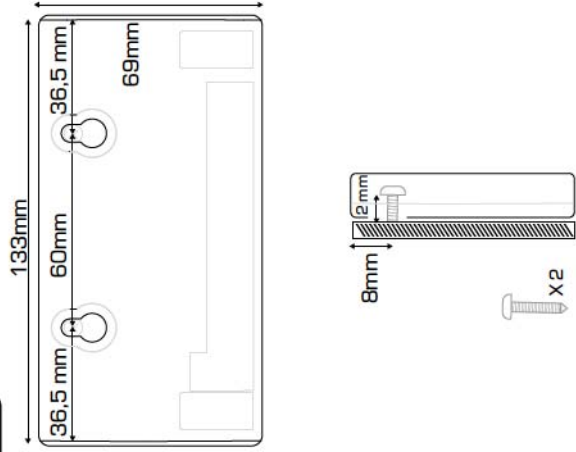
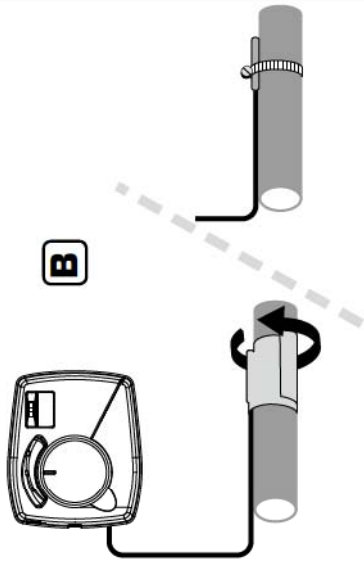
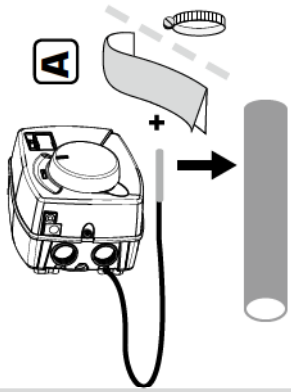

www.esbe.se

Meritnr: 98 14 03 91 • Riknrnr: 92 11 utg. B • Rev. 1012

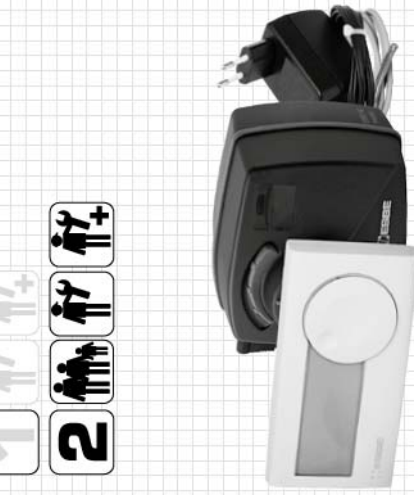
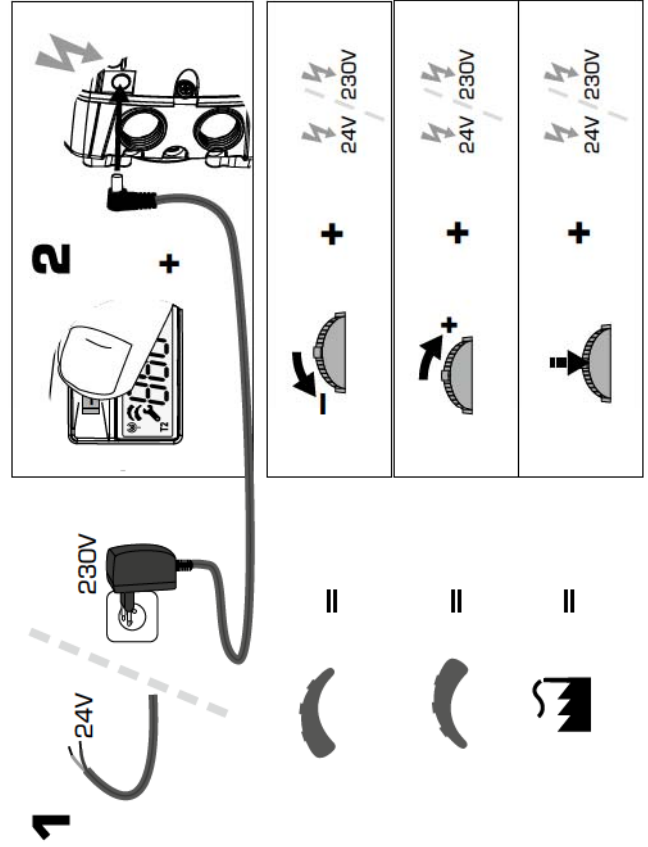
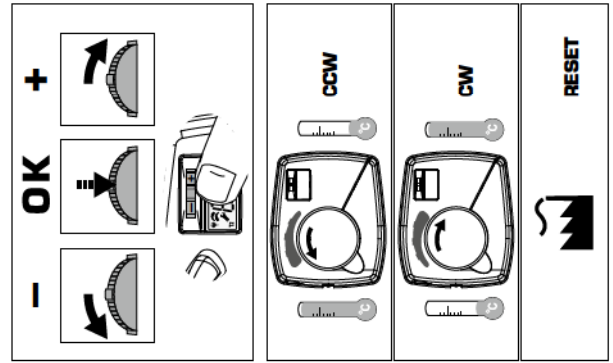
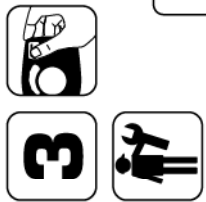

SERIES CRB100



NO.1 IN HYDRONIC SYSTEM CONTROL

4

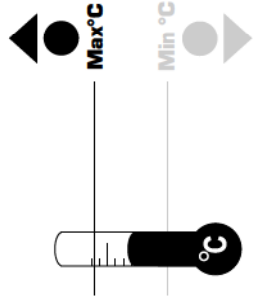
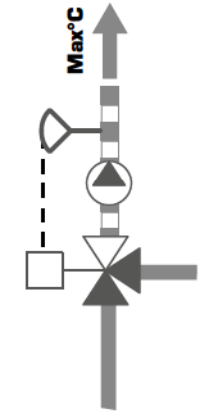

- 50 °C
- ~40 - 50 °C
- ~60 - 80 °C

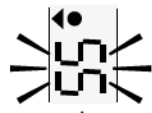
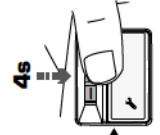

5

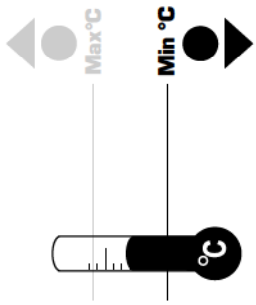
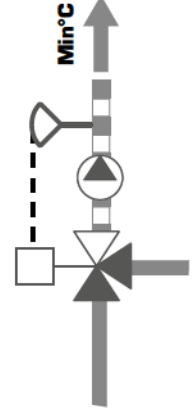

- 5 °C
- ~5 - 25 °C
- ~5 - 25 °C

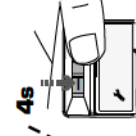
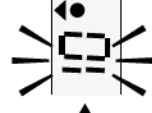
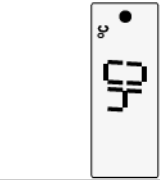

MIN

i

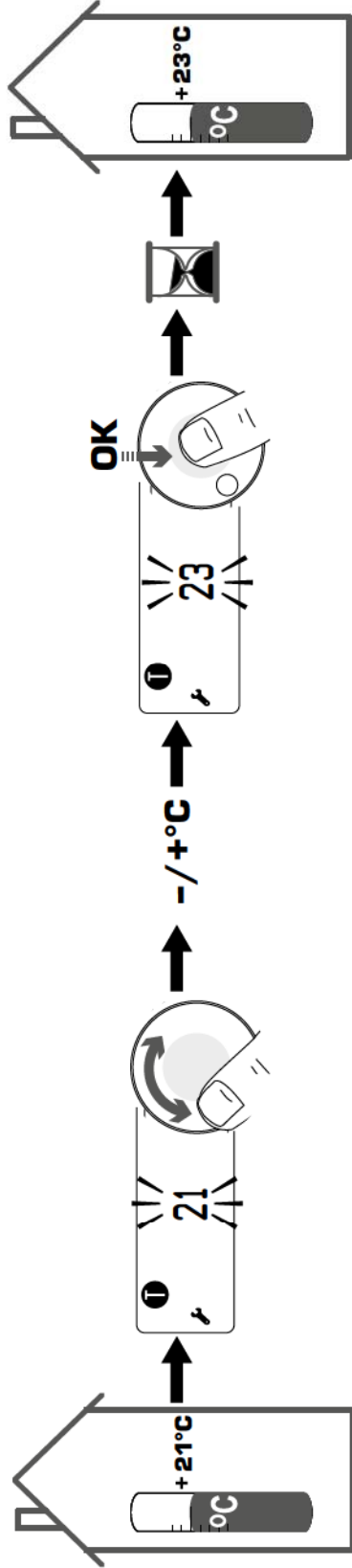
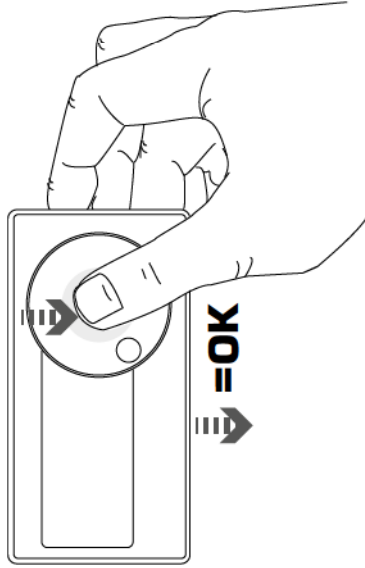
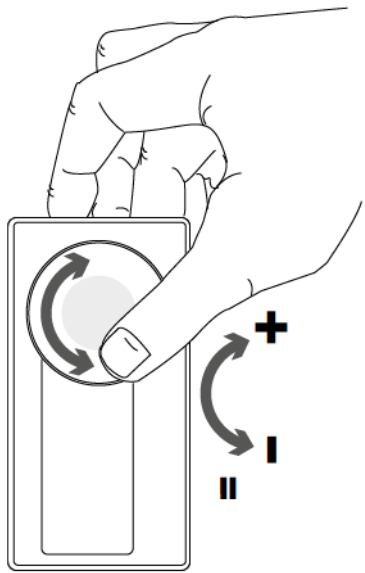

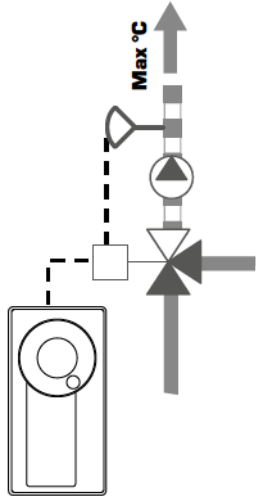

i

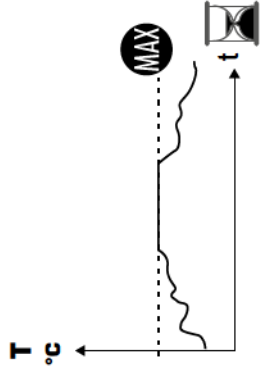

	50 °C
	~40 - 50 °C
	~60 - 80 °C
	60 °C

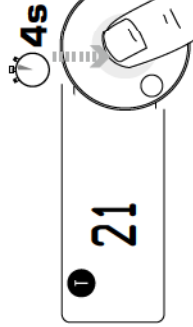

21

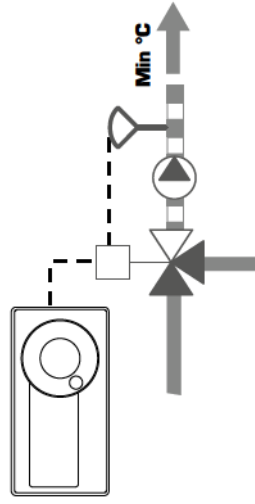
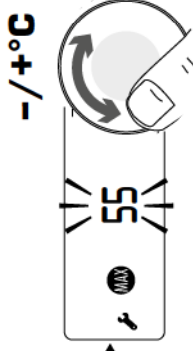
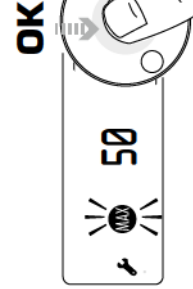
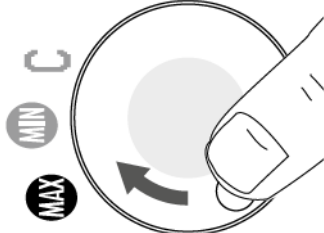

i

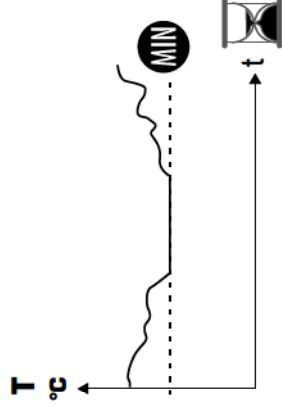

	5 °C
	~5 - 25 °C
	~5 - 25 °C
	~5 - 25 °C

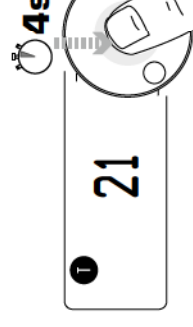

21

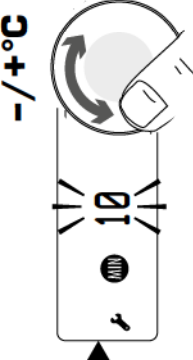
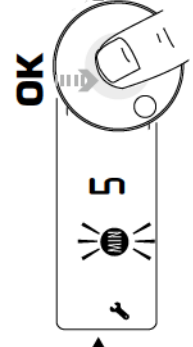
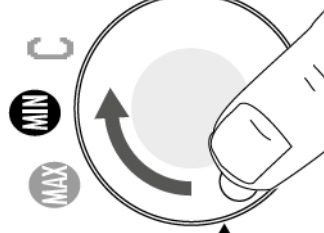

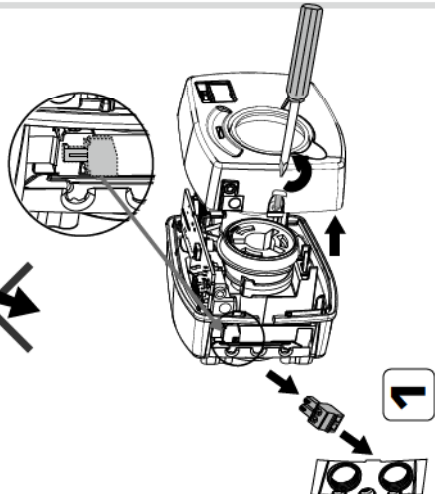
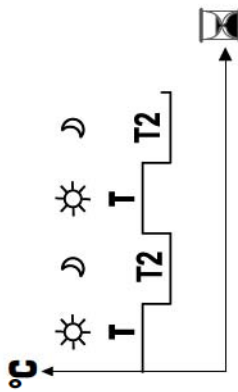
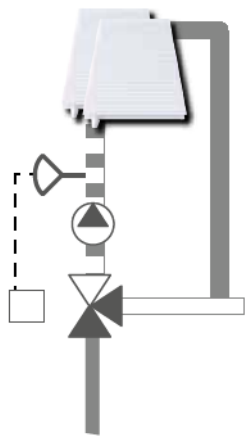

1

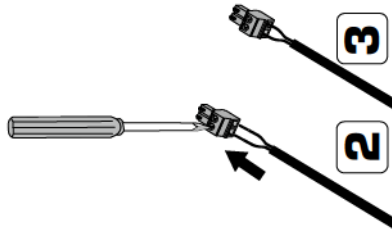

2

3

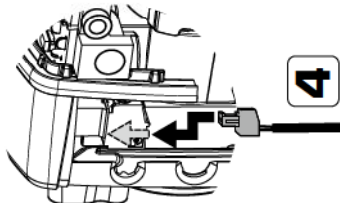

4

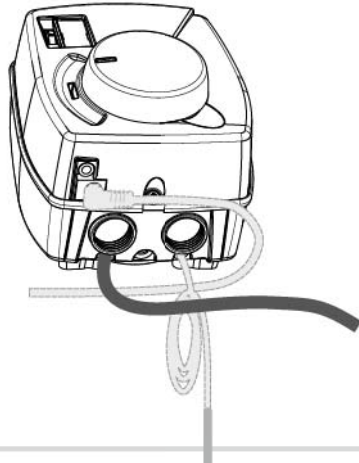

5

6

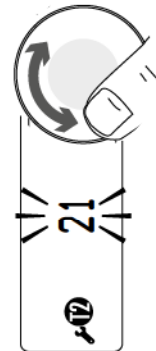
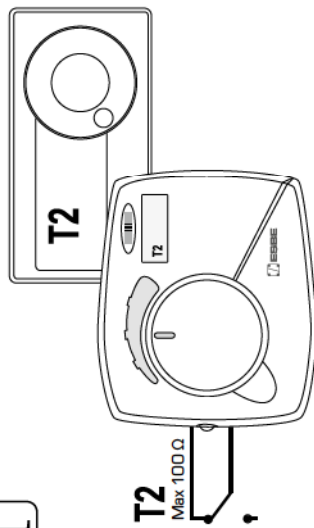

+/+°C

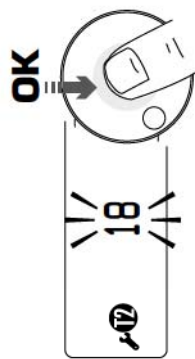

OK



C

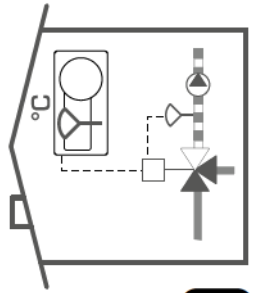

C-0

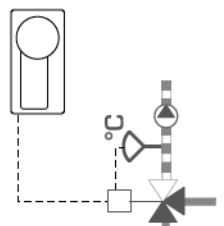

C-1

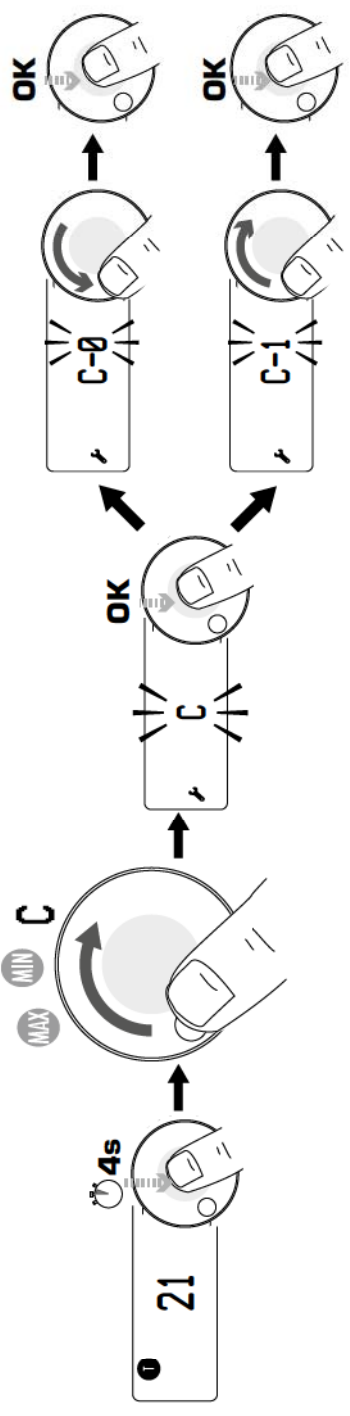

Series CRB113 **ON/OFF**

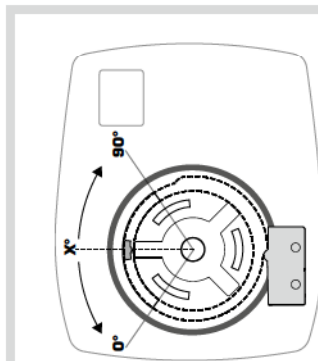

	0°-X°	X°-90°	
NO			
NC			
			X° = 45°

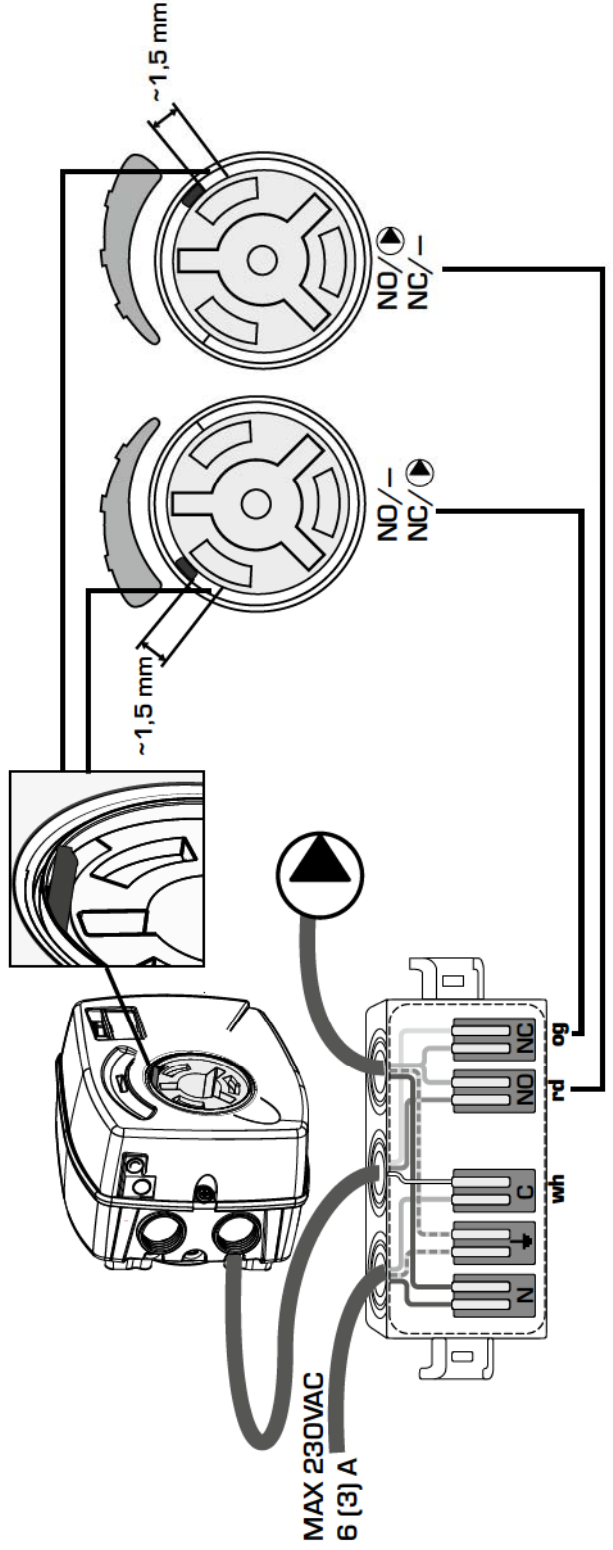

T

i

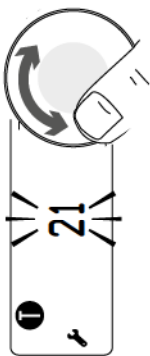
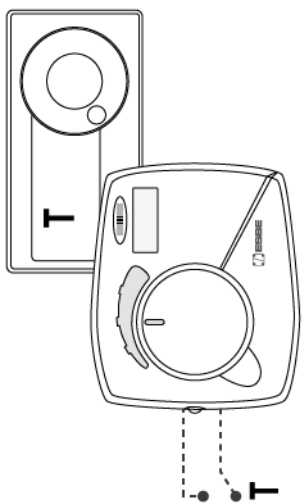

— / + °C —>

