

# WUN 90

## 90° transition elbow HD-PE/brass with external thread

Transition elbow brass pipe WUN 90

- Water
- Maximum pressure: Water 16 bar
- Material: PE 100 and brass (EN 12168 - CW617N, thread according to EN 10226-1)
- Safety technology

### Note:

The brass side is anchored as non-detachable and non-rotatable in PE.

Self-sealing, patented sealing geometry without elastomeric seal for utilisation in water areas.

Default: Brass, gunmetal on request.

Other thread dimensions available on request.

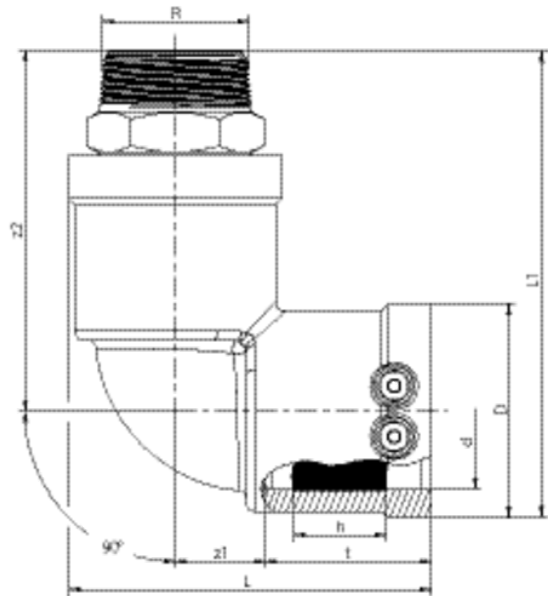

PE 100 SDR 11

Maximum permissible working pressure 16 bar (water)



Reference	d	R	D	h	L	t	z <sub>1</sub>	z <sub>2</sub>	Weight kg	BX	PU
612120	32	1"	47	24	85	42	21	89	0,340	20	1000
612140	32	1 1/2"	47	24	94	42	21	93	0,470	20	800
612127	40	1"	58	30	102	46	27	101	0,500	15	750
612122	40	1 1/4"	58	30	102	46	27	103	0,520	15	750
612121	40	1 1/2"	58	30	102	46	27	104	0,560	15	750
612119	50	1"	70	30	118	53	30	110	0,680	10	500
612123	50	1 1/4"	70	30	118	53	30	112	0,670	10	500
612124	50	1 1/2"	70	30	118	53	30	113	0,680	10	500

# WUN 90

## 90° transition elbow HD-PE/brass with external thread

Reference	d	R	D	h	L	t	z <sub>1</sub>	z <sub>2</sub>	Weight kg	BX	PU
612125	63	1 1/2"	84	35	128	53	33	116	0,980	10	320
612126	63	2"	84	35	128	53	33	121	1,000	10	320

Other thread dimensions on request

FRIALEN safety fittings can be fused with SDR11 - SDR17.6 pipes, minimum wall thickness s minimum  $\geq 3$  mm. Other levels of SDR can be processed on request. Please note the mandatory labels directly on the product. DVGW test mark issued: DV-7501AU2256

Default: Brass. Gunmetal and V2A on request

## WUN 90

### 90° transition elbow HD-PE/brass with external thread

#### Areas of Application

FRIALEN-Transition Elbows WUN 90° are threaded joints as an adaptor from a metal pipe with internal thread to a HD-PE pipe. Joint on the part of HD-PE by FRIALEN-Coupler.

#### Assembly Instructions

The threaded component must be held with a spanner to prevent it twisting in the HD-PE component. The fusion of the HD-PE side takes place by FRIALEN-fusing – leakproof and longitudinally strong.

The installation of the brass and the HD-PE side has to be prepared according to the general installation instructions (see "Transition Fittings with threaded connection" in "Assembly Instructions" for "FRIALEN-Safety Fittings for house connections and distribution pipes up to d 225"). This involves removing the oxide skin and cleaning the pipe ends.

#### Good reasons for using the FRIALEN-Transition Elbows WUN 90°:

- Compact construction
- HD-PE side with exposed heating element for optimal heat transfer
- Cold zones at the end to prevent the flow of molten material
- No holding clamps required
- Large insertion depth, extra wide fusion zones
- Brass end permanently anchored in the HD-PE and will not distort
- Self sealing patented sealing geometry without elastomer seal
- Additional barcode for tracing back the underground fitting (Traceability-Coding)