

# FRIASTOP M

## Gas-Stop SENTRI GS by Maxitrol

Gas-Stop FRIASTOP with SENTRI GS System by Maxitrol

- Gas and H2 (100 %)
- Maximum pressure:
  - Type Z and B 5 bar gas
  - Type D 1 bar gas
- Material: PE 100
- Overflow device for Type D and Z
- Function with admixture of 100 % hydrogen
- Safety technology
- DVGW test mark: DV-8601AU2248 and DG-4360BO0438

**Note:**

Application 100% hydrogen according to current regulations.

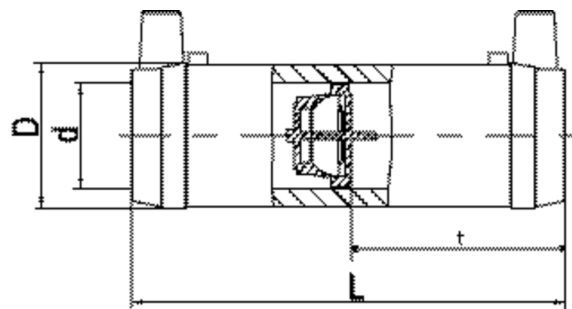
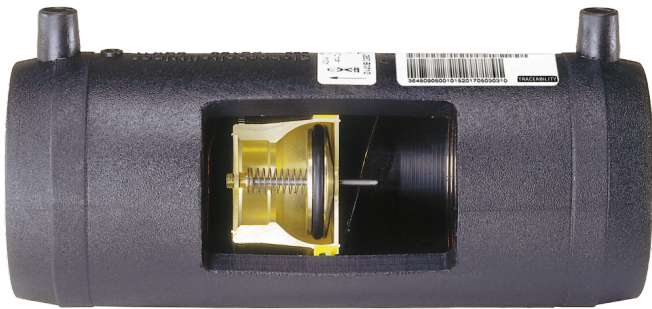

PE 100 SDR 11

Maximum permissible working pressure Type Z, B: 5 bar (gas), Type D: 1 bar (gas)



Reference	d	Type	D	L	t	Operating pressure range $p_{min} - p_{max}$	VN	Weight kg	BX	PU
616187	32	Z	45	136	65	35 mbar - 5 bar	17 - 40	0,140	40	1280
616188	40	Z	54	146	71	35 mbar - 5 bar	26 - 62	0,220	30	960
616189	50	Z	68	175	85	35 mbar - 5 bar	41 - 99	0,380	16	512
616190	63	Z	82	197	96	35 mbar - 5 bar	66 - 158	0,530	10	320
616191	32	D	45	136	65	25 mbar - 1 bar	11 - 16	0,140	40	1280
616193	40	D	54	146	71	25 mbar - 1 bar	19 - 27	0,220	30	960
616195	50	D	68	175	85	25 mbar - 1 bar	28 - 40	0,380	16	512
616197	63	D	82	197	96	25 mbar - 1 bar	51 - 72	0,530	10	320
616192	32	B	45	136	65	100 mbar - 5 bar	26 - 60	0,140	40	1280

FRIALON safety fittings can be fused with pipes with SDR levels 11 to 17.6. Minimum wall thickness  $s$  minimum  $\geq 3$  mm. Other SDR levels available on request. Please note the mandatory labels directly on the product. DVGW test marks issued: FRIALONG = DV-8601AU2248.

Long coupler = DG-4360BO0438.

The **universal Type Z** optimally covers the practical requirements for the working pressure range and the required flow rate. Type Z has an overflow opening. Other types available on request.

# FRIASTOP M

## Gas-Stop SENTRI GS by Maxitrol

$p_{\min}$  -  $p_{\max}$ : min. - maximum working pressure and/or input pressure Maxitrol.

$v_N$ : Nominal flow rate at  $p_{\min}$  -  $p_{\max}$ , based on natural gas  $d = 0.6$  in standard mode (1013.25 mbar, 15 °C) in  $m^3/h$ .

Type D, Z: Maxitrol with overflow device, maximum overflow quantity D: 30 l/h at 100 mbar, Z: 30 l/h at 1 bar.

Type B: Maxitrol without overflow device, maximum leakage rate: 3.0 l/h.

# FRIASTOP M

## Gas-Stop SENTRI GS by Maxitrol

### Areas of Application

FRIASTOPP is used for gas and service lines according to DVGW G459-1 appendix (12/03) with operating pressure from 25 mbar – 5 bar. FRIASTOPP is a safety device which automatically cuts off the gas flow in the event of pipe damage, e.g. caused by dredging or drilling. FRIASTOPP is best installed in the branch between mains and service line, immediately behind the service line valve. The Maxitrol type selection takes place according to the minimum operating pressure of the network and the required flow output based on consumption.

The **universal type Z** meets perfectly the practical requirements of the operating pressure range and the required flow volume. Type Z boasts a surplus flow opening.

### Functions

(see also info sheet on technical data "excess flow valve SENTRY GS for underground external pipe systems by Maxitrol). FRIASTOPP is subdivided into types D, B or Z depending on mains pressure range. It cuts off automatically at a defined gas flow volume as typically occurs when a gas service line is damaged. Gas flow is cut off instantaneously and completely. The types D and Z have surplus flow devices. The surplus flow amount here allows the pressure in the intact gas pipe to rise again to allow the gas flow monitor system to reopen automatically.

Type D, Z: Maxitrol with surplus flow device: surplus flow amounts of over 30 l/h require according to DVGW-G459-1-B additional passive safety measures in the building.

Type B without surplus flow opening is reopened by the application of counter pressure (ca. network pressure). It does not need to be made accessible again for this purpose.

### Advice on Processing

FRIASTOPP is to be processed according to the installation and operating procedures. Constricting the gas route by means of FRIASTOPP is authorised up to 10 bar if the excess flow valve is open.

The initial mains pressure of the component may be read on the data plate:

- yellow data plate (Type Z) for 35 mbar to 5 bar,
- orange data plate (Type D) for 25 mbar to 1 bar,
- white data plate (Type B) for 100 mbar to 5 bar.

The use of this component should be marked at the main shut-off device of the building (appropriate label or ID card is included with the delivery). Fusion of FRIASTOPP with the HD-PE service line takes place using the FRIALEN fusion process – leakproof and longitudinally strong.

Installation is prepared according to the general installation requirements (see "Assembly Instructions" for "FRIALEN Safety Fittings for house connections and distribution pipes up to d225"), i.e. remove oxidic layer and clean.

### Good reasons for using FRIASTOPP:

- Factory made combination made from FRIALEN FRIALONG long coupler and Maxitrol excess flow valve
- The reduction in the cold zones by the integrated GS is more than compensated in comparison with the standard coupler
- Increased installation safety when using coiled pipes in domestic connections
- The exposed heating coil and the extra wide fusion zones ensure optimum heat transmission
- Additional barcode for tracing back the underground fitting (Traceability-Coding)

### The excess flow valve

# FRIASTOP M

## Gas-Stop SENTRI GS by Maxitrol

- has been adjusted precisely in the factory (VN)
- has low pressure loss
- is largely resistant to pollutants in the gas
- has been successfully applied many thousand times in Germany using these principles
- has pressure increase from low to medium pressure possible with suitable network
- Type Z: can be applied universally from 35 mbar to 5 bar, simple storage, no danger of confusion, low operational training cost