

BISOFIX® E19 Isolerskål

(D 03 14)

isolerskål 12,0 - 219,1 mm

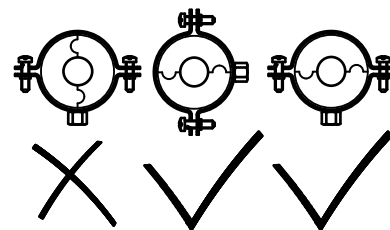

Funktioner och Fördelar

- används tillsammans med PUR/cellgummi -isolering
- klarar temperaturer mellan -45 °C - +105 °C
- diffusionstät och limmas med rörisolering
- fri från CFC, HCFC, formaldehyd eller kadmium
- brandklass B2
- PIR densitet för D <80mm = 80kg/m³
- PIR densitet för D >80mm = 120kg/m³

| Art.nr. | RSK nr | BVB | D (mm) | D (°) | DN | L | H (mm) | s (mm) | F _{a,z} (N) | fp |
|------------|---------|--------|---------------|----------|-----|--------|-----------|-----------|-------------------------|----|
| I190000012 | 3853203 | 141428 | 12,0 | - | - | 50 mm | 50,6 | 19,3 | 100 | 25 |
| I190000015 | 3853204 | 141428 | 15,0 | - | - | 50 mm | 54,0 | 19,5 | 100 | 25 |
| I190000018 | 3853205 | 141428 | 17,2 - 18,0 | 3/8 | 10 | 50 mm | 56,6 | 19,3 | 100 | 25 |
| I190000022 | 3853206 | 141428 | 21,3 - 22,0 | 1/2 | 15 | 50 mm | 60,6 | 19,3 | 100 | 25 |
| I190000028 | 3853207 | 141428 | 26,9 - 28,0 | 3/4 | 20 | 50 mm | 66,6 | 19,3 | 100 | 25 |
| I190000035 | 3853208 | 141428 | 33,7 - 35,0 | 1 | 25 | 50 mm | 74,8 | 19,9 | 100 | 25 |
| I190000042 | 3853209 | 141428 | 42,4 | 1 1/4 | 32 | 50 mm | 81,0 | 19,3 | 150 | 25 |
| I190000048 | 3853210 | 141428 | 48,3 | 1 1/2 | 40 | 50 mm | 88,1 | 19,9 | 225 | 25 |
| I190000054 | 3853211 | 141428 | 54,0 | - | - | 50 mm | 100,0 | 23,0 | 225 | 25 |
| I190000057 | 3853212 | 141428 | 57,0 | - | - | 50 mm | 103,0 | 23,0 | 225 | 25 |
| I190000060 | 3853213 | 141428 | 60,3 | 2 | 50 | 50 mm | 100,1 | 19,9 | 350 | 25 |
| I190000064 | 3853214 | 141428 | 64,0 | - | - | 50 mm | 114,6 | 25,3 | 350 | 25 |
| I190000070 | 3853215 | 141428 | 70,0 | - | - | 50 mm | 124,6 | 27,3 | 425 | 25 |
| I190000076 | 3853216 | 141428 | 76,1 | 2 1/2 | 65 | 50 mm | 126,7 | 25,3 | 575 | 25 |
| I190000089 | | 141428 | 88,9 | 3 | 80 | 50 mm | 139,5 | 25,3 | 875 | 25 |
| I190000102 | 3853218 | 141428 | 101,6 | - | - | 50 mm | 152,2 | 25,3 | 1 000 | 25 |
| I190000108 | 3853219 | 141428 | 108,0 | - | - | 50 mm | 158,6 | 25,3 | 1 075 | 25 |
| I190000114 | 3853220 | 141428 | 114,3 | 4 | 100 | 50 mm | 164,9 | 25,3 | 1 250 | 25 |
| I190000133 | 3853221 | 141428 | 133,0 | - | - | 100 mm | 192,0 | 29,5 | 1 475 | 5 |
| I190000140 | 3853222 | 141428 | 139,7 | 5 | 125 | 100 mm | 192,1 | 26,2 | 1 700 | 5 |
| I190000160 | 3853223 | 141428 | 159,0 - 160,0 | - | - | 100 mm | 210,6 | 25,3 | 1 950 | 5 |
| I190000168 | 3853224 | 141428 | 168,3 | 6 | 150 | 100 mm | 218,9 | 25,3 | 2 125 | 5 |
| I190000219 | 3853225 | 141428 | 219,1 | 8 | 200 | 100 mm | 269,7 | 25,3 | 3 525 | 3 |

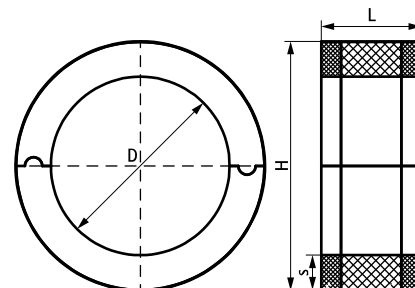

Kompletterande

Bifix® G2 (M8/10) (BUP1000)
2S Klammer (M8/10)
Walraven Heavy Duty Klammer HD500 (BUP1000)

Kompletterande

Walraven Heavy Duty Klammer HD500 (M16) (BUP1000)