

8

7

6

5

4

3

2

1

Area of Application:

Water

Max. working pressure 10 bar
Temperature range 5°C-65°C

Details:
Inside diameter Ø9,5mm
Outside diameter Ø14mm
Min. bending radius (inner) 40mm

Materials in media contact:
Brass
Rubber, NBR
Silicone
SS, AISI 316

Mounting:

Inlet / outlet connection:
ISO228/1 - G½", Union connection
ISO228/1 - G½", Fixed union connection with gasket

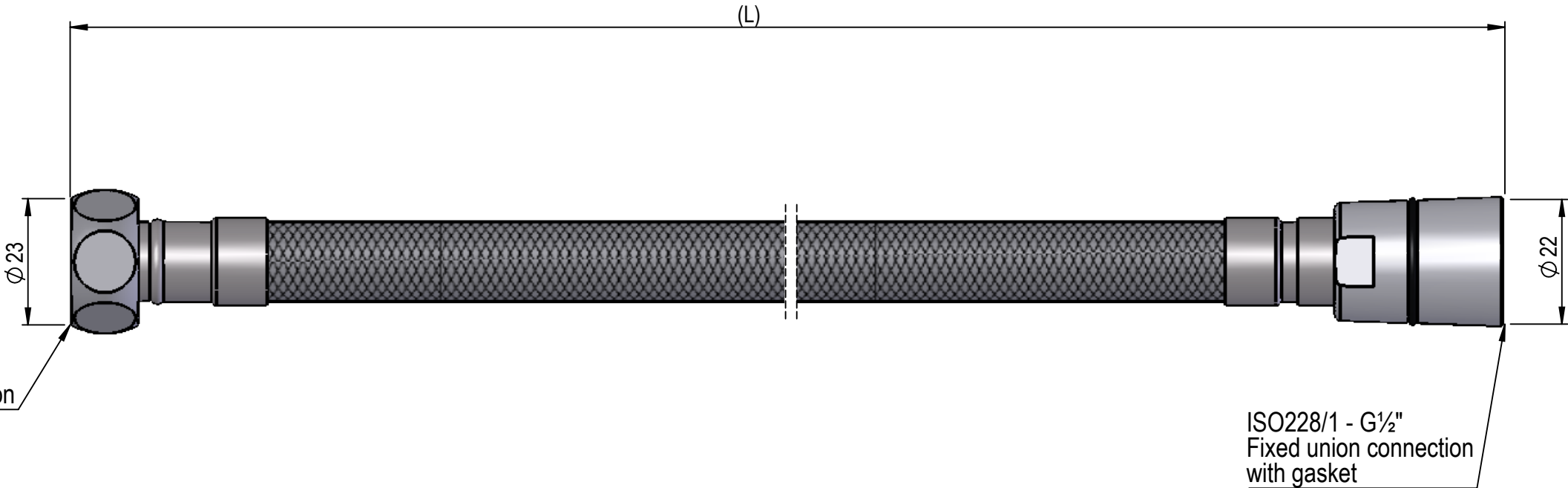

Standard lengths of hoses (L):

0500	500mm
0700	700mm
1000	1000mm
1200	1200mm
1500	1500mm
2000	2000mm
2500	2500mm
3000	3000mm

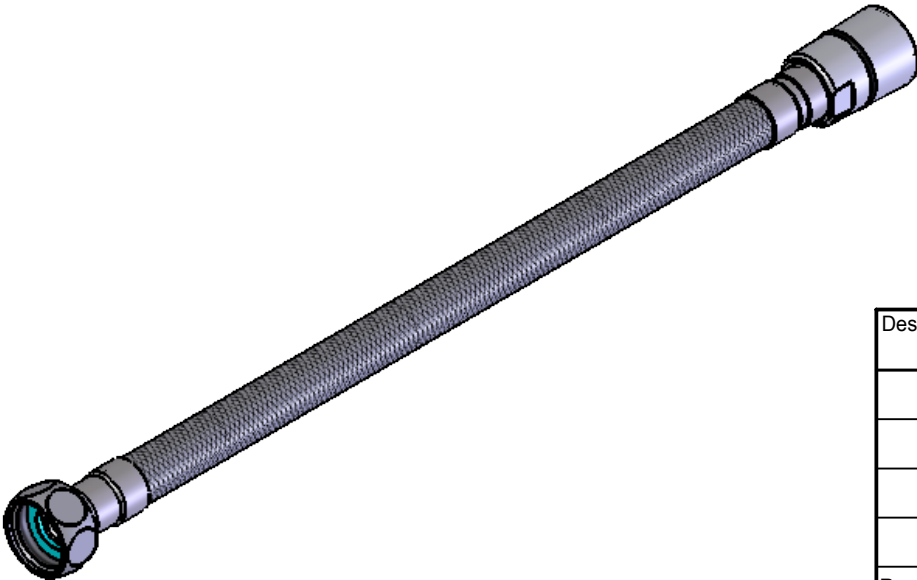

Description: Hose for BROEN-LAB ESS eye shower											
							Media: Water				
							Comments:				
							Drawing type: Customer drawing		Weight: Kg		
Rev.	Pos.	Date	TM No.	Design by	Drawn by:	Change:	Designed by: ROE	Drawn by: PEC	Released on TM No.	Date (DD-MM-YY): 07-03-21	
BROEN-LAB						This drawing is our property and cannot be given to a third party, copied or otherwise used without our permission. BROEN-LAB A/S.		Format: A3			Drawing No.: 93H4043XXXX

8

7

6

5

4

3

2

1