

Area of Application:
 Body Shower & Handheld Eye shower, Wall mounted
 Min. operation pressure: 1,5 Bar
 Max. operation pressure: 10 Bar
 Min. flow 60 l/min+12 l/min
 Product temperature range 1°C-70°C
 Operating water temperature range 15°C-37°C (ideal 20°C-25°C)

Details:
 BROEN-LAB Polyester powder coated colour red 3289
 Signs: Safety sign package Combi Shower (17001920)
 Drain: Male ISO 228/1 - G1/4"
 Design acc. EN15154-1, EN15154-2 & EN15154-5 (Class 2 - 60 to 100 l/min)

Materials in media contact:
 Main: Brass, Nickel plated brass, PTFE, Rubber EPDM, Silicone based lubricant
 Body Shower head: PPO, PP, Rubber EPDM, Silicone based lubricant
 Eye Shower: PP, PA6, PPH, TPE, Rubber EPDM, Silicone based lubricant
 Hose: Silicone, Nickel plated Brass, NBR, EPDM, Perfluoropolyether based lubricant

Mounting:
 Wall bracket Ø5,5 x 6 (60°) (See 94G0296)

Inlet / outlet connection:
 Female ISO 228/1 - G3/4"
 Body & Eye shower Spray Heads

Thermostatic mixing valve
 17512009

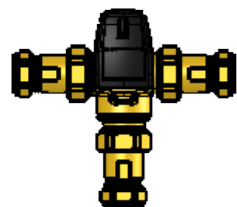

Cable for pull rod
 1790164



Signs & Instructions:
 17001920

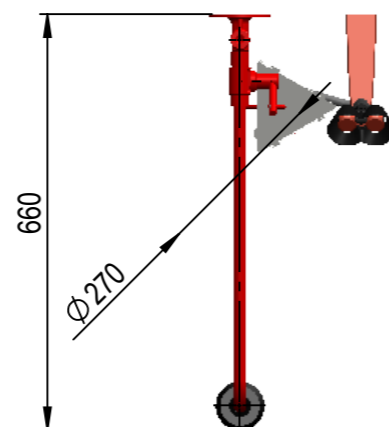
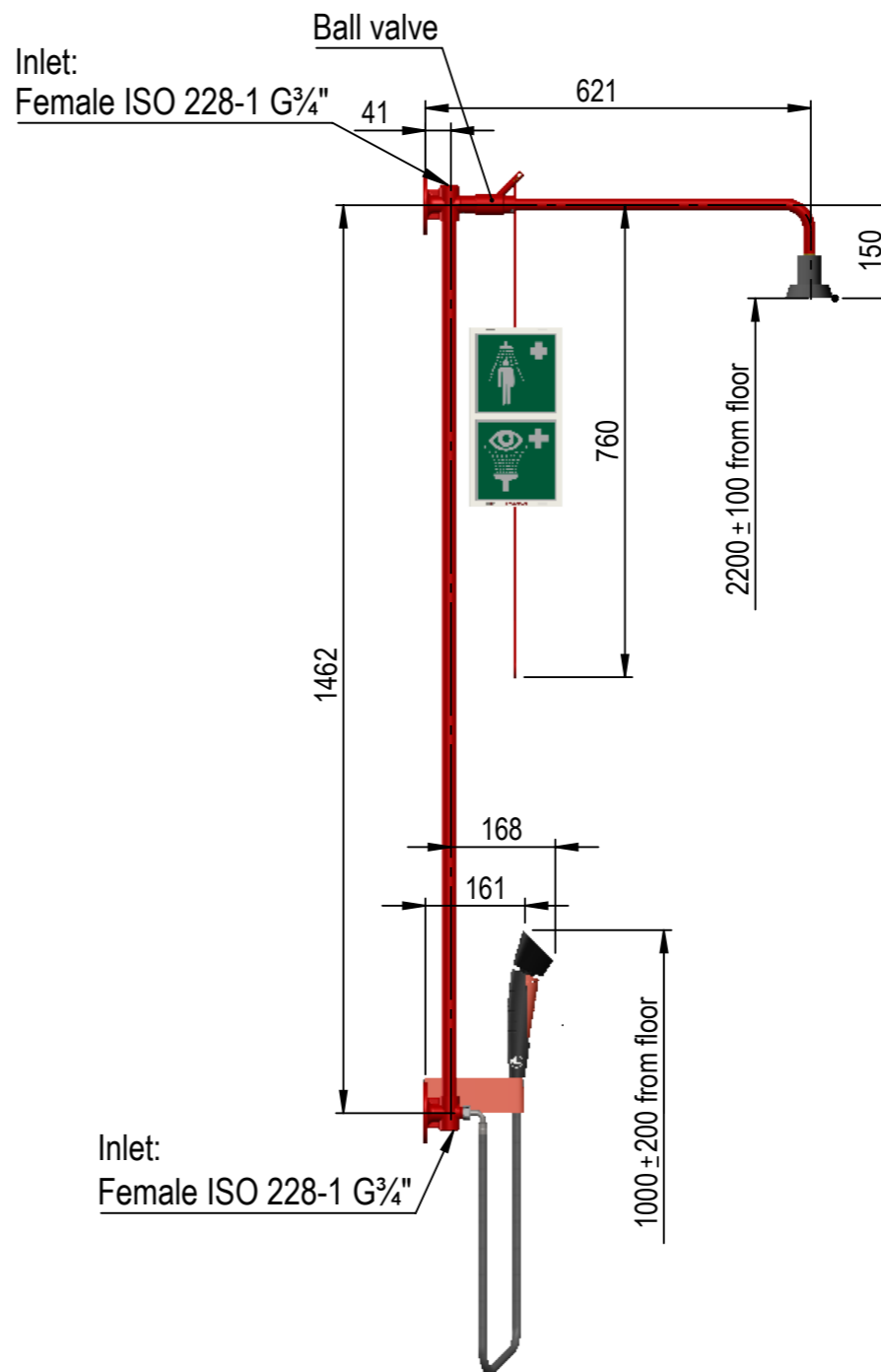
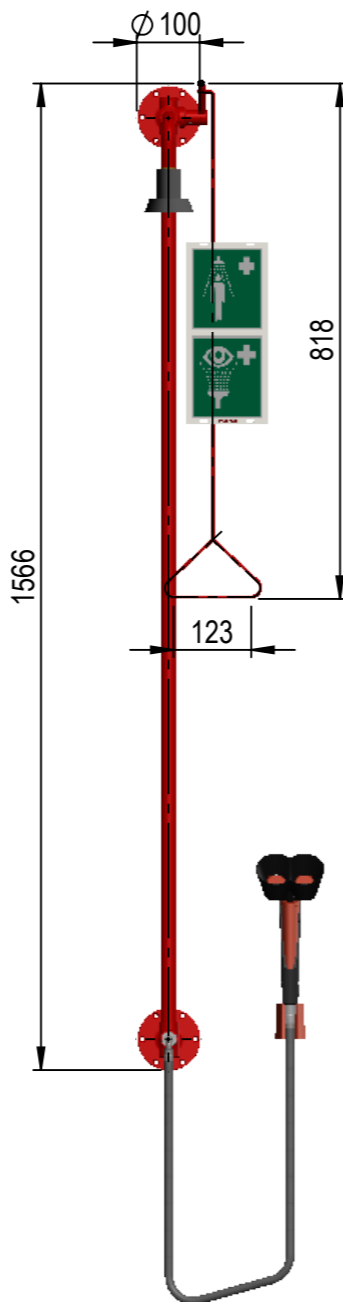

Description: Body Shower & Handheld Eye shower, Wall mounted, ball valve, 60L/min, TMV

						Media:	Water			
						Comments:				
						Drawing type:	Customer drawing		Weight:	6.466 Kg
Rev.	Pos.	Date	TM No.	Design by	Drawn by:	Change:	Designed by:	Drawn by:	Released on TM No.	Date (DD-MM-YY):
							NSC	VEF	10650	02-03-26
BROEN-LAB						This drawing is our property and cannot be given to a third party, copied or otherwise used without our permission. BROEN-LAB A/S.		Format:	Drawing No.: 27431061021061	
							A3			