

Area of Application:  
Bench mounted  
Water

Max. working pressure 10 bar  
Min. temperature 5°C  
Max. temperature 90°C

Details:  
Ceramic headwork open/close 180°  
3-Zone colour. acc. to EN13792:2002  
Swivel limited 110°  
1/2" removable nozzle

Materials in media contact:  
Brass  
Rubber. EPDM  
Silicone based lubricant  
Chrome plated, Brass

Mounting:  
M30x1,5 nut with locking pins, O-ring and washer (See 94G0232)  
Inlet / outlet connection:  
DN8 hose with G3/8 female inlet  
DIN 12 898 hose nozzle

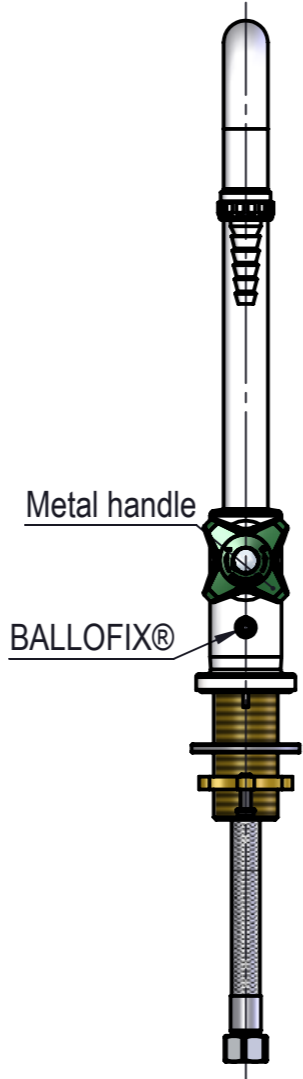

Metal handle

BALLOFIX®

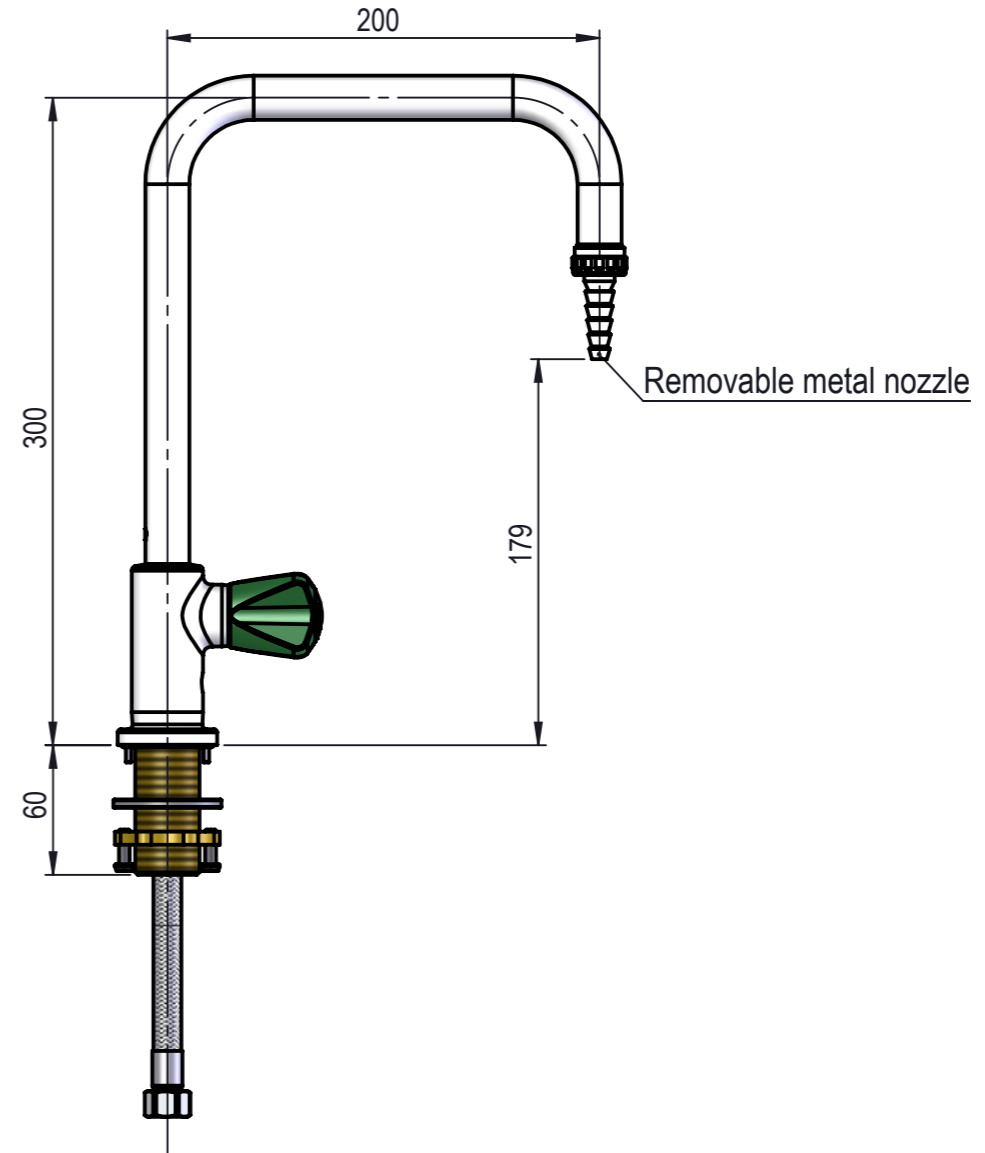
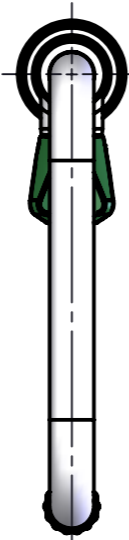

Removable metal nozzle

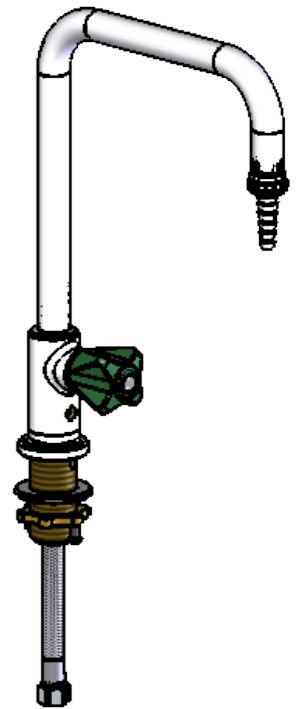

MEDIA CODE XX FOR WATER  
ONE MEDIA FITTING  
ACCORDING TO EN 13792

Media	Media description	Media code XX
WPC	Water potable cold	01
WPH	Water potable hot	02
WCF	Water coolant, feed	05
WCR	Water coolant, return	06
WNC	Water non-potable, cold	07
WNH	Water non-potable, hot	08
WRC	River water cold	33

Description: 1-Valve, Bench mounted, 1-Hole, Rem. Nozzle, M30x1,5mm							Media: Water			
							Comments:			
B	01-03-18			TLA			Drawing type: Customer drawing	Weight: 1.394 Kg		
Rev.	Pos.	Date	TM No.	Design by	Drawn by:	Change:	Designed by: VJE	Drawn by: MWA	Released on TM No.	Date: 25-10-2018
<b>BROEN-LAB</b>							Format: A3		Drawing No.: 253445080XX-52D	

This drawing is our property and cannot be given to a third party, copied or otherwise used without our permission. BROEN-LAB A/S.