

4

3

2

1

Area of Application:

Water

Max. working pressure 10 bar

Details:

Ceramic headwork open / close 90°

Materials in media contact:

Brass

Rubber, EPDM

Silicone based lubricant

Ceramic

POM

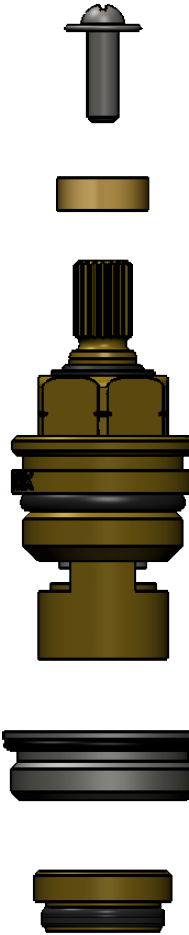
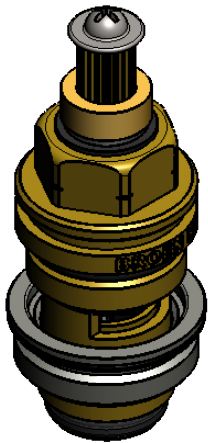

G1/2" adapter

Description:

Spare parts headwork

								Media:	Water						
								Comments:							
								Drawing type:	Customer drawing		Weight:	0,072 Kg			
Rev.	Pos.	Date	TM No.	Design by	Drawn by:	Change:		Designed by:	ROE	Drawn by:	PEC	Released on TM No.	8548	Date:	24-03-21
<b>BROEN-LAB</b>							This drawing is our property and cannot be given to a third party, copied or otherwise used without our permission. BROEN-LAB A/S.			Format:	A4	Drawing No.:	19765000		

4

3

2

1