

Förinställning  
antal varv från stängd ventil  
Pre-setting  
number of turns from closed  
valve.

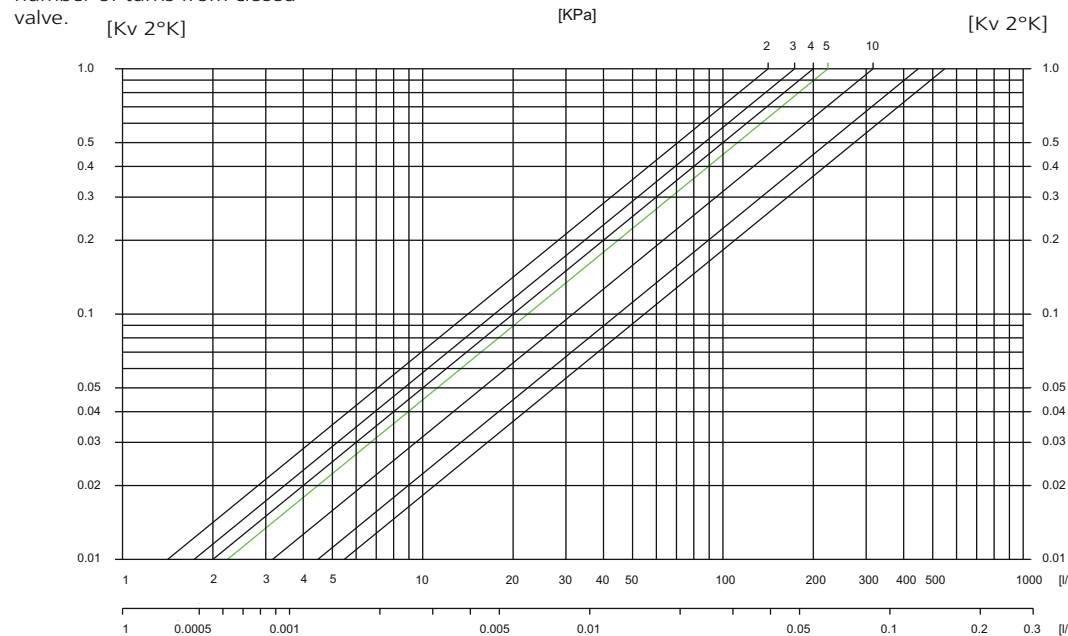

Angivna  $k_v$ -värden gäller för  
montering av termostat  
vilket ger nominell lyfthöjd.  
The  $k_v$ -value is valid with  
thermostatichead mounted  
which gives nominal stroke.

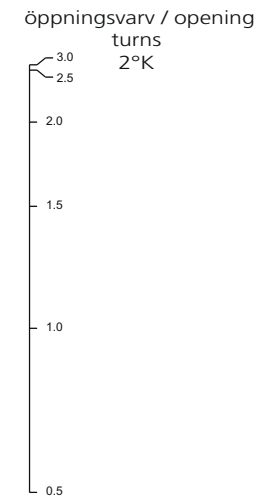

FV...e  
10/15

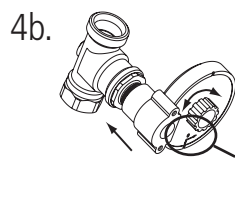
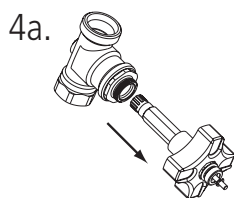

Nollställ  
Turn to zero  
Nullstellung

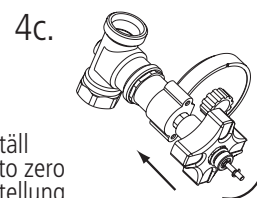

Ställ in  $K_v$   
Set  $K_v$   
Einstellung  $K_v$

Alt.1

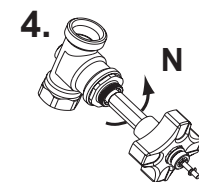
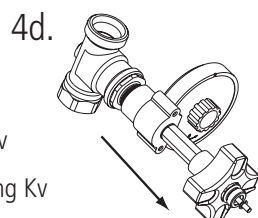

Alt. 2

