

USER GUIDE

FOOD WASTE DISPOSER

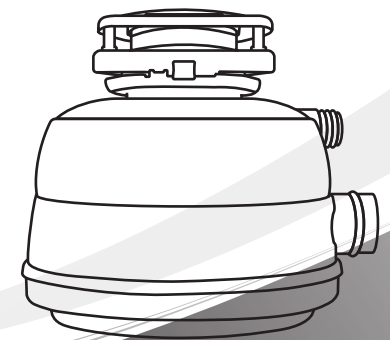

Kindly Inform



Our series of food waste disposer are designed according to national standards, and apply for the household intermittent use, not for the industrial use.

Safety Warning



Minors are not allowed to use the machine. Do not stick your finger or hand into the machine to avoid accidents. Users are not allowed to disassemble, refit or repair themselves to avoid danger. The machine power must be cut off before plugging or removing objects from the machine.

Before using this product, please note the following:

1. Read all instructions before using the appliance.
2. To reduce the risk of injury, close supervision is necessary when an appliance is used near the children.
3. Do not put your finger or hand into the food waste disposer when working.
4. Turn the power switch to the off position before attempting to clear a jam or remove an object from the disposer.
5. When attempting to remove objects from a waste disposer use long-handled tongs or pliers. If the disposer is magnetically actuated, non-magnetic tools should be used.
6. When attempting to loosen a jam in a waste disposer, use a long wooden object such as a long wooden handle of a broom or mop.
7. To reduce the risk of injury by materials that may be expelled by a waste disposer, do not put the following into a disposer:
 - a. clam or oyster shells
 - b. caustic drain cleaners or similar products
 - c. glass, china or plastic
 - d. large whole bones
 - e. metal, such as bottle caps, tin cans, aluminum foil or utensils
 - f. Whole cornhusks
8. When not operating a disposer, leave the stopper in place to reduce the risks of objects falling onto the disposer.
9. Do not operate disposer unless splash guard is in place. (Dose not apply to the Top Control/Batch Feed units.)
10. For proper grounding instructions see the electrical connection portion of this manual.

CONTENTS

1. Checking installation dimensions	01/
2. Three-bolt mounting assembly	03/
3. Fast Locker Mounting Assembly	06/
4. Air switch instruction	09/
5. Instructions for remote control switch	10/
6. Automatic water inlet installation	11/
7. Dishwasher connection	12/
8. Operating Instructions	13/
9. Trouble shooting	13/
10. Cleaning and maintenance	14/
11. Circuit diagram	14/
12. Important safety instructions	15/

1. Checking installation dimensions

(1) Checking product dimension

1. Disposer height
2. Distance from bottom of sink bowl to center line of discharge outlet. (Add 12mm when stainless steel sink is used.)
3. Distance from center line of the discharge outlet to end of discharge tube.
4. Disposal width
5. Distance from disposal vertical centre line to enter line of trap connection. To properly drain and prevent standing water in the disposal, the waste pipe entering the wall must be lower than the disposal discharge outlet.

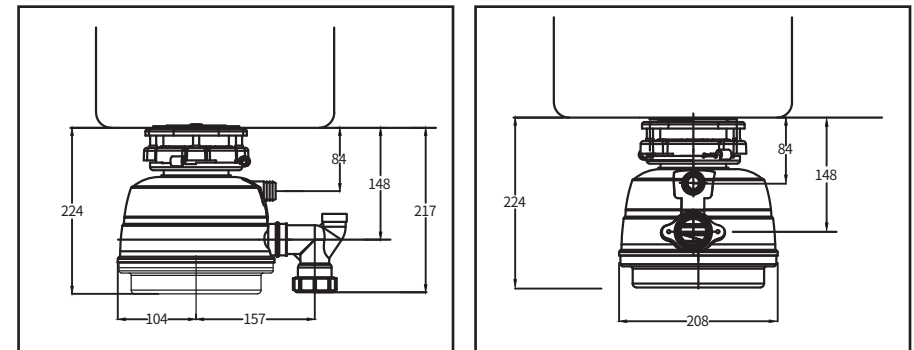

(2) Checking the dimension of sink mouth

1. The standard diameter of the sink mouth: inner diameter 90mm, outer diameter 110-114mm. In addition to the standard size, other diameters are required, Use a diameter reducer. (Size of reducer is 140, 160, 180mm) Customers need to buy by themselves. (see 1-01)
2. In case of a square sink mouth, you need to purchase additional conversion accessories (only applicable to the three-bolt mounting, see 1-02).
3. If the sink thickness is greater than 8mm and the feeding mouth cannot be installed, the sink thickness between 8-35mm, needs to be purchased separately extension accessories (only for three-bolt mounting, see 1-03).

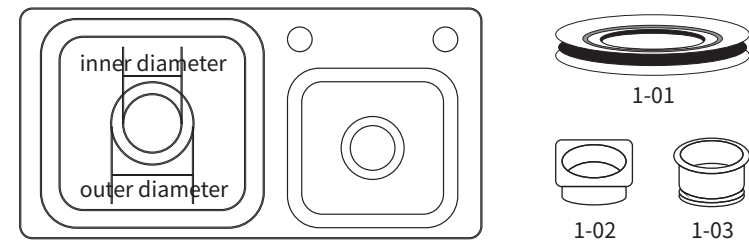

(3)Checking space dimension under sink

- 1.Processor height (about 32-37cm).
- 2.The distance from the bottom of the water tank to the center line of the sewage pipe (about 16-18cm). In order to prevent ponding in the processor, please pay attention to the water level drop.
- 3.The distance from the center line of the sewage outlet to the terminal of the sewage pipe (about 13cm).
- 4.The distance from the vertical center line of the processor to the connecting center line of the sewage pipe (about 17-18cm).
- 5.Width of the processor (about 20-25cm).

(4)Checking the size of downpipe

- 1.Diameter of external thread is about 46mm, normal installation; Diameter about 58 mm, using water pipe adapter.
2. The diameter of the overflow outlet is about 22-25mm,normal installation .

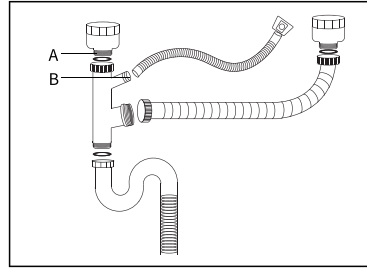

(5)Checking grounding sockets

Grounding instruction: the user must connect the machine to the reliably Grounded three-hole socket. If your power supply does not provide a grounding cable, connect the grounding cable to a reliable grounding socket separately.

(Note: Professional electrician guidance is required)

(6)Remove the downcomer and clean the downcomer

- 1.Looseen the nut on the base of the water sink.
- 2.Push the sink drainer upward through the sink hole and remove it.
3. Remove the oil stain or other debris in the water tank area.
- 4.Use the blowdown auger to clean the downpipe, otherwise it may lead to blockage of the downpipe.

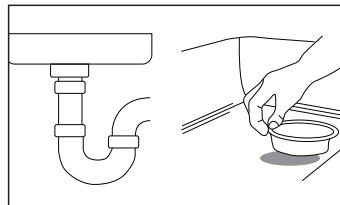

2.Three-bolt mounting assembly

(1)Parts name

(2)Installation

Food waste disposer are completely assembled and strictly tested by factory. Please follow the instruction to assemble. Please make sure you have all the required tools,material and parts before installation. You may need: Phillips & flat blade screwdriver, adjusted pipe wrench,insulation tape,safety goggle and so on.(Wearing safety glasses is recommended during the installation of disposer.)

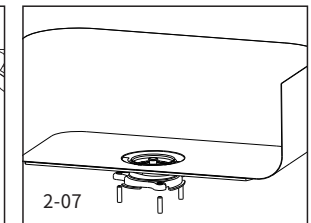
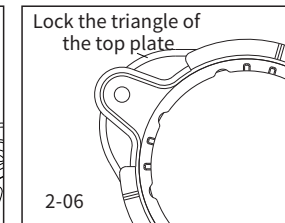
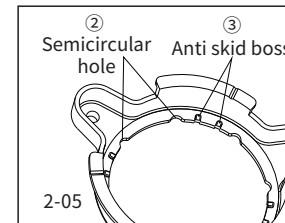
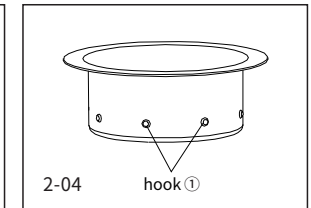
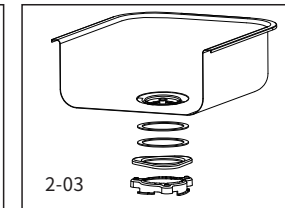
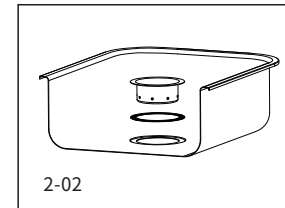
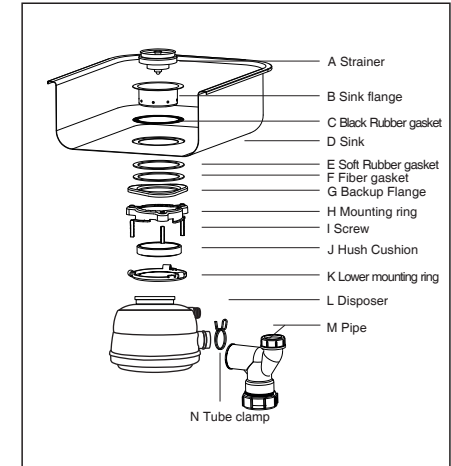

(3)Components instruction

(see 2-02)

Clean any objects around the sink hole C black rubber gasket,B sink flange,A strainer, put them from top down to the sink hole.

(see 2-03/04/05/06/07)

Black rubber washer, white soft plastic pad, lock the top plate, and the locking pressure plate is sleeved into the feeding port from bottom to top.

The hook ① on the feeding port passes through the semicircular hole ② on the locking pressure plate, and then rotate the feeding port so that the hook ① is between the two anti-skid bosses ③.

The three screws passing through the top of the locking pressure plate are pressed at the triangle of the locking top plate and tightened.

(4) Connection of processors and components

Note: to avoid personal injury, do not put your head or body under the processor, which may fall down during installation.

1. Lift the processor vertically to make the rubber damping ring contact and align with the lower edge of the feeding port.
2. Turn the link buckle horizontally to the right to make the lug ④ hang on the hanging table ⑦ at the edge of the locking pressing plate, so that the processor is hung under the water tank. (make sure that the three lugs are hung on the locking pressure plate, otherwise it will fall and leak.)
3. Insert a screwdriver into the lug ⑤, turn the link buckle inward to the right, and the locking step ⑥ on the link buckle slides over the locking step ⑧ on the locking pressure plate.

(see 2-08/09/10)

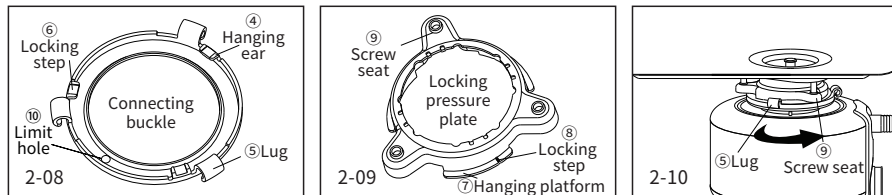

Note: the locking step must be clamped so that the lug ⑤ touches the screw seat ⑨, and the M4 wrench must be clamped back on the limit hole, otherwise there is a risk of water leakage and falling.

(5) Fixing of blowdown pipe

Connect the sewage pipe to the processor and tighten the screws with M4 Allen wrench.

(see 2-11)

Screw fixed

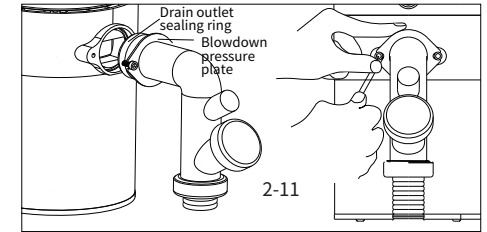

Pass the sewage pipe through the steel pipe clamp with ears and fix it in the sewage outlet rubber. Do not stretch and twist the sewage outlet rubber to avoid damage and water leakage

(see 2-12)

Steel wire flexible connection

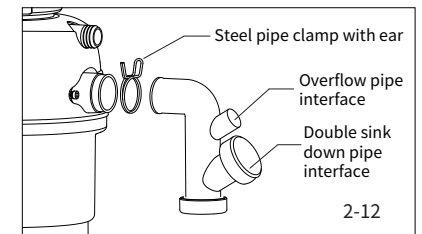

(6) Installation of downpipe

(Please refer to the special page for dishwasher connection)

Double groove downpipe connection

(see 2-13)

NOTE: Do not omit to install the waterproof gasket

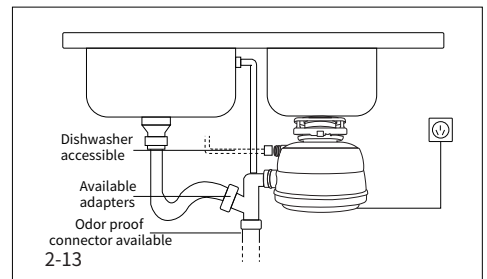

(7) Water leakage inspection

1. After installation, the double tank is filled with water and the machine is started to observe whether the pipe fittings are leaking.
2. Regularly check whether there is water seepage at the connection between the processor and the downpipe.

3.Fast Locker Mounting Assembly

Quick clip installation (type A)

(1)Component installation

1.**NOTE:** Pay close attention to the order of mount assembly parts,as they have been correctly assembled by the factory.

2.Tools and materials you may need Phillips & flat blade screwdriver, pipe wrench, insulating tape and safe glasses.(Suggest to wear the glasses during the assembly.)

3.Assembly Installation

Note: Disposer is well assembled and inspected by the factory, please disassemble and assembly it according to the below steps

- Open the fast-locker mounting ring,take down sink flange
- Screw out the sink flange nut,take down sink gasket and fiber gasket, keep the ribber gasket.
- Press sink flange with rubber gasket into the sink drain.(See 3-02)
- Insert fiber gasket,backup flange and mounting ring . Hold in place while inserting snap ring.(See 3-03)
- Tight the attached screws evenly and firmly against backup flange.(See 3-04)
- Use shorter screws of sink is more than thick.

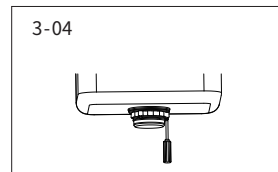
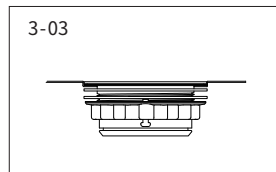
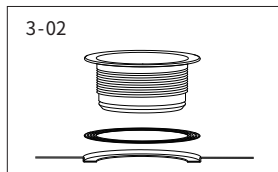
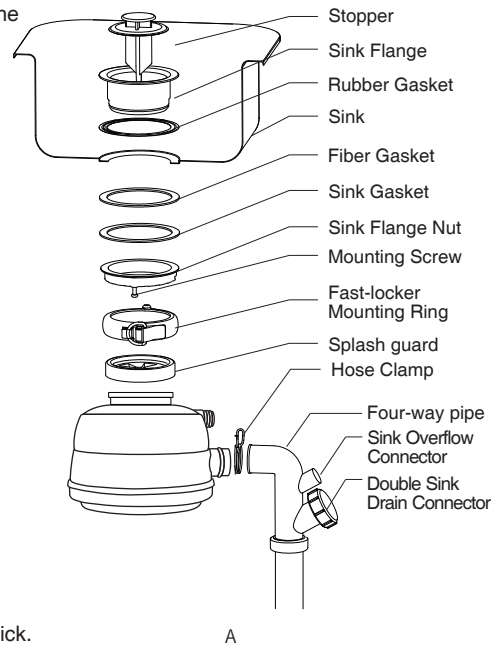

(2)Connection of processors and components

NOTE: to avoid personal injury, do not put your head or body under the processor, which may fall down during installation.

- Hold up the garbage processor with both hands, and insert the bottom end of the feeding port into the splash guard of the processor (the splash guard can be lubricated with water) until the processor does not fall down (see 3-05).
- Fix the processor firmly at the lower end of the feeding port with locking hoop, and align the sewage outlet with the drainage pipe (see 3-06, 3-07).

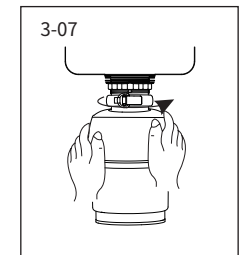
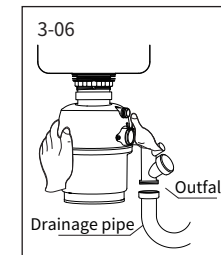
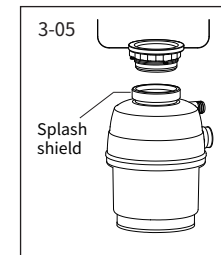

Quick clip installation (type B)

(1)Component installation

1.Name of each fitting (see B)

2.Installation steps:

- Disassemble the feeding port assembly.
- After cleaning the outfall, pass the feeding port with rubber gasket through the sink hole from top to bottom.
- Put the fiber gasket and lock nut under the water tank and tighten them until the feeding port cannot shake.

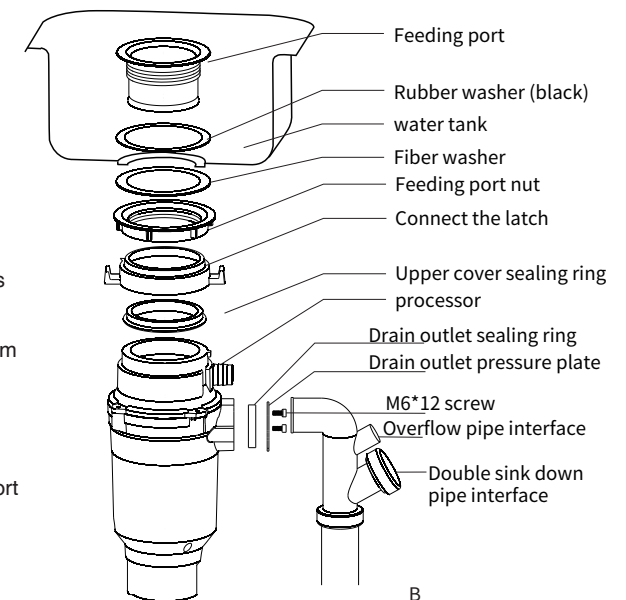

(2) Connection of processors and components

NOTE: to avoid personal injury, do not put your head or body under the processor, which may fall down during installation.

1. Set first Connect the lock catch, and then install the cover sealing ring. When installing the seal ring, it is necessary to push up the connecting latch and cover the inner groove of the seal ring (big end down) on the convex edge at the bottom of the feeding port.

2. Lift the machine so that the two suspension bumps of the machine body are completely clamped to the innermost end of the connecting latch.

NOTE1: when the seal ring is installed correctly, the flanging at the bottom of the feeding port lies in the groove inside the seal ring. If it is not installed in place, it will lead to water leakage.

NOTE2: the two suspension bumps of the fuselage must be stuck in place. If they are not installed in place, the machine will fall or leak.

(3) Fixing of blowdown pipe

Screw fixed

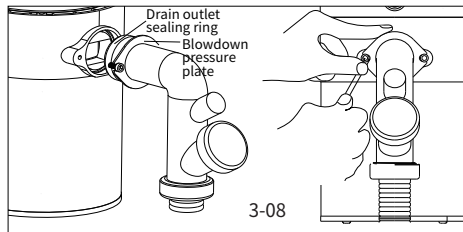

Connect the sewage pipe to the processor and tighten the screws with M4 Allen wrench. (see 3-08)

Steel wire flexible connection

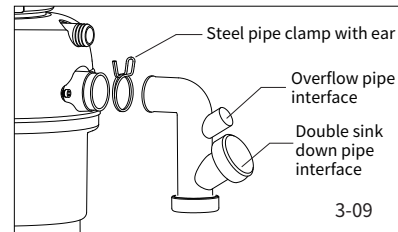

Pass the sewage pipe through the steel pipe clamp with ears and fix it in the sewage outlet rubber. Do not stretch and twist the sewage outlet rubber to avoid damage and water leakage (see 3-09)

(4) Installation of downpipe

(Please refer to the special page for dishwasher connection)

Double groove downpipe connection (see 3-10)

NOTE: Do not omit to install the waterproof gasket

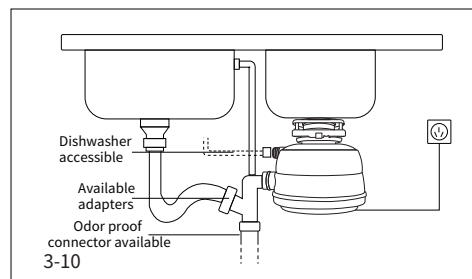

(5) Water leakage inspection

1. After installation, the double tank is filled with water and the machine is started to observe whether the pipe fittings are leaking.

2. Regularly check whether there is water seepage at the connection between the processor and the downpipe.

4. Air switch instruction

Disposer accessory includes air switch, that can control the disposer on/off.

1. Remove nut from the push button bellows, keep the sealing gasket in place. (See 4-01)

2. Put air switch with the sealing gasket through the sink or table (may need to drill a 33mm wide hole into the sink table, some sink may already have a suitable hole in them which can be exposed by removing the cap), spin the nut to firm air switch in place. (see 4-02)

3. Push one end of the PVC tubing onto the spout of the push button bellows, feed the other end of tube through the hole in the work shop and through nut underneath the work shop. (see 4-03/04)

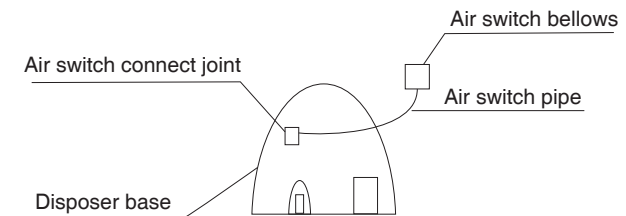
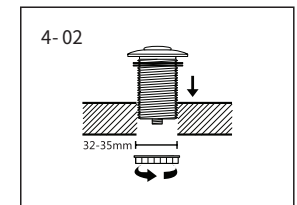
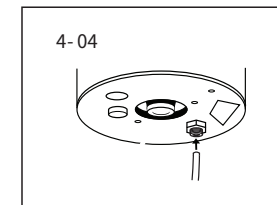
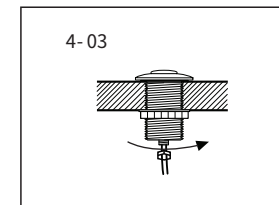
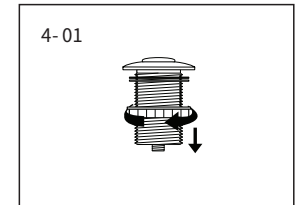

Installation: Inset air switch pipe into the air switch connect joint.

Operation: Plug in the power source of the installed food waste disposer.

To use a food waste disposal, press the air switch, and press it again to turn it off when don't use it.

5. Instructions for remote control switch

(1) Warning!

1. The installation of the remote controller must comply with local laws and regulations.
2. It is forbidden to use the remote control to turn on or off the processor outside the line of sight, so as to avoid personal injury.
3. The remote controller must be repaired by qualified personnel or returned to the factory to avoid personal injury.
4. The remote control must be installed or placed in a position that is not easy for children to reach; People with physical, sensory or mental defects or lack of experience and knowledge (including I-children) are forbidden to use.
5. The remote controller must be installed or placed away from the water flow ~ splash and the high temperature area of the gas appliance.
6. It is forbidden to wash the remote control directly with water or other liquids. Wipe it with a dry towel when it is safe.

(2) Installation of remote control

After installing the garbage processor, turn on the power supply, and fix it in a safe position with the gift of strong double-sided tape after confirming that the operation is sensitive.

(3) Troubleshooting

1. Press without any reaction:
 - a. Check whether the power supply is powered on.
 - b. Processor is in overload protection state:
Troubleshooting: press the reset switch at the bottom of the processor (if it pops up after pressing, it may take several minutes to press it again to complete the reset).
 - c. Press the following method to realign the code.
2. Insensitive to use:
 - a. Shorten the use distance of the remote control (within 3 meters)
 - b. Adjust the orientation of the remote control

► Code matching method ◀

Type A: Long press the start learning key on the plug for three seconds, and the indicator light flashes. Press the remote control once to confirm it.

Type B: Unplug the power cord and plug it in again. Within 1 second, press it continuously for 3 times and pause for 2 seconds. If the motor rotates, press the fourth time to confirm (if it does not pause, it may not match)

6. Automatic water inlet installation

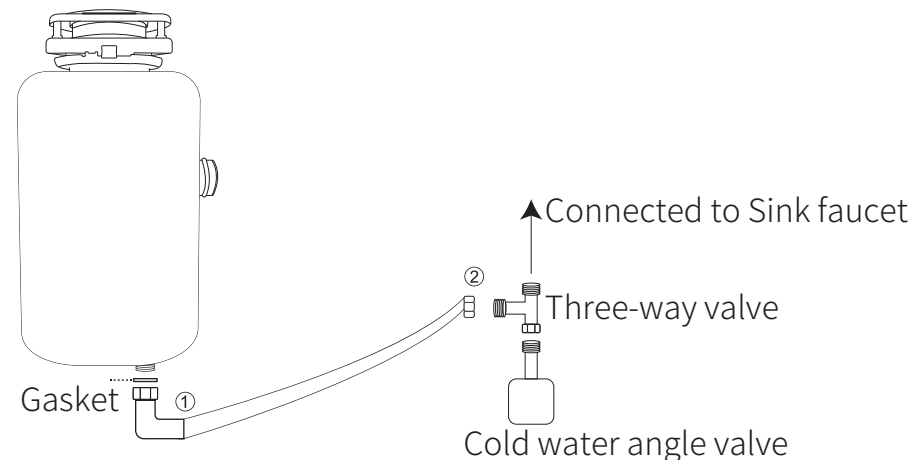

1. Connect the three-way valve to the cold water Angle valve.
2. Connect any end of the stainless steel braided hose ① to the machine inlet, and connect the other end ② to the three-way valve.
3. After installation, be sure to check whether there is water Leakage when the water valve opened. If there is water leakage, check the washer and raw material tape and then reinstall it.
4. The water flow should be less than 4L/min when using this machine.

► Induction shutdown function test ◀

This machine is equipped with an inductive shutdown function. In view of the different water pressures in different places, the following steps should be followed during initial installation:

Test the machine for 1 minute after installation,

If induction shutdown fails to close, turn down the valve by half and run it again for one minute,

If it still cannot be shut down by induction, please reduce it by half on the basis of the existing valve,

Run it again for one minute until it can sense the shutdown.

7. Dishwasher connection

NOTE: if you do not intend to connect the dishwasher to the processor, please skip to the next step.

1. The desk dishwasher can be connected to the processor.
2. The embedded dishwasher can be connected to the downpipe separately.
3. The garbage in the dishwasher basket can be poured into the processor for treatment.

4. Hammer the outer edge of the water inlet plug with the tip of the screwdriver until the plug is loose and remove the debris falling into the processor in time. Once the plug is removed, it cannot be restored, and it can be blocked with a 15-20mm conical rubber plug in the later stage. (see 6-01)

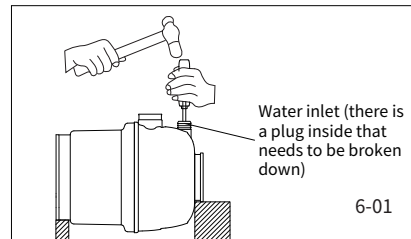

5. Dishwasher with direct hose drainage: connect the hose to the water inlet. If the size of hose connector is different, you can buy another rubber connector. Note: if the residue backflow is caused by the water level drop, a check valve can be installed at the water inlet. (see 6-02)

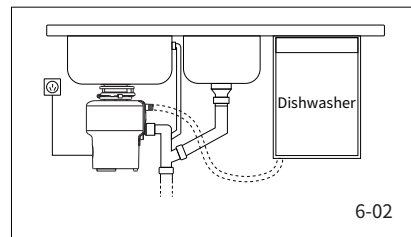

6. Dishwasher with hard pipe assembly drainage:

- a. Remove the hard pipe assembly and connect it to the sewage pipe after using the original nut of the dishwasher and the new drain hose.
- b. A complete set of specially equipped processor pipe fittings can be purchased for replacement. (see 6-03)

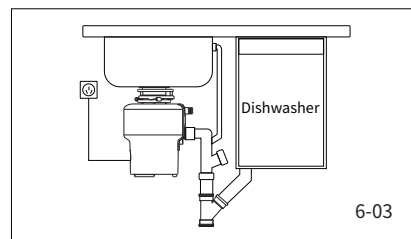

8. Operating Instructions

This product uses an anti blocking rotating cutter head, which may produce a "click" sound when starting, which is a normal phenomenon.

1. Take out the sink plug and turn on the cold water tap to make the water flow moderate.
2. Start the processor and pour in food waste. To keep the food waste processor working efficiently, please cut large bones, melon skins, corn cobs, etc. into small pieces and put them into the processor, but these things may prolong the working time of the processor. When the processor smashes food, the speed may slow down, which is a normal phenomenon, because the processor is adjusting the torque by itself (crushing function).
3. Before turning off the processor, make the water and the processor work for another 5 seconds or so, so as to ensure that all dirt is washed away by water.
4. We do not recommend that you use hot water when the processor is working. Cold water can ensure that food waste and grease are solid and washed away.

9. Trouble shooting

1. Loud Noise:

(Other than those during grinding of small bones and fruits pits): These are usually caused by accidental entry of a spoon, bottle cap or other foreign object. To correct this, turn off electrical switch and water. After disposer has stopped, remove splash guard, remove object with long handled tongs, and replace splash guard.

2. Unit dose not start:

- a. Unplug power cord or turn either the wall switch or breaker box switch to "off" position, depending on your model and wiring configuration. Remove stopper and/or splash guard. Check whether the turntable rotate freely by using the tool. (see 8-02). If it is jammed, need to disconnect the power supply, remove the visible objects from disposer, or use the sleeve to add force to rotate turntable. (Turn counterclockwise to avoid dropping the disposer)
- b. If the rotation is free, check whether the reset button of the machine is disengaged, and press the reset button. (If the reset button is repeatedly disengaged, wait for one minute before press. (see 8-03)
- c. If reset button has not disengaged, check for shorted or broken wire connecting to disposer. Checking electrical power switch, fuse box or circuit breaker. If wiring and electrical components are intact, the unit may have internal problems that require service or replacement.

3.If the above steps are still not working properly, please contact our dealer in time, do not disassemble by yourself, otherwise it will not be guaranteed.If the power cord is damaged, in order to avoid danger, it must be replaced by the company's authorized maintenance personnel or professional household appliance maintenance personnel.

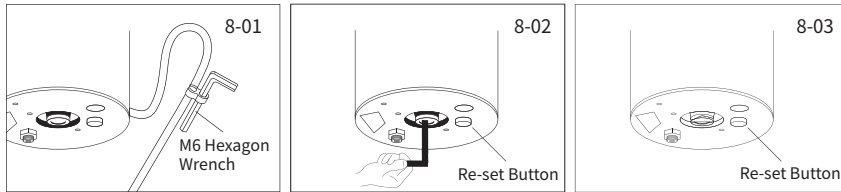

10. Cleaning and maintenance

The motor is permanently lubricated. The disposer is self cleaning and scours its internal parts with each use. Never put lye or chemical drain cleaners into the disposer, as they cause serious corrosion of metal parts. If used, resulting damage can be easily detected and all warranties are void.

Mineral deposits from your water can form on stainless steel turntable, giving the appearance of rust. Do not be alarmed, the stainless turntables used will not corrode.

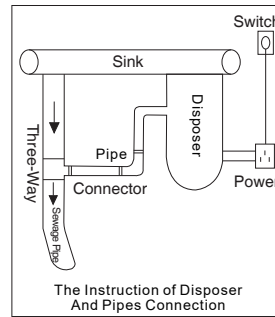

11. Circuit diagram

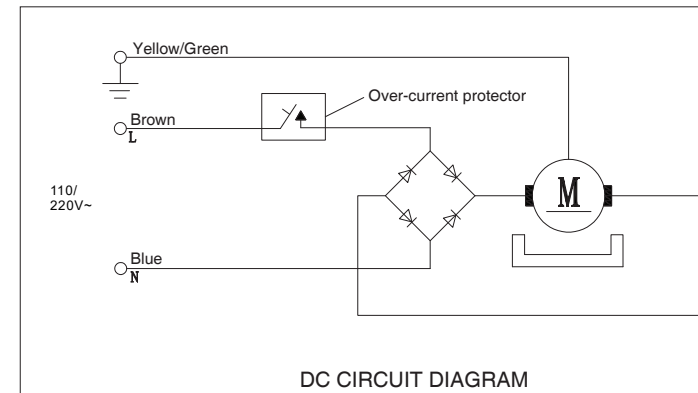
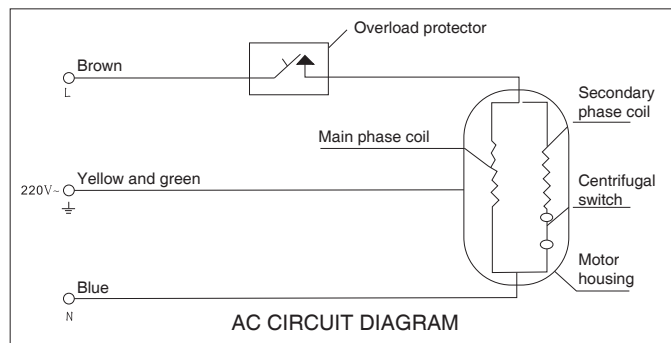

12. Important safety instructions

Danger: To avoid electrical shock, disconnect power before installation or servicing disposal.

- 1.If you are not familiar with the electrical power and procedures, call a qualified electrician.
- 2.Do not modify the plug provided with the appliance if it will not fit the outlet, have a proper outlet installed by a qualified electrician.
- 3.If three-prong, earth(grounded) plug is used, plug must be inserted into three-hole earth receptacle.
- 4.Improper connection of equipment earth conductor can result in electrical shock.
- 5.All wiring must comply with local electrical code.
- 6.Do not attach earth wire to gas supply pipe
- 7.Do not reconnect electrical current at main service panel until proper earth outlets are installed.
- 8.If the supply cord is damaged, it must be replaced by the manufacturer, its service agent or similarly qualified person in order to avoid a hazard.

NOTE:

- 1.To avoid the blockage of drainage system, please make sure there are no objects in the chamber before starting the disposer.
- 2.When not operating a disposer, leave the stopper in place to reduce the risk of objects falling onto the disposer.

- 3.To reduce the risk of injury by materials that may be expelled by a waste disposer, do not put the following into a disposer: clam or oyster shells;caustic drain cleaners or similar products;glass,china or plastic;large whole bones;metal,such as bottle caps, tin cans,aluminum foil or utensils;hot grease or other hot liquids;whole cornhusks.
- 4.Use a processor before and after meals!Turn on the processor and cold water when preparing the meal, and clean up the vegetables and leaves in the pool. After the meal, food waste can be put directly into the processor.
- 5.To ensure the efficiency of a disposer, cut up large pieces of food waste then dispose them.
- 6.Water flow should be no less than 4 l/min.
- 7.This processor is designed according to the national standard, it is discontinuous use type, each processing time should not be more than 6 minutes (generally normal processing only needs 1-2 minutes), to avoid damage to the motor.

Warning:When using electronic appliances,basic precautions are always to be followed,including:

- 1.If the air switch or wall switch fails to shut off or turn on disposal,unplug power cord plug and contact your qualified trade person.
- 2.This product is designed to dispose normal household food waste. Putting materials except food waste into disposer could cause personal injury or proper damage.
- 3.This appliance is not designed for use by persons who are physically, feel or mentally handicapped or lack of experience and knowledge, including children. Unless they are monitored and known about the use of equipment by the person responsible for their safety.Children should be monitored to ensure they do not play with the disposer. In order to reduce the risk of injury, close supervision must be given when the equipment is used near children.
- 4.Do not put fingers or hands into the disposer.
- 5.Fire risk: do not put combustible materials near the disposer,such as cloth, paper or aerosol cans. Do not store below things near the processor: gasoline, other flammable gases or liquids.
- 6.Do not dispose of the following in the disposal : painting oil,solvents,household cleaners, chemicals,automotive fluids,plastic wrap.
- 7.Disposer is designed according to the country standards insteading intermittent type. Every time the working time should not be over 6 minutes(normaly only need 1-2minutes),to avoid breaking the motor.

Warranty Card

Series No _____ Year _____ Month _____ Date _____

Customer name _____ Tel _____
 Add _____
 Distributor _____ Tel _____
 Sales Add _____
 Price _____ Purchase No _____
 Model _____

Distributor Chapter	Customer sign		
	Service man	Warranty Time	Maintenance

Series No _____

Date: _____
 Customer: _____
 Tel: _____
 Add: _____
 Purchase No. _____
 Model: _____

Copy is not admitted, please keep well The secondary card is kept by distributor



Warranty Card

After-sales Service Promise:

Warranty	
AC Disposer: Three years	DC Disposer: Two years

Thank you for your purchase. In order to guarantee your rights and interests, please ask the sales man to write the purchase date, serial number, and stamp the chapter, to ensure your rights, the free service within the warranty period of our company.

Warranty Instruction

1. The malfunction or breakdown caused by incorrect assembly, using or maintenance that not according to this instruction.
2. Extended warranty time or scope.
3. Tamper or tear up the product bar code.
4. Modify or repair it without our permission
5. Accidental factors or behaviors may lead to product damage, such as inappropriate voltage, high temperature, mechanical damage, falling, etc.
6. the breakdown caused by transportation When customer sent back the disposer.
7. Irresistible factors such as earthquake, fire, flood, lightning, etc
8. Defects not caused by product design, manufacturing or quality problems.

Date		
Maintenance		
Result		
Engineer		
Service man	Time	Reason

Maintenance Card

Model _____

Date _____

No. _____

Standard _____