



Oras

Installation and maintenance guide



4-16



17-19



20-21

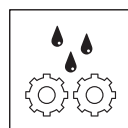

22-26



27



Accepterad
monteringsanvisning
2026:1



1598 KIWA Sverige 1913



SV: Om blandaren är monterad så att handduschen når vattenspegeln på WC/ bidé ska utloppet på blandaren kompletteras med en extra backventil Oras 105311. Detta för att uppfylla kraven gällande återströmning enligt SäVa § 5:3



7460, 7460-107, 7460C, 7460K-106

I (ISO 3822) Oras lab.

EN 1111

100 - 1000 kPa

7460, 7460C:

0.19 l/s (Eco)

0.27 l/s (300 kPa)

165 kPa (0.2 l/s)

7460-107:

0.13 l/s (300 kPa w/Controller)

7460K-106:

0.10 l/s (300 kPa w/Controller)

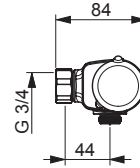
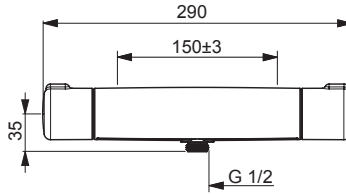

mpi.oras.com/7460

max. +80°C

7460-33, 7460C-33

I (ISO 3822) Oras lab.

EN 1111

100 - 1000 kPa

0.19 l/s (Eco)

0.27 l/s (300 kPa)

165 kPa (0.2 l/s)

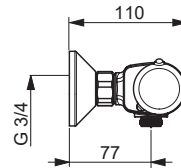
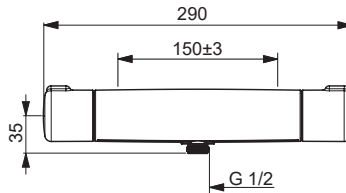

mpi.oras.com/7460-33

max. +80°C

7460GL

I (ISO 3822) Oras lab.

EN 1111

100 - 1000 kPa

0.10 l/s (Eco)

0.20 l/s (300 kPa)

300 kPa (0.2 l/s)

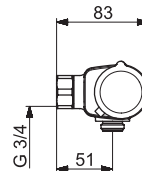
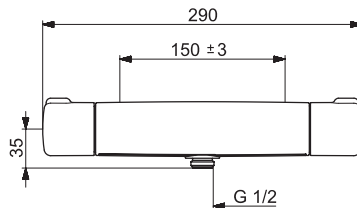

mpi.oras.com/7460GL

max. +80°C

7460U, 7460U-33

I (ISO 3822) Oras lab.
EN 1111
100 - 1000 kPa
0.19 l/s (Eco)
0.27 l/s (300 kPa)
165 kPa (0.2 l/s)

max. +80°C

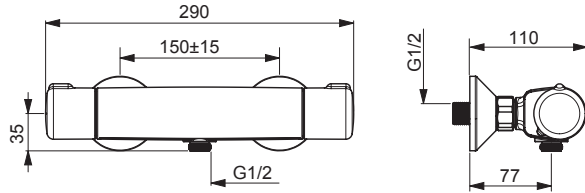

mpi.oras.com/7460U

7460X

I (ISO 3822) Oras lab.
EN 1111
100 - 1000 kPa
0.19 l/s (Eco)
165 kPa (0.2 l/s)

max. +80°C

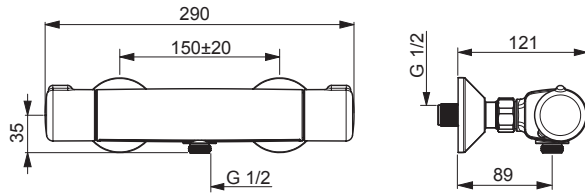

mpi.oras.com/7460X

7461

I (ISO 3822) Oras lab.
EN 1111
100 - 1000 kPa
0.19 l/s (Eco)
0.28 l/s (300 kPa)
165 kPa (0.2 l/s)

max. +80°C

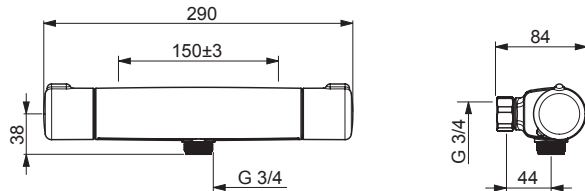

mpi.oras.com/7461



7462, 7462G, 7462L

I (ISO 3822)

EN 1111

100 - 1000 kPa

7462, 7462L:

0.16 l/s (Eco)

0.33 l/s (300 kPa)

230 kPa (0.2 l/s)

300 kPa (0.3 l/s)

7462G:

0.23 l/s (300 kPa)

230 kPa (0.2 l/s)

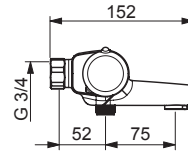
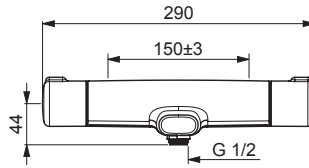

mpi.oras.com/7462

max. +80°C

7462G-33

I (ISO 3822)

EN 1111

100 - 1000 kPa

0.16 l/s (Eco)

0.23 l/s (300 kPa)

230 kPa (0.2 l/s)

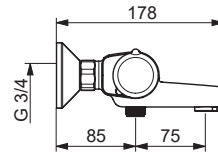
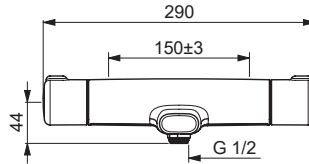

mpi.oras.com/7462G-33

max. +80°C

7462U, 7462U-33

I (ISO 3822) Oras lab.

EN 1111

100 - 1000 kPa

0.16 l/s (Eco)

0.33 l/s (300 kPa)

230 kPa (0.2 l/s)

300 kPa (0.3 l/s)

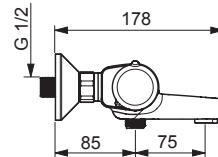
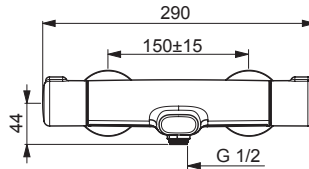

mpi.oras.com/7462U

max. +80°C

7464, 7464-33

I (ISO 3822) Oras lab.
EN 1111
100 - 1000 kPa
0.19 l/s (Eco)
0.27 l/s (300 kPa)
165 kPa (0.2 l/s)

max. +80°C

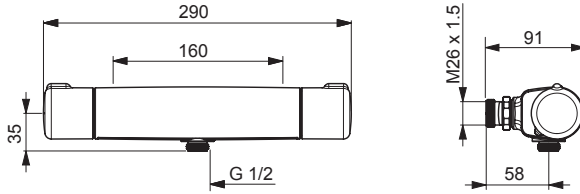

mpi.oras.com/7464

7464GL

I (ISO 3822) Oras lab.
EN 1111
100 - 1000 kPa
0.10 l/s (Eco)
165 kPa (0.2 l/s)

max. +80°C

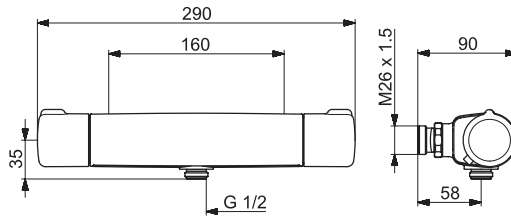

mpi.oras.com/7464GL

7466

I (ISO 3822) Oras lab.
EN 1111
100 - 1000 kPa
0.18 l/s (Eco)
0.26 l/s (300 kPa)
180 kPa (0.2 l/s)

max. +80°C

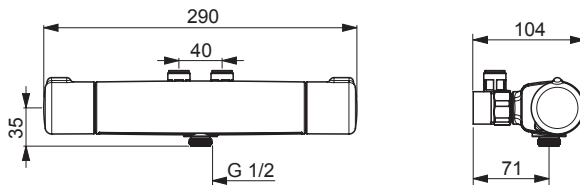

mpi.oras.com/7466



7469

EN 1111

100 - 1000 kPa

0.27 l/s (300 kPa)

165 kPa (0.2 l/s)

max. +80°C

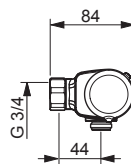
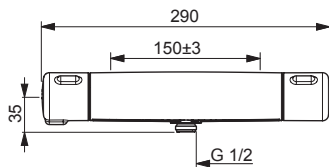

mpi.oras.com/7469

7470X

I (ISO 3822) Oras lab.

EN 1111

100 - 1000 kPa

0.19 l/s (Eco)

0.27 l/s (300 kPa)

165 kPa (0.2 l/s)

max. +80°C

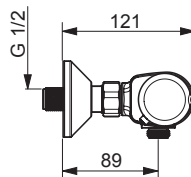
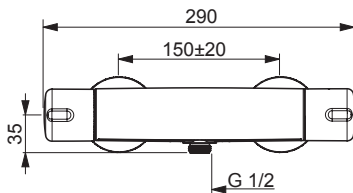

mpi.oras.com/7470X

7470U

I (ISO 3822) Oras lab.

EN 1111

100 - 1000 kPa

0.19 l/s (Eco)

0.27 l/s (300 kPa)

165 kPa (0.2 l/s)

max. +80°C

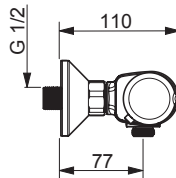
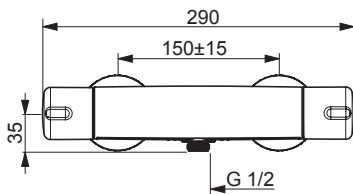

mpi.oras.com/7470U

7471

I (ISO 3822) Oras lab.
EN 1111
100 - 1000 kPa
0.19 l/s (Eco)
0.27 l/s (300 kPa)
165 kPa (0.2 l/s)

max. +80°C

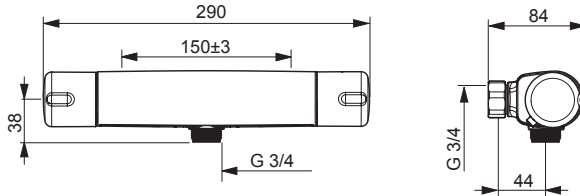

mpi.oras.com/7471

7420

I (ISO 3822) Oras lab.
EN 1111
100 - 1000 kPa
0.15 l/s (300 kPa w/Controller)
150 kPa (0.2 l/s)

max. +80°C

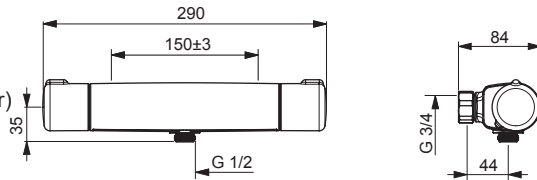

mpi.oras.com/7420

7442U

I (ISO 3822) Oras lab.
EN 1111
100 - 1000 kPa
0.18 l/s (Eco)
0.30 l/s (300 kPa)
180 kPa (0.2 l/s)
300 kPa (0.3 l/s)

max. +80°C

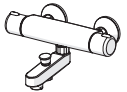
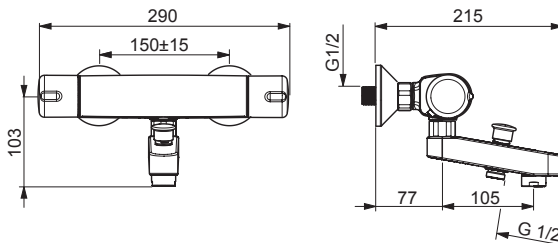

mpi.oras.com/7442U



7443, 7443-33, 7443L

II (ISO 3822) Oras lab.

EN 1111

100 - 1000 kPa

0.16 l/s (Eco)

0.33 l/s (300 kPa)

230 kPa (0.2 l/s)

300 kPa (0.3 l/s)

max. +80°C

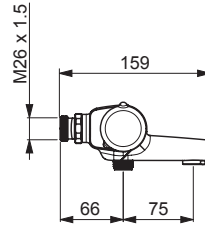
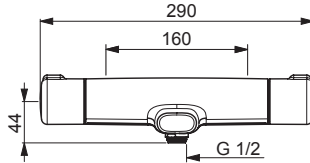

mpi.oras.com/7443

7445

II (ISO 3822) Oras lab.

EN 1111

100 - 1000 kPa

0.15 l/s (Eco)

0.3 l/s (300 kPa)

250 kPa (0.2 l/s)

300 kPa (0.3 l/s)

max. +80°C

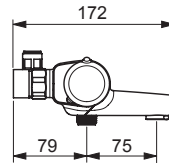
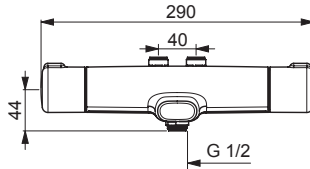

mpi.oras.com/7445

7446X

I (ISO 3822) Oras lab.

EN 1111

100 - 1000 kPa

0.16 l/s (Eco)

0.23 l/s (300 kPa)

230 kPa (0.2 l/s)

max. +80°C

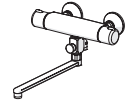
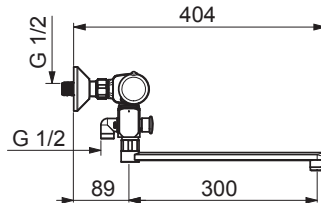
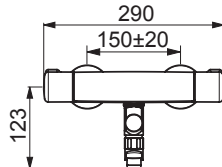

mpi.oras.com/7446X

7447X

I (ISO 3822) Oras lab.
 EN 1111
 100 - 1000 kPa
 0.16 l/s (Eco)
 0.23 l/s (300 kPa)
 230 kPa (0.2 l/s)

max. +80°C

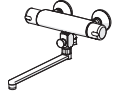
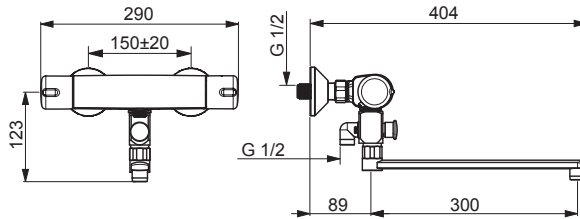

mpi.oras.com/7447X

7484

I (ISO 3822) Oras lab.
 EN 1111, EN 1113
 100 - 1000 kPa
 0.18 l/s (Eco)
 0.26 l/s (300 kPa)
 180 kPa (0.2 l/s)

max. +65°C

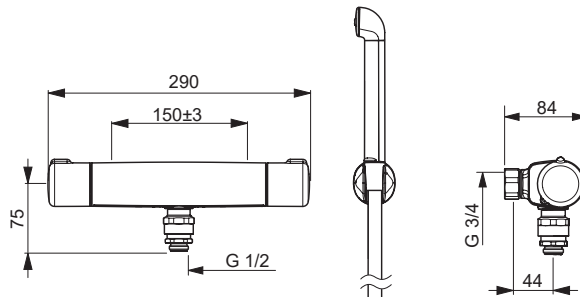

mpi.oras.com/7484

7412 (7460+530), 7412G, 7412G-33, 7412GL

I (ISO 3822) Oras lab.
 EN 1111, EN 1112, EN 1113
 100 - 1000 kPa
7412:
 0.12 l/s (300 kPa w/Controller)
 200 kPa (0.2 l/s)
7412G:, 7412G-33, 7412GL:
 0.12 l/s (Eco)
 200 kPa (0.2 l/s)

max. +65°C

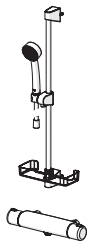
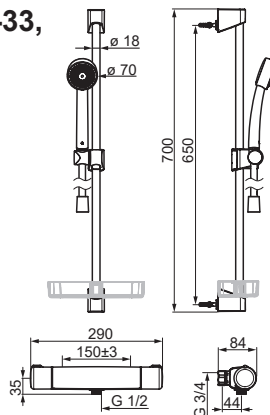

mpi.oras.com/7412



7413 (7460+544)

I (ISO 3822) Oras lab.
 EN 1111, EN 1112, EN 1113
 100 - 1000 kPa
 0.16 l/s (Eco)
 0.24 l/s (300 kPa)
 210 kPa (0.2 l/s)

max. +65°C

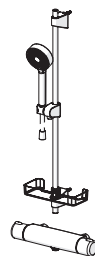
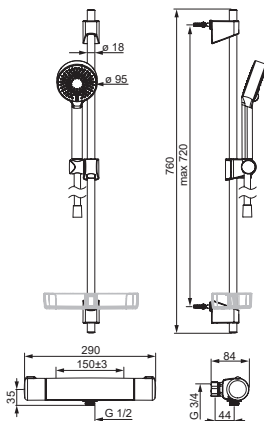

mpi.oras.com/7413

7413U (7460U+544)

I (ISO 3822) Oras lab.
 EN 1111, EN 1112, EN 1113
 100 - 1000 kPa
 0.16 l/s (Eco)
 0.24 l/s (300 kPa)
 210 kPa (0.2 l/s)

max. +65°C

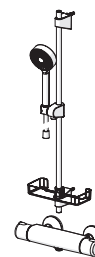
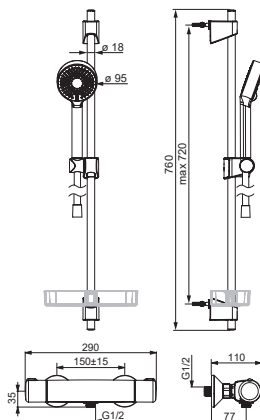

mpi.oras.com/7413U

7414U (7462U+544)

I (ISO 3822) Oras lab.
 EN 1111, EN 1112, EN 1113
 100 - 1000 kPa
 0.14 l/s (Eco)
 0.33 l/s (300 kPa)
 300 kPa (0.3 l/s)

max. +65°C

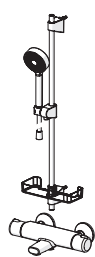
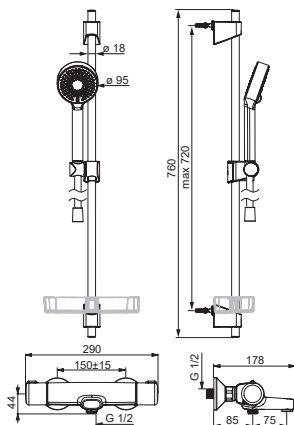

mpi.oras.com/7414U

7422 (7464+530), 7422G, 7422G-33, 7422GL

I (ISO 3822) Oras lab.
EN 1111, EN 1112, EN 1113
100 - 1000 kPa

7412:

0.12 l/s (300 kPa w/Controller)
200 kPa (0.2 l/s)

7422G, 7422G-33, 7422GL:

0.12 l/s (Eco)
200 kPa (0.2 l/s)

max. +65°C

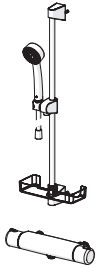
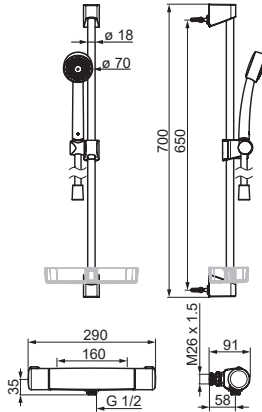

mpi.oras.com/7422

7424 (7466+520)

I (ISO 3822) Oras lab.
EN 1111, EN 1112, EN 1113

100 - 1000 kPa
0.19 l/s (Eco)
0.27 l/s (300 kPa)
160 kPa (0.2 l/s)

max. +65°C

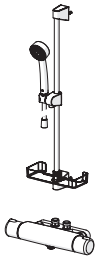
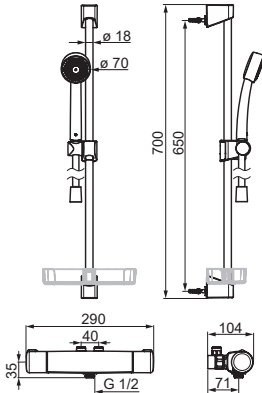

mpi.oras.com/7424

7425 (7460+520), 7425CK

I (ISO 3822) Oras lab.
EN 1111, EN 1112, EN 1113
100 - 1000 kPa

7425:

0.20 l/s (Eco)
0.28 l/s (300 kPa)
155 kPa (0.2 l/s)

7425CK:

0.19 l/s (Eco)
0.27 l/s (300 kPa)
165 kPa (0.2 l/s)

max. +65°C

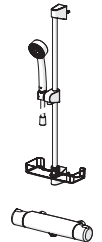
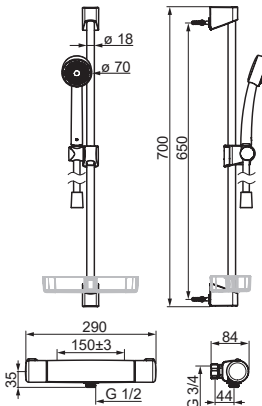

mpi.oras.com/7425



7427 (7464+520)

I (ISO 3822) Oras lab.
 EN 1111, EN 1112, EN 1113
 100 - 1000 kPa
 0.2 l/s (Eco)
 0.28 l/s (300 kPa)
 155 kPa (0.2 l/s)

max. +65°C

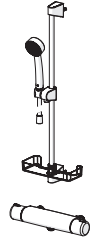
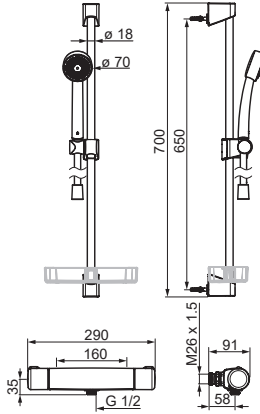

mpi.oras.com/7427

7432 (7466+530), 7432G

I (ISO 3822) Oras lab.
 EN 1111, EN 1112, EN 1113
 100 - 1000 kPa
7432:
 0.12 l/s (300 kPa w/Controller)
 200 kPa (0.2 l/s)
7432G:
 0.12 l/s (Eco)
 200 kPa (0.2 l/s)

max. +65°C

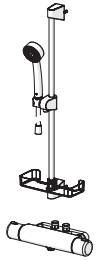
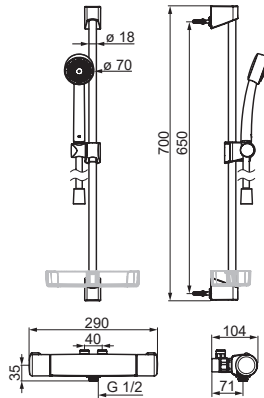

mpi.oras.com/7432

7448 (7462G+261031+520)

I (ISO 3822) Oras lab.
 EN 1111, EN 1112, EN 1113
 100 - 1000 kPa
 0.17 l/s (Eco)
 0.24 l/s (300 kPa)
 220 kPa (0.2 l/s)

max. +65°C

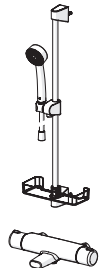
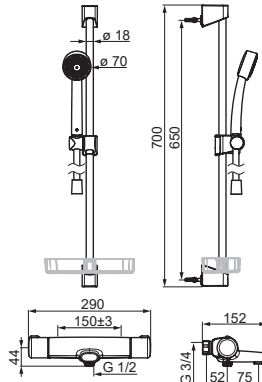

mpi.oras.com/7448

7452U (7460U+530)

I (ISO 3822) Oras lab.
 EN 1111, EN 1112, EN 1113
 100 - 1000 kPa
 0.12 l/s (300 kPa w/Controller)

max. +65°C

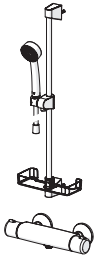
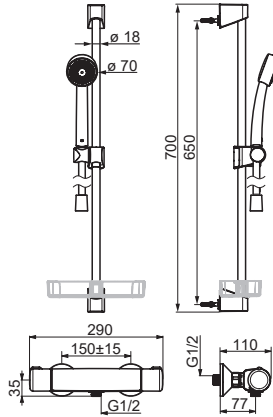

mpi.oras.com/7452U

7453 (7462G+544)

I (ISO 3822) Oras lab.
 EN 1111, EN 1112, EN 1113
 100 - 1000 kPa
 0.17 l/s (Eco)
 0.26 l/s (300 kPa)
 200 kPa (0.2 l/s)

max. +65°C

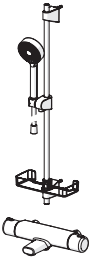
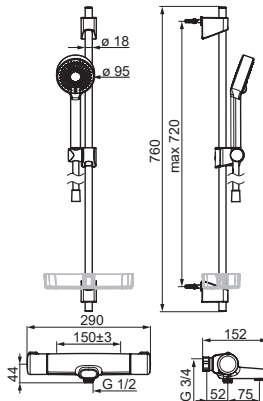

mpi.oras.com/7453

7455 (7461+261033+544)

I (ISO 3822) Oras lab.
 EN 1111, EN 1112, EN 1113
 100 - 1000 kPa
 0.2 l/s (Eco)
 0.28 l/s (300 kPa)
 160 kPa (0.2 l/s)

max. +65°C

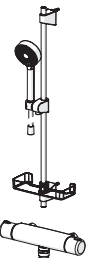
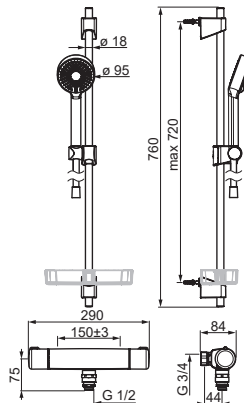

mpi.oras.com/7455



7495 (7461+261033+520)

I (ISO 3822) Oras lab.
EN 1111, EN 1112, EN 1113
100 - 1000 kPa
0.2 l/s (Eco)
0.28 l/s (300 kPa)
155 kPa (0.2 l/s)

max. +65°C

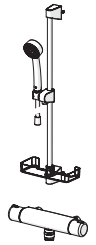
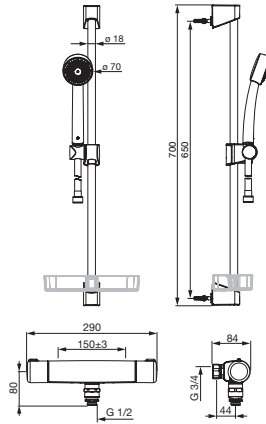

mpi.oras.com/7495

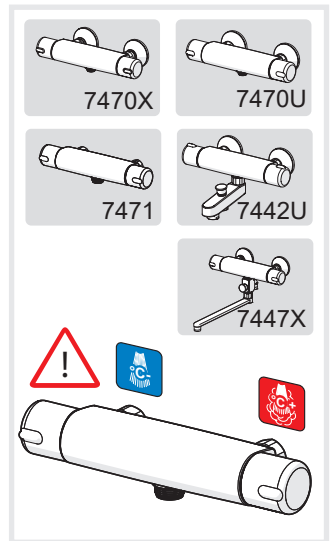
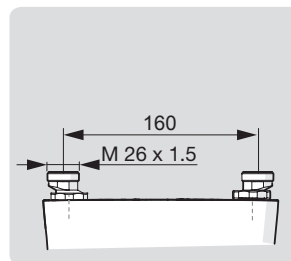
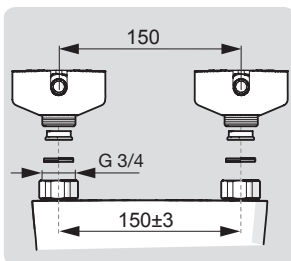
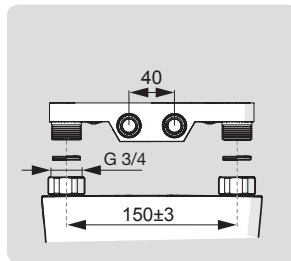
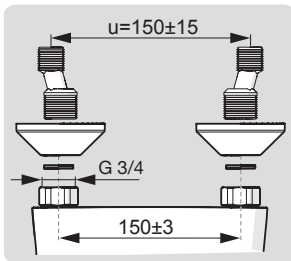
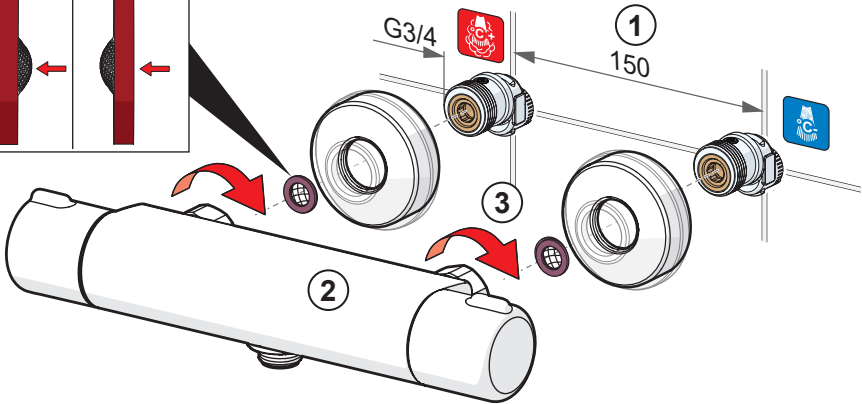
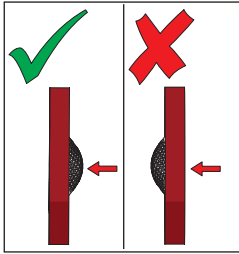
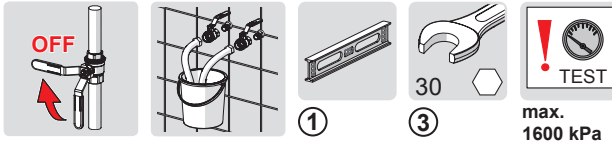

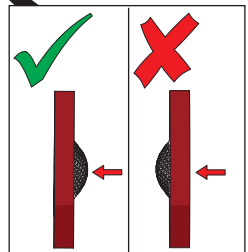
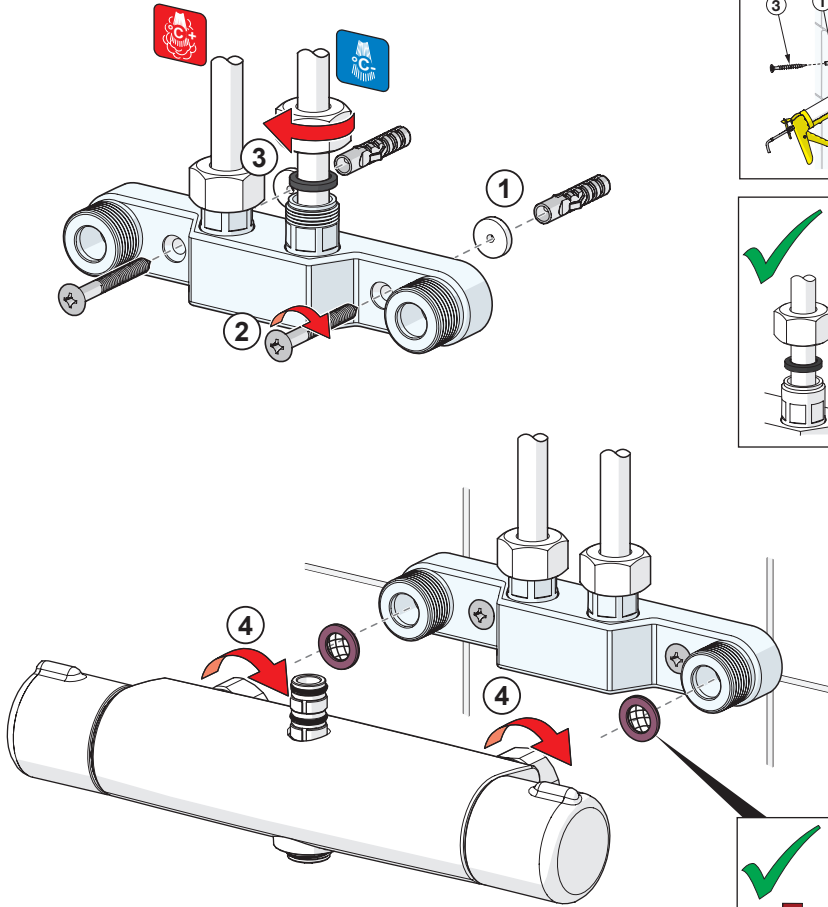
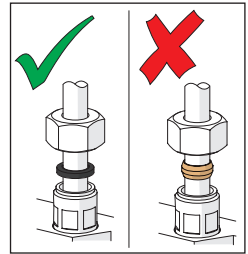
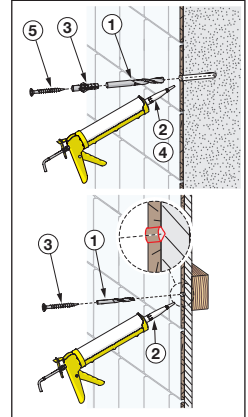
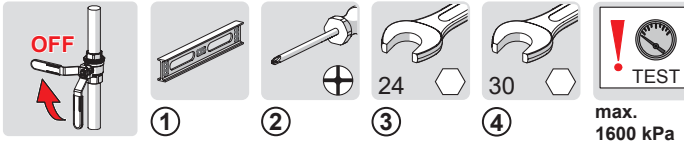

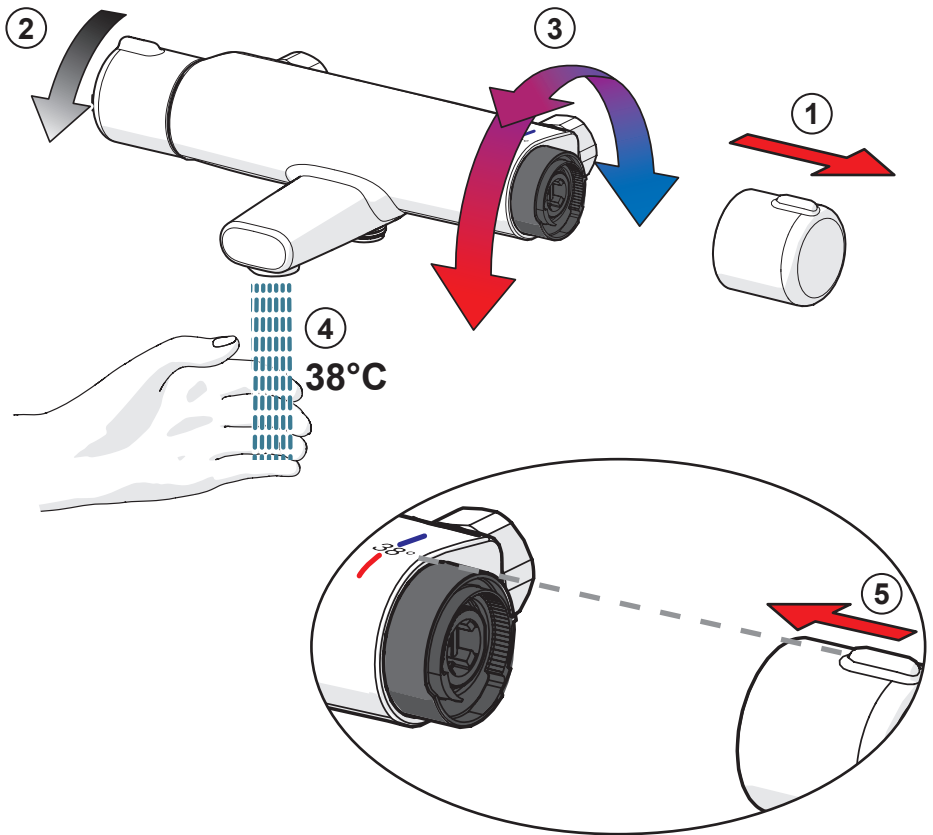

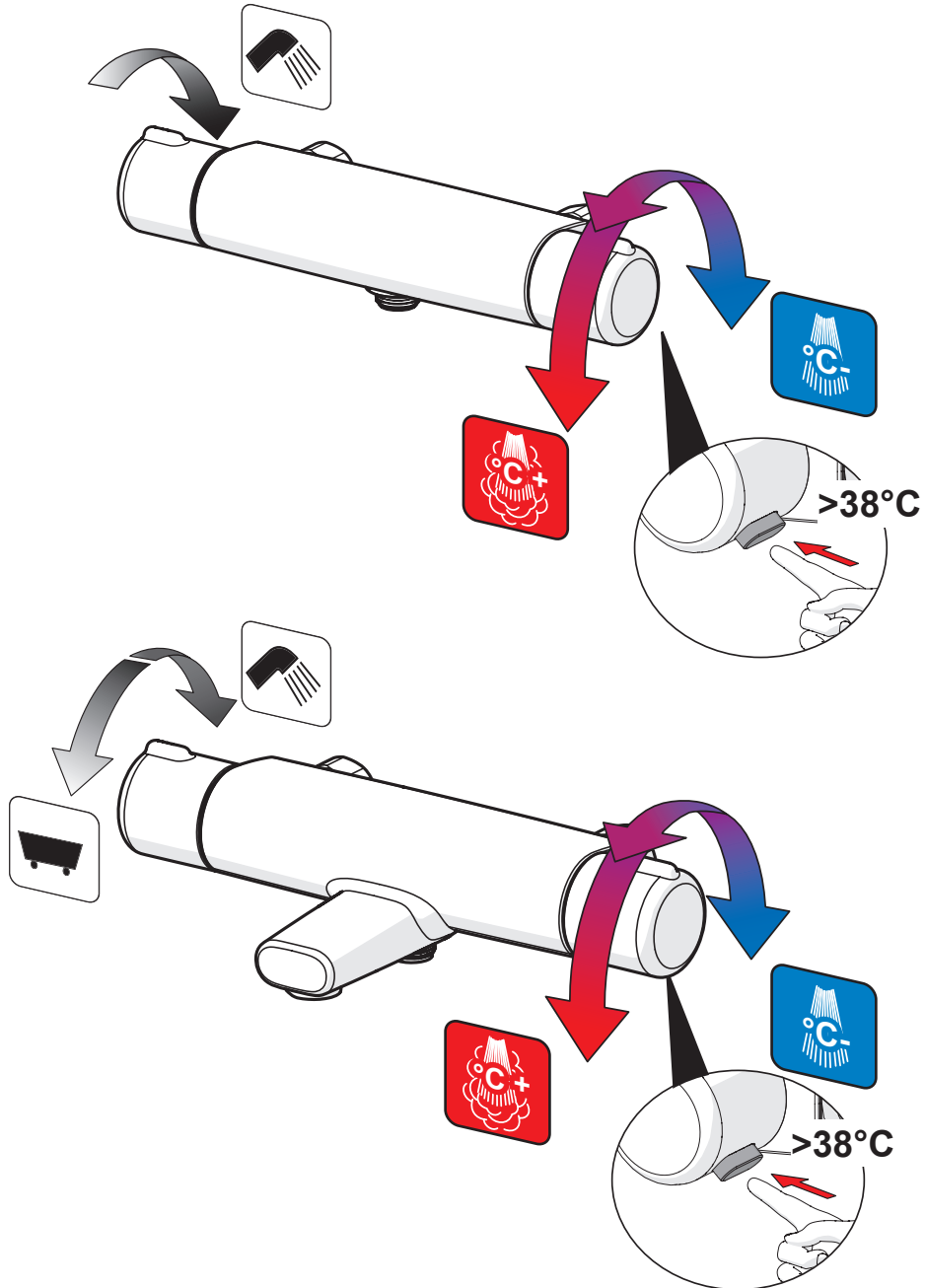

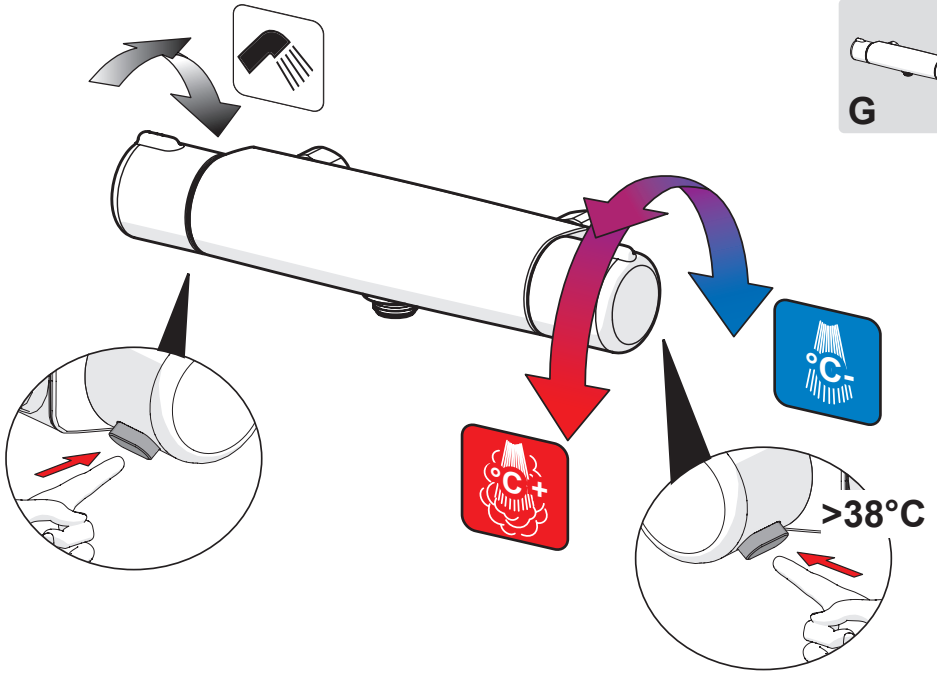

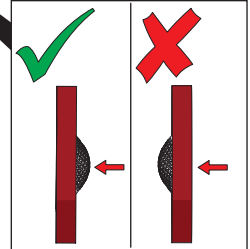
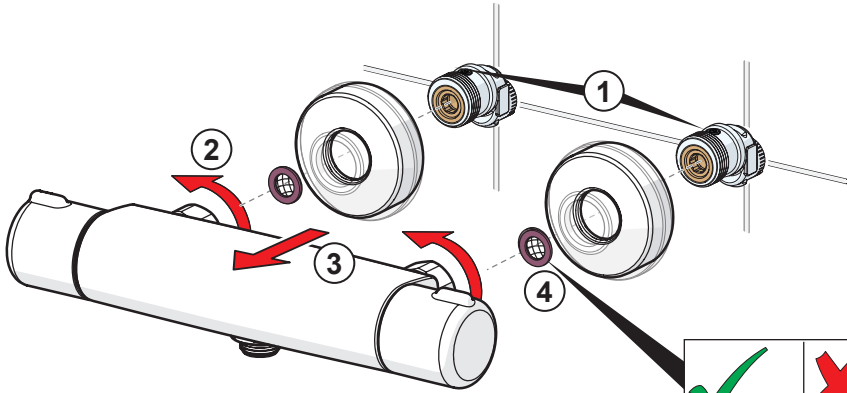
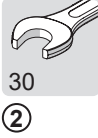
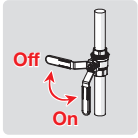
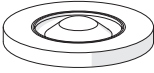

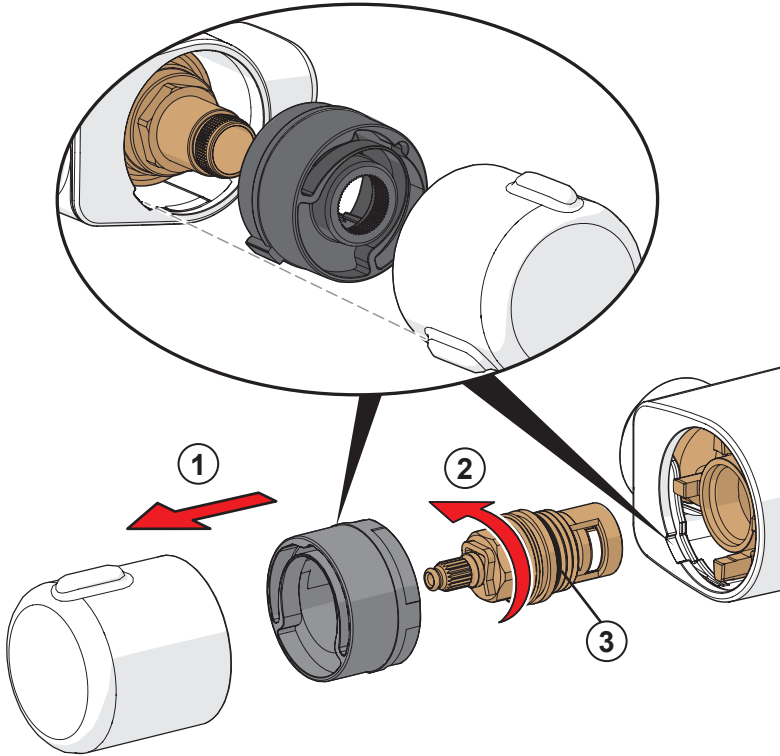
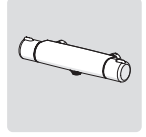
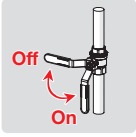

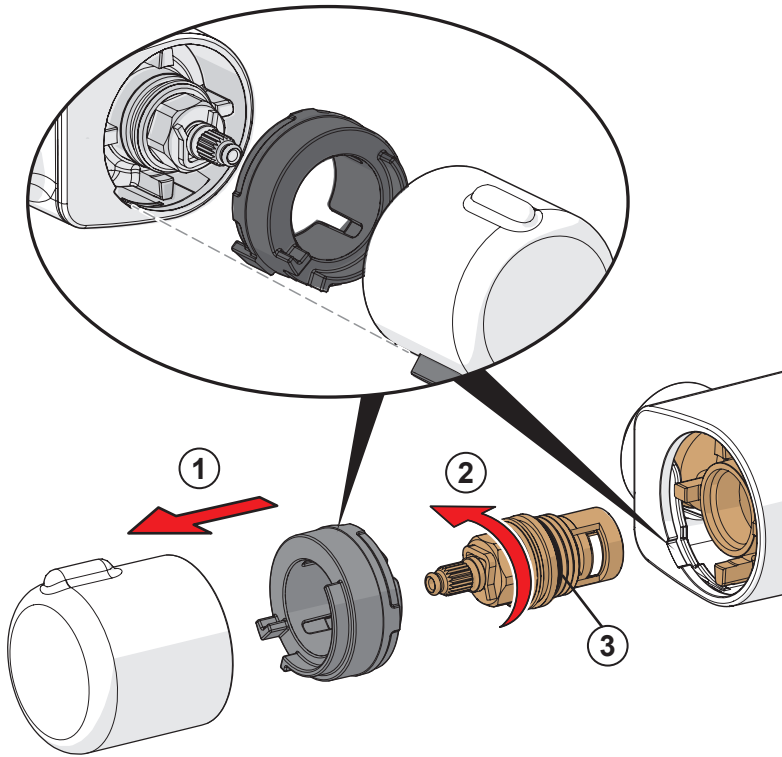
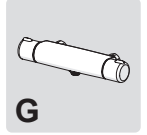
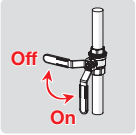

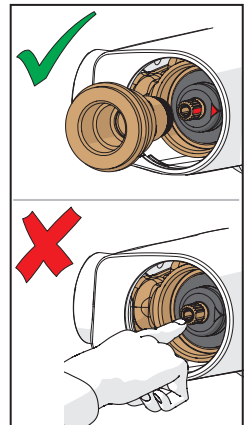
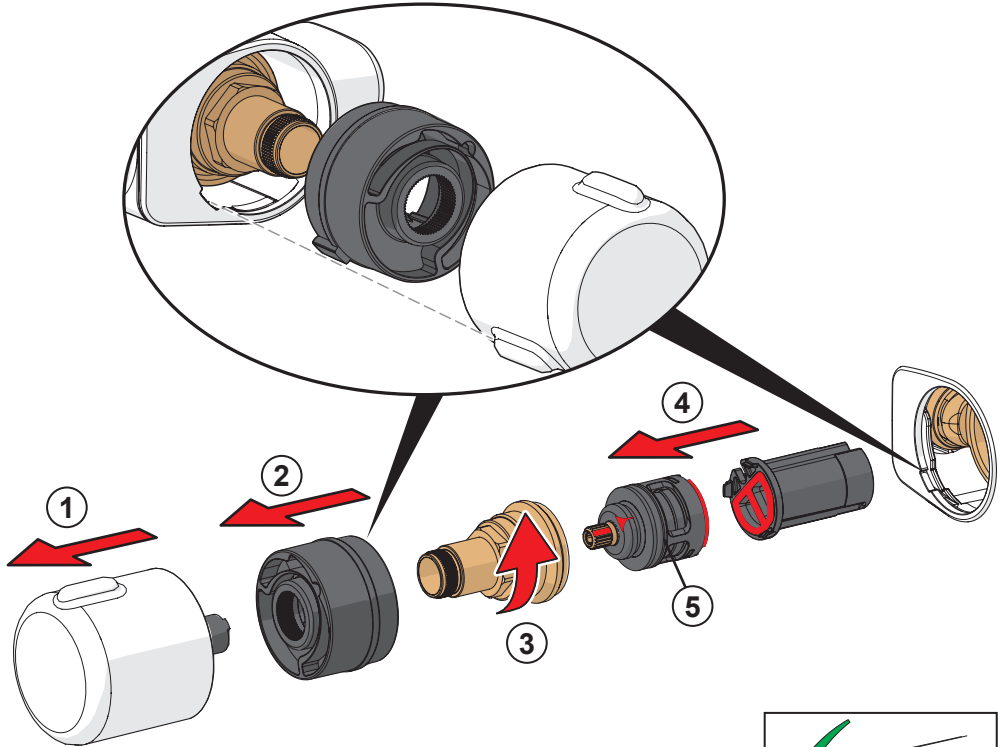
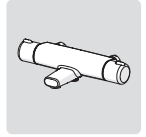
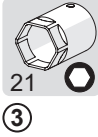
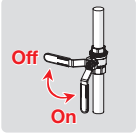
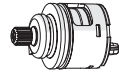

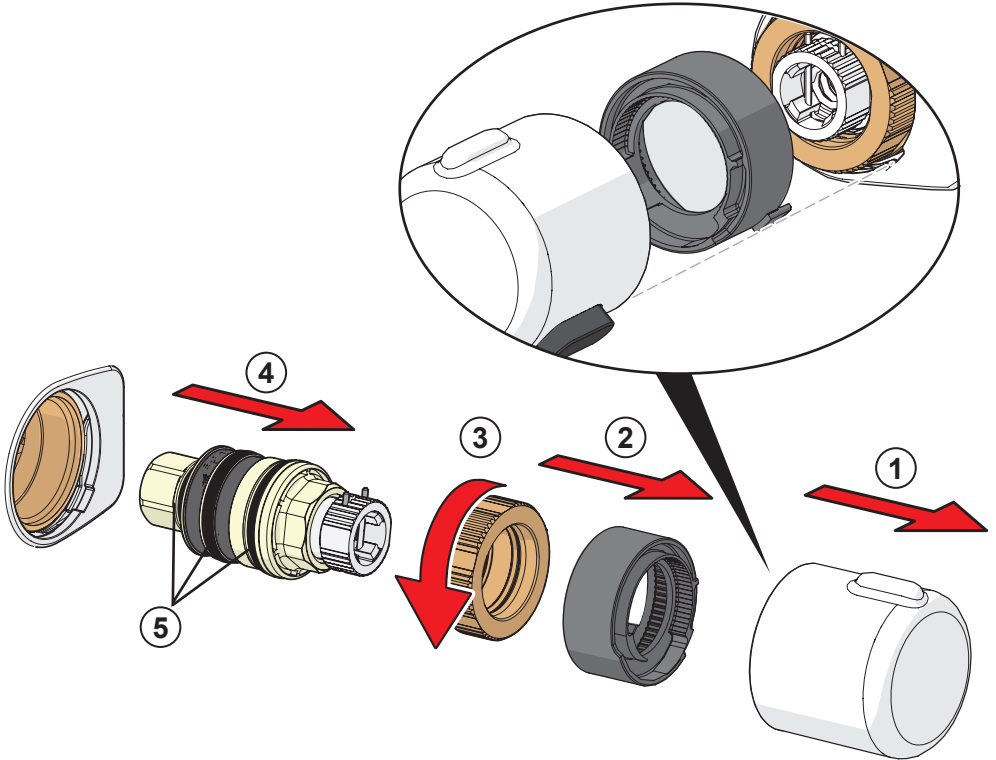
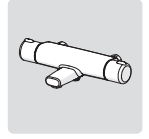
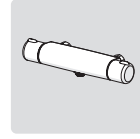
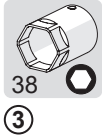

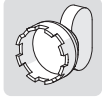

①



②

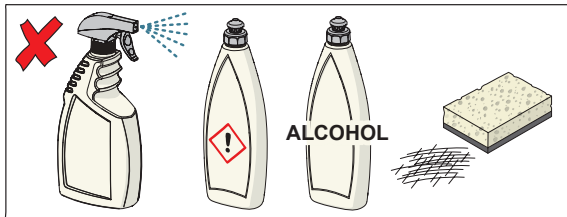
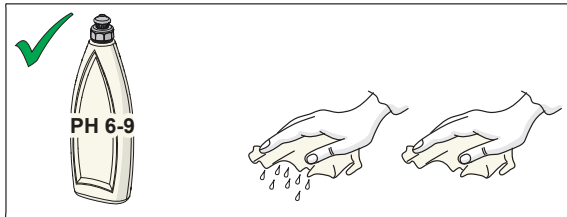
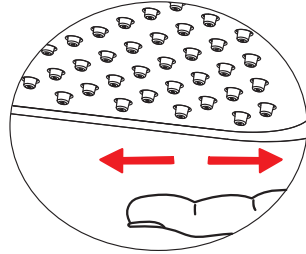
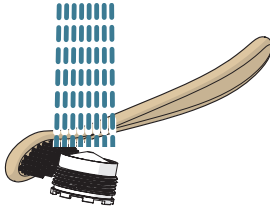

cleaning.oras.com

About Oras Group

Oras Group is a significant European provider of sanitary fittings: the market leader in the Nordics and a leading company in Continental Europe.

The company's mission is to create the smartest water experiences for everyone and its vision is to become the Perfect Flow Company.

The Group has two strong brands, Oras and Hansa. Oras Group is owned by Oras Invest, a family company, and an industrial owner.

The domicile of Oras Ltd, the parent company of the Group, is located in Rauma, Finland, and the Group has two manufacturing sites: Olesno (Poland) and Rauma (Finland).

The Group operates with its own staff in 17 markets. Oras Group's net sales were 233.5 million euros in 2021 and at the end of the period the company employed 1255 people.

ORAS Ltd
Isometsäntie 2, P.O. Box 40
FI-26101 Rauma
Tel. +358 2 83 161
Fax +358 2 831 6300
info.finland@oras.com
www.oras.com



943213-01-04-26