

Monteras ej i VVC-system.

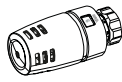

EVOSENSE

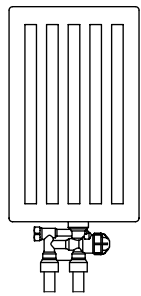
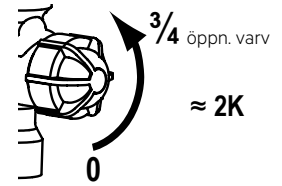
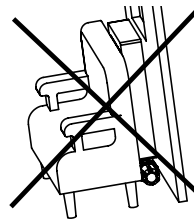
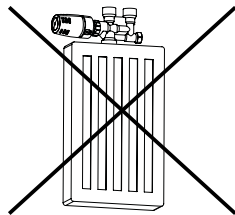
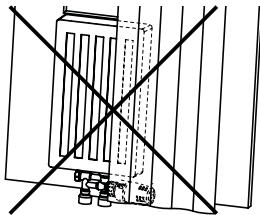
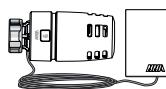

REMOTE

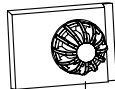

VAM



ENH



NHN



ENTL

Levererad som 2-rörsventil.

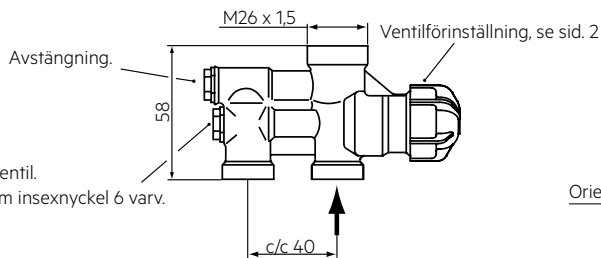

Omställning 1-2 rörsventil.
Öppna med en 2,5 mm insexnyckel 6 varv.

Montering

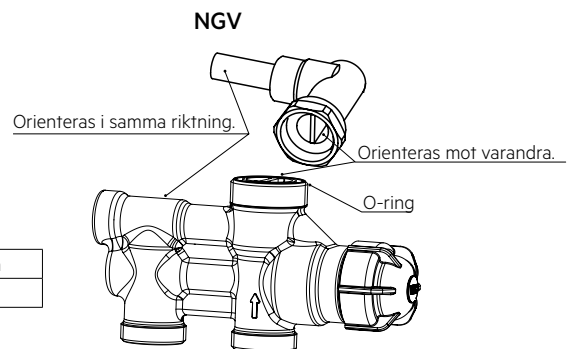
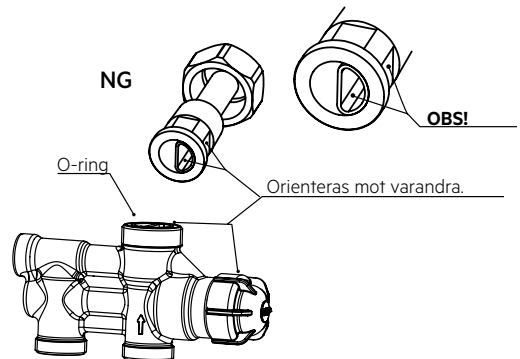

Typ	Anslutning mot rörsidan	Anslutning med NG/NGV mot radiatorn
RFA 38	M22 x 1,5	ISO-R 1/2

1-rörssystem

Kv_{2K}

(ventilförinställning fullt öppen)

Öppn. varv X Bypass	Kv total	Kv radiator	% radiator
0,5	0,62	0,50	81
1,0	0,65	0,49	76
1,5	0,74	0,48	65
2,0	0,83	0,47	56
2,5	0,95	0,45	48
3,0	1,08	0,43	40
3,5	1,25	0,40	32
4,0	1,45	0,37	26
4,5	1,65	0,34	21
5,0	1,76	0,32	18

Kv_5

(ventilförinställning fullt öppen)

Öppn. varv X Bypass	Kv total	Kv radiator	% radiator
0,5	0,76	0,63	82
1,0	0,81	0,62	77
1,5	0,86	0,61	70
2,0	0,96	0,59	61
2,5	1,06	0,57	53
3,0	1,18	0,53	45
3,5	1,33	0,50	37
4,0	1,52	0,46	30
4,5	1,70	0,42	25
5,0	1,78	0,36	20

Inställning bypass

1. Ta bort den blå plastpluggen.

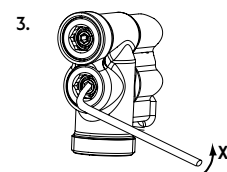
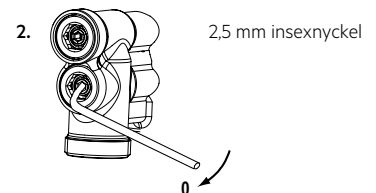

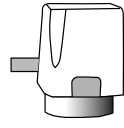
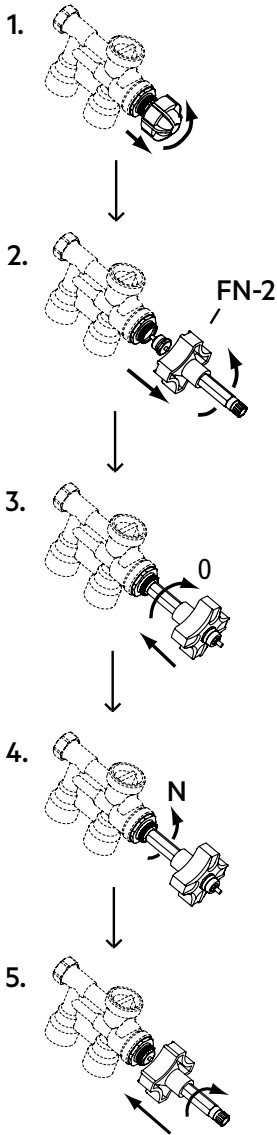

Öppna varv

N

gäller för:

Levererad i detta utförande som 2-rörsventil.
Omställning 1-rörs: öppna med en 2,5 mm
insexnyckel 6 varv.

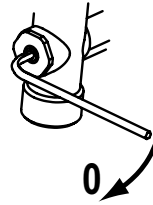

[kPa]

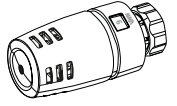

Öppna varv

N

gäller för:

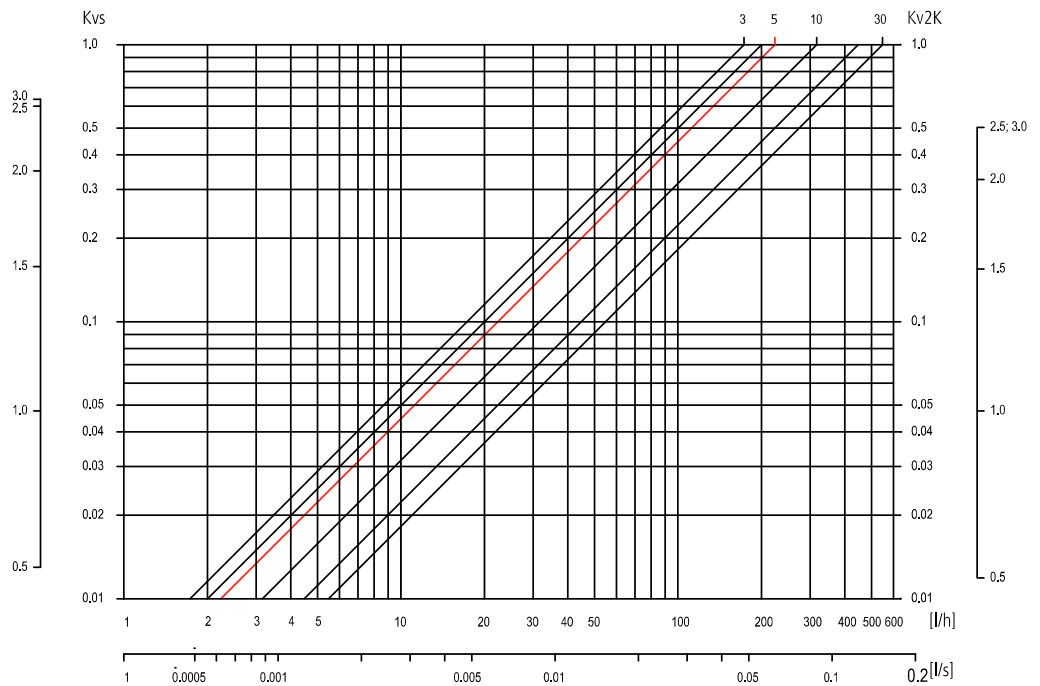

Förinställning av 2-rörssystem kan även göras med hjälp av FV5.

Distribueras av SGDS Gruppen AB

www.sgdsgruppen.se

Teknisk Support

Telefon: 020-51 55 15

E-post: tkgs@alternà.se