

Operating Guide

AMV 13

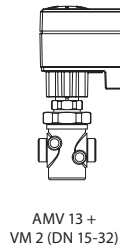

AMV 13 +
VM 2 (DN 15-32)

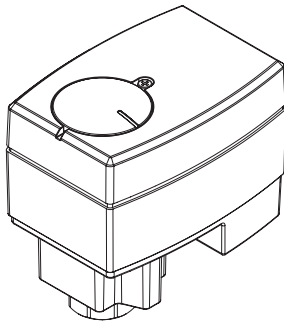
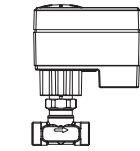

AMV 13 +
VS 2 (DN 15-25)

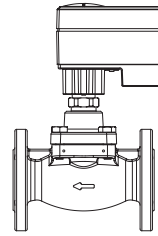

AMV 13 +
VB 2 (DN 15-25)

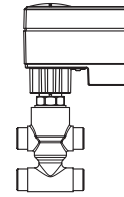

AMV 13 +
VZ (DN 15, 20)

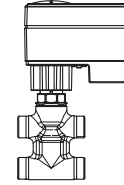

AMV 13 +
VZL (DN 15, 20)

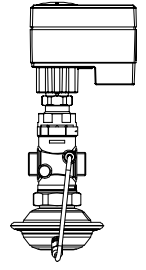

AMV 13 +
AVQM (see data sheet)



MAINTENANCE
FREE



5-95 % RH
no condensing

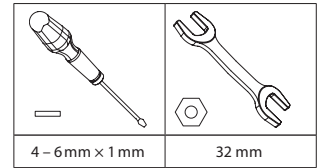
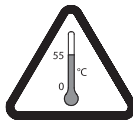

1

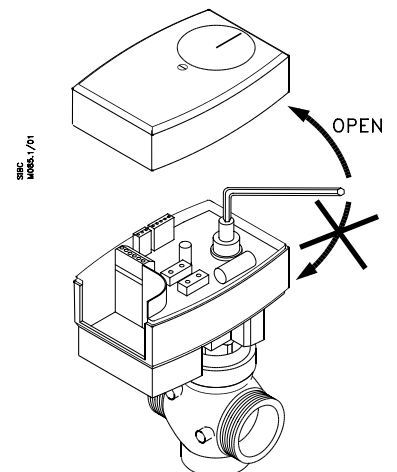
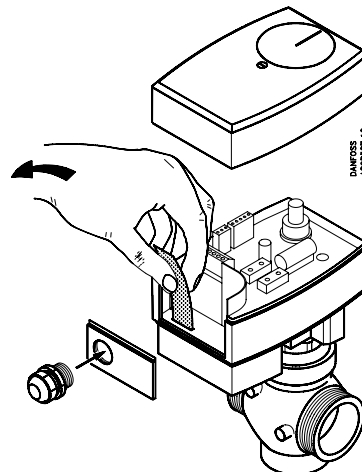
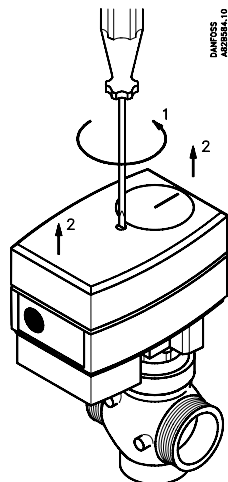
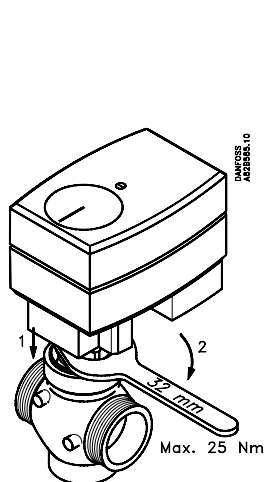
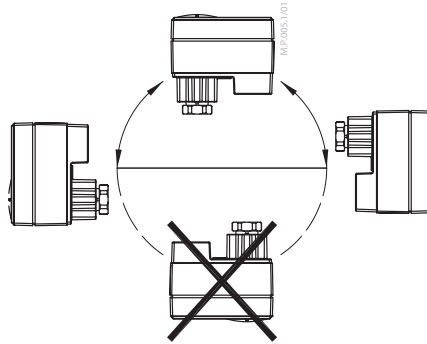

AMV 13

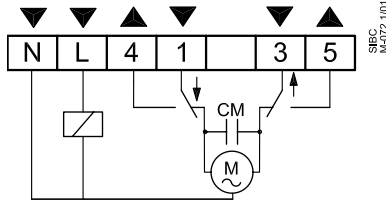
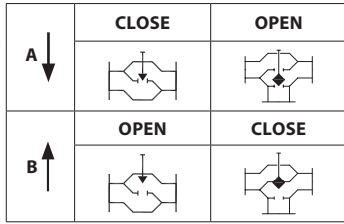

N	0 V	Neutral				
L	24/230 VAC	Power supply				
1	Input power supply	082G3004 24 V				
3		082G3003 230 V				
4, 5	<table border="1"> <tr> <td>1</td> <td>4</td> </tr> <tr> <td>3</td> <td>5</td> </tr> </table>	1	4	3	5	Output
1	4					
3	5					

4

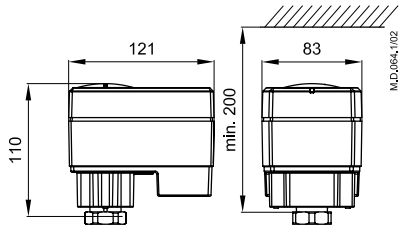

DN	H ₁	H ₂	H ₃
	mm		
15	166	145	195
20	166	152	195
25	166	158	195
32	166	-	-

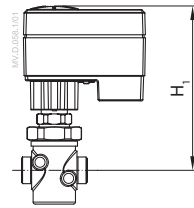

AMV 13 +
VM 2 (DN 15-32)

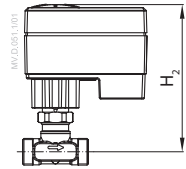

AMV 13 +
VS 2 (DN 15-25)

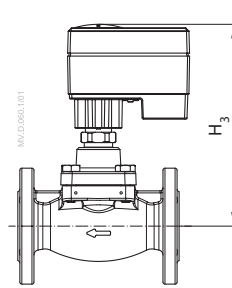

AMV 13 +
VB 2 (DN 15-25)

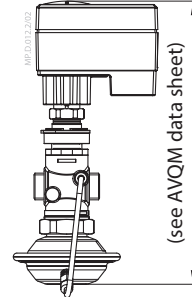

AMV 13 +
AVQM

Type	d	H ₄ (mm)
VZ 2 DN 15	G 1/2"	155
VZ 3 DN 15	G 1/2"	
VZ 4 DN 15	G 1/2"	

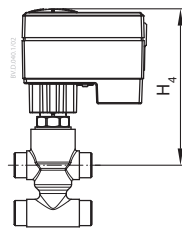

AMV 13 +
VZ (DN 15, 20)

Type	d	H ₅ (mm)
VZL 2 DN 15	G 1/2"	140
VZL 2 DN 20 ¹⁾	G 3/4"	146
VZL 3 DN 15	G 1/2"	140
VZL 3 DN 20 ¹⁾	G 3/4"	146
VZL 4 DN 15	G 1/2"	140
VZL 4 DN 20 ¹⁾	G 3/4"	146

¹⁾ conex valves DN 20 - G 1 1/8" 14 TPI

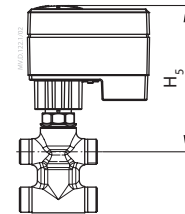

AMV 13 +
VZL (DN 15, 20)

Part Name 部件名称	Hazardous Substances Table/有害物质含量表					
	Lead (Pb) 铅 (Pb)	Mercury (Hg) 汞 (Hg)	Cadmium (Cd) 镉 (Cd)	Hexavalent Chromium (Cr(VI)) 六价铬 (Cr(VI))	Polybrominated biphenyls (PBB) 多溴联苯 (PBB)	Polybrominated diphenyl ethers (PBDE) 多溴二苯醚 (PBDE)
Brake weights/ 制动配重	X	O	O	O	O	O
Plug/塞	X	O	O	O	O	O
Electromagnet/ 电磁体	X	O	O	O	O	O

O: Indicates that this hazardous substance contained in all of the homogeneous material for this part is below the limit requirement in GB/T 26572;
O: 表示该有害物质在该部件所有均质材料中的含量均在GB/T 26572规定的限量要求以下。
X: Indicates that this hazardous substance contained in at least one of the homogeneous material for this part is above the limit requirement in GB/T 26572;
X: 表示该有害物质至少在该部件的某一均质材料中的含量超出GB/T 26572规定的限量要求。