

# Touchline Basic



D	Roth Funk-Raumbediengerät Touchline Basic	Kurzbetriebsanleitung	1135007532
F	Thermostat Radio Touchline basic	Mode d'emploi rapide	1135007532
GB	Roth Touchline Basic wireless thermostat	Brief operating instructions	1409100177
E	Termostato inalámbrico Basic Touchline	Manual de instrucciones breve	1135007532
RUS	Беспроводной комнатный регулятор	Краткая инструкция по эксплуатации	1135007532
DK	Roth Touchline Basic, rumtermostat, hvid	Kvikmanual	466393.090
SV	Roth Touchline termostat, Basic	Snabbguide	2434657
NO	Roth Touchline termostat, analog, hvit	Enkel veiledning	8358191
FI	Touchline Basic Termostaatti, valk	Pikaohje	2070902

D Installationsanweisung für die Elektrofachkraft  
 F Notice d'installation pour l'électricien  
 GB Guidelines for the electrician  
 E Instrucciones para el electricista  
 RUS Указания по монтажу для электрика  
 DK Installationsanvisning for installatør og elektriker  
 SV Installationsanvisning för installatör och elektriker  
 NO Installasjonsveiledning for installatør og elektriker  
 FI Asennusohje sähköasentajalle

IP20  
EN60529

D Für den Einsatz in üblicher Umgebung  
 F Pour usage dans un environnement normal  
 GB For use in normal environment  
 E Para el uso en ambiente normal  
 RUS Для использования в нормальных условиях эксплуатации  
 DK Kan anvendes i normale omgivelser  
 SV För placering i normal miljö  
 NO Kan brukes i normale omgivelser  
 FI Käytetään normaalissa ympäristössä

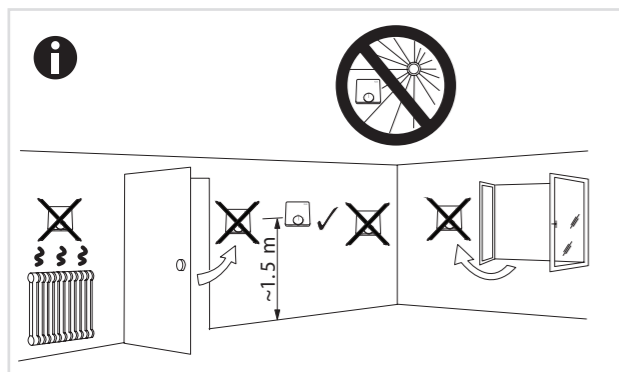

1a

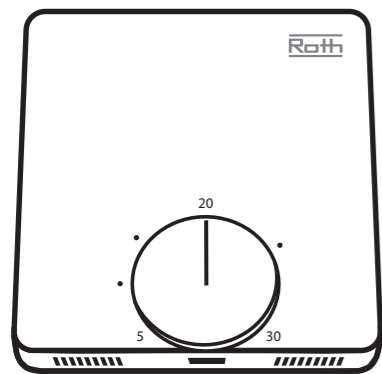

1b

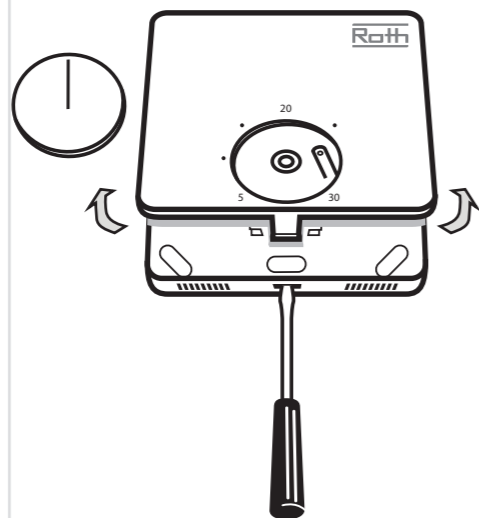

2

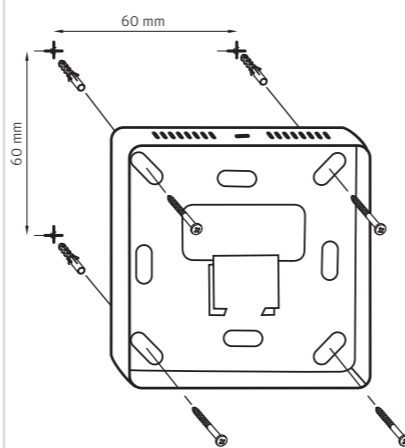

3

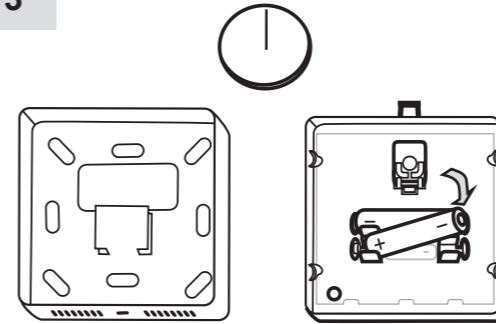

4

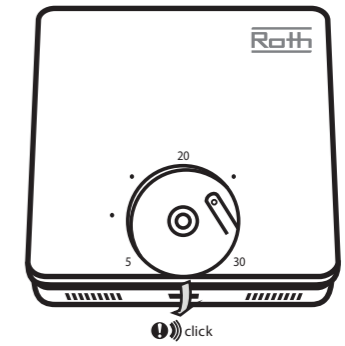

5

- D Adressierung Raumbediengerät mit einem Kanal oder mehreren Kanälen  
 F Affectation d'un thermostat d'ambiance sur un ou plusieurs canaux  
 GB Addressing room operating unit with one channel or multiple channels  
 E Direccionamiento del termostato con un canal o con varios canales  
 RUS Адресация комнатного регулятора на один или более каналов  
 DK Tilmelding af rumtermostat til en eller flere kanaler  
 SV Adressering av rumtermostat till en eller flera kanaler  
 NO Innmelding av romtermostat til en eller flere kanaler  
 FI Rekisteröi huonetermostaatti yhteen tai useampaan kanavaan

- |   |           |           |           |
|---|-----------|-----------|-----------|
| □ | aus       | ein       | blinkt    |
| ■ | éteint    | allumé    | clignote  |
| ⊙ | off       | on        | blinkning |
| ⊙ | apagado   | encendido | parpadea  |
| ⊙ | выкл.     | вкл.      | мигает    |
| ⊙ | slukket   | lyser     | blinker   |
| ⊙ | från      | till      | blinker   |
| ⊙ | slukket   | lyser     | blinker   |
| ⊙ | ei päällä | palaa     | vilkkuu   |

1

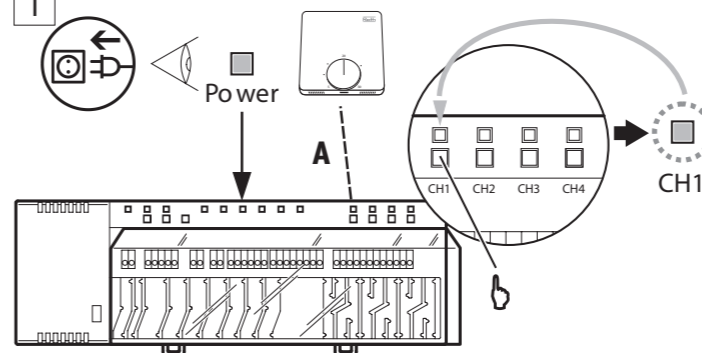

2

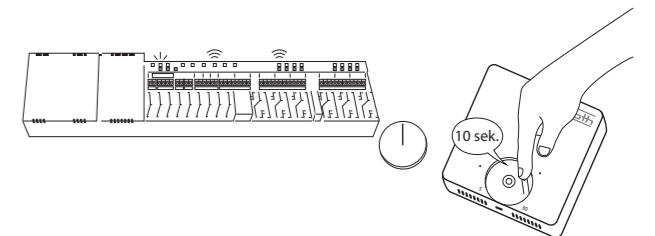

3

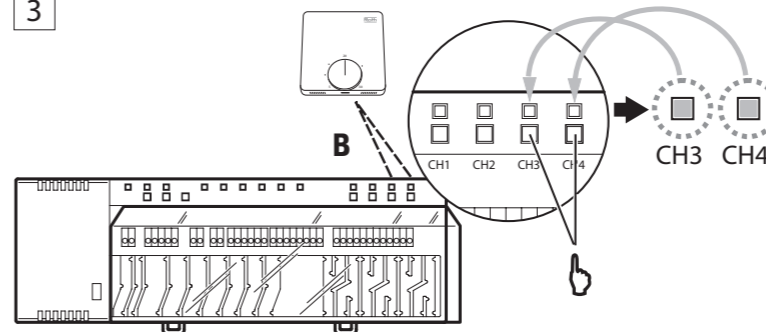

4

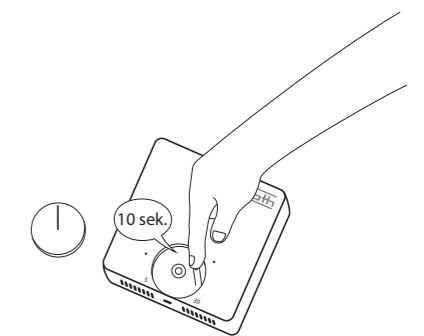

5

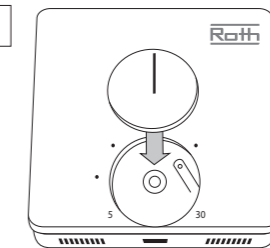

- 6**
- |    |                               |     |                            |    |                                      |
|----|-------------------------------|-----|----------------------------|----|--------------------------------------|
| D  | Adressierung testen           | E   | Probar direccionamiento    | SV | Adresseringstest                     |
| F  | Vérification de l'affectation | RUS | Проверка адресации         | NO | Test innmelding (link test)          |
| GB | Test addressing               | DK  | Test tilmelding (linktest) | FI | Rekisteröinnin testaus (yhteystesti) |

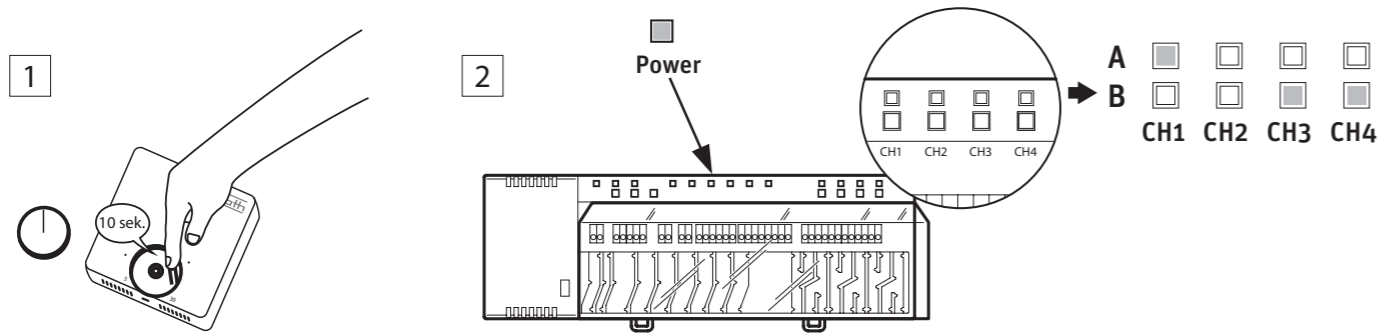

- i**
- |     |                              |           |          |                      |
|-----|------------------------------|-----------|----------|----------------------|
| D   | Adressierung löschen         | aus       | blinkt   | schnell              |
| F   | Suppression de l'affectation | éteint    | clignote | clignote rapidement  |
| GB  | Delete addressing            | off       | blinking | blinking fast        |
| E   | Borrar direccionamiento      | apagado   | parpadea | parpadea rápidamente |
| RUS | Удаление адресации           | выкл.     | мигает   | мигает чаще          |
| DK  | Slet tilmelding              | slukket   | blinker  | blinker hurtigt      |
| SV  | Ta bort adressering          | från      | blinkar  | blinkar snabbt       |
| NO  | Slett innmelding             | slukket   | blinker  | blinker raskt        |
| FI  | Rekisteröinnin purku         | ei päällä | vilkkuu  | vilkkuu nopeasti     |

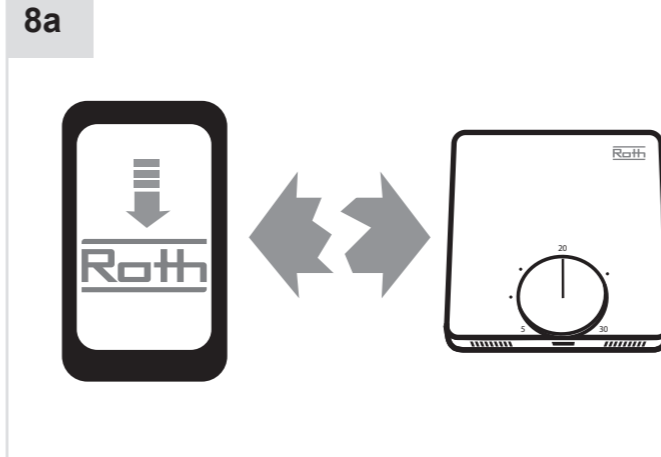
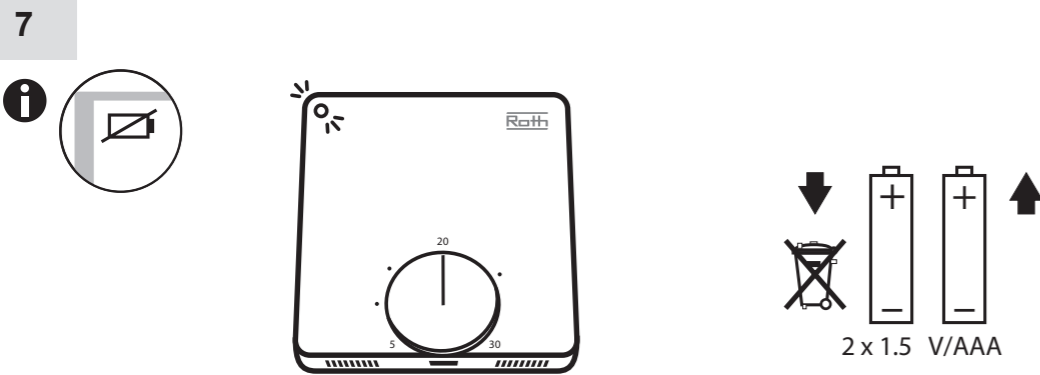
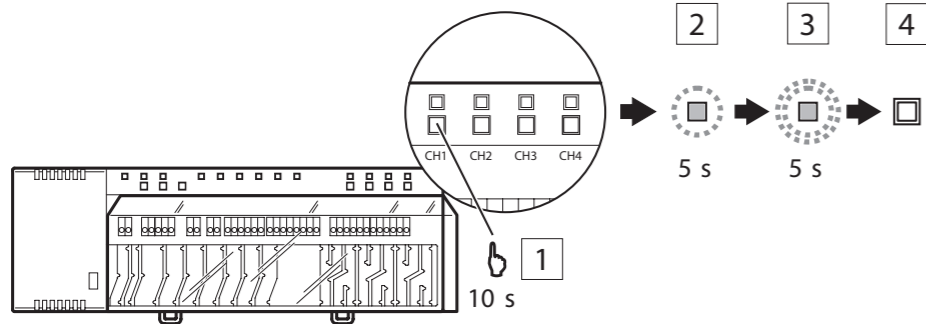

- |     |                             |
|-----|-----------------------------|
| D   | Nicht kompatibel mit APP    |
| F   | Incompatible avec l'APP     |
| GB  | Not compatible with APP     |
| ES  | No es compatible con la APP |
| RUS | Не совместим с APP          |
| DK  | Ikke kompatibel med APP     |
| SV  | Inte kompatibel med APP     |
| NO  | Ikke kompatibel med APP     |
| FI  | Ei yhteensopiva APP         |



- |     |   |
|-----|---|
| D   | Verwenden Sie immer das neuste Software-Update        |
| F   | Utilisez toujours la dernière mise à jour de logiciel |
| GB  | Always use the latest software update                 |
| ES  | Utilice siempre la última actualización de software   |
| RUS | Всегда используйте только последнюю версию ПО         |
| DK  | Anvend altid nyeste softwareopdatering                |
| SV  | Använd alltid den senaste programuppdateringen        |
| NO  | Bruk alltid den nyeste programvareopdateringen        |
| FI  | Käytä aina uusin ohjelmistopäivitys                   |



Scan the code for complete product information

- |     |                             |                     |                    |                               |                     |
|-----|-----------------------------|---------------------|--------------------|-------------------------------|---------------------|
| D   | Dokument aufbewahren        | Roth Werke GmbH     | www.roth-werke.de  | 35232 Dautphetal              | +49 (0) 6466/922-0  |
| F   | Ce document est à conserver | Roth France S.A.S   | www.roth-france.fr | 77465 Lagny sur Marne Cedex   | +33 (0) 1/64124444  |
| GB  | Retain this document        | Roth UK Ltd.        | www.roth-uk.com    | Taunton, Somerset TA4 2 R L   | +44 (0) 1984/623982 |
| E   | Conserve este documento     | Global Plastic S.A. | www.roth-spain.com | 31500 Tudela (Navarra)        | +34 948/844406      |
| RUS | Сохраните этот документ     | Roth Russia         | www.roth-russia.ru | 105120 Костомаровский пер., 3 | +7 (916) 157 69 60  |
| DK  | Opbevar dette dokument      | Roth Nordic A/S     | www.roth-nordic.dk | 3600 Frederikssund            | +45 47 38 01 21     |
| SV  | Spara dokumentationen       | Roth Nordic AB      | www.roth-nordic.se | 213 76 Malmö                  | +46 40 53 40 90     |
| NO  | Oppbevar dette dokumentet   | Roth Nordic AS      | www.roth-nordic.no | 1306 Sandvika                 | +47 67 57 54 00     |
| FI  | Säilytä tämä opas           | Roth Nordic OY      | www.roth-nordic.fi | 10300 Karjaa                  | +358 19 440 330     |