

## EJOT® H4 eco

Universal hammer-in anchor with solid steel nail and optimized expansion zone

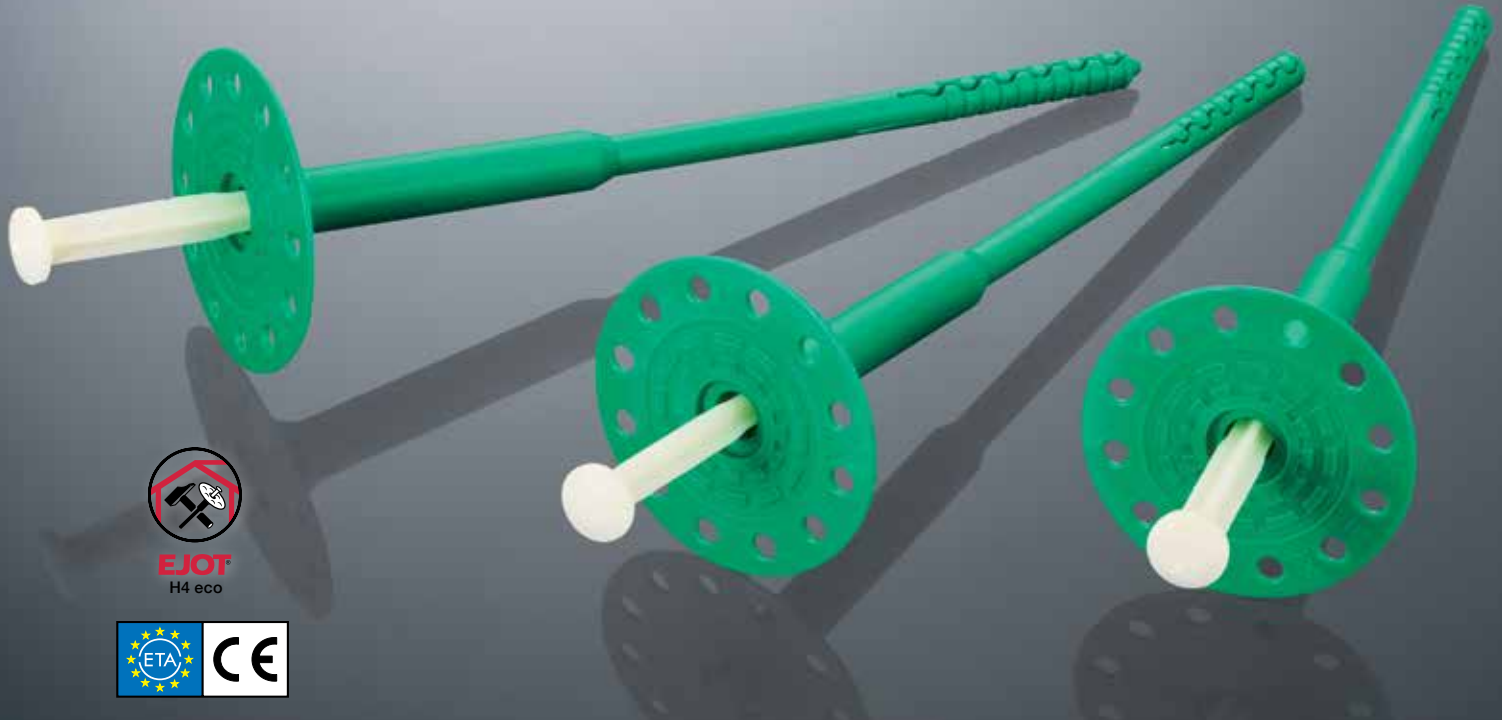

Fixing of insulation boards



### Installation

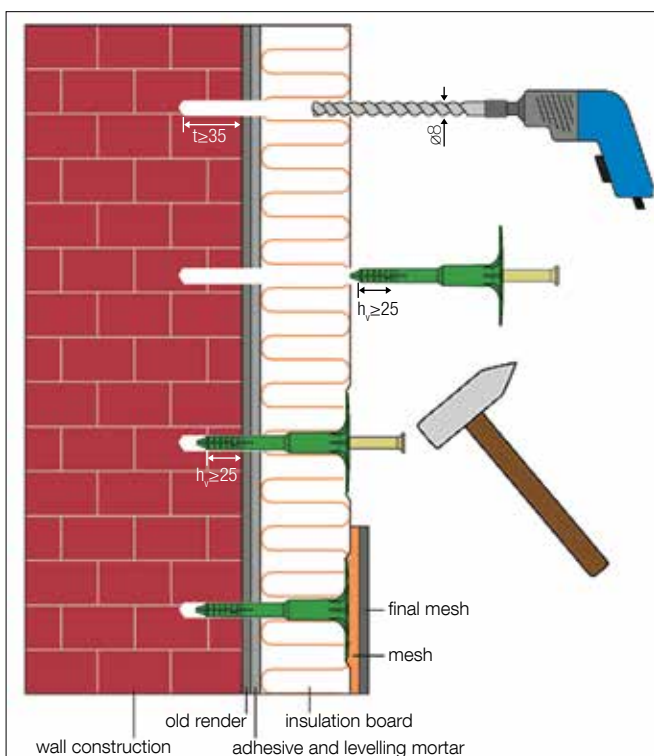

### Advantages

- ❑ Approved for all building materials (A, B, C, D, E)
- ❑ Solid steel nail (break-proof)
- ❑ Plastic injection element to reduce thermal transmission
- ❑ Universal expansion zone for more security and even grip in critical substrates
- ❑ Low profile washer face
- ❑ Can be used with an additional spreader washer
- ❑ Short embedment depth, reduced drilling
- ❑ High loads for your security
- ❑ Economic anchor usage
- ❑ Premounted anchor usage
- ❑ With EPD (Environmental Product Declaration)

## EJOT® H4 eco

Universal hammer-in anchor with solid steel nail and optimized expansion zone

### Fixing of insulation boards

#### Technical data

Anchor nominal diameter	8 mm
Washer diameter	60 mm
Drill hole depth $h_1 \geq$	35 mm (75 mm)
Embedment depth $h_{ef} \geq$	25 mm (65 mm)
Point thermal transmission $\chi$	0.002 W/K
Use categories acc. to ETA	A, B, C, D, E
European Technical Assessment	ETA-11/0192

Values in parentheses: anchoring in lightweight aggregate concrete and autoclaved aerated concrete (use categorie D, E)

#### Characteristic loads

A	Normal weight concrete C 12/15 acc. to EN 206-1	0.5 kN
	Normal weight concrete C 20/25 - C 50/60 acc. to EN 206-1	0.75 kN
B	Clay bricks (Mz) acc. to DIN 105	0.75 kN
B	Solid lime sandstone (KS) acc. to DIN EN 106	0.75 kN
C	Vertically perforated clay bricks (Hlz) acc. to DIN, bulk density, $\geq 0.9 \text{ kg/dm}^3$	0.5 kN
C	Sand-lime perforated bricks (KSL) acc. to DIN EN	0.75 kN
D	Lightweight aggregate concrete (LAC 4 - LAC 25) acc. EN 1520 / EN 771-3	0.9 kN
E	Autoclaved aerated concrete (AAC - AAC 7) acc. to EN 771-4	0.5 kN

For calculation of design loads the national safety factors have to be included (e.g. Germany: 3). Please observe the approval.

#### Accessories

A broad range of accessories is available for the EJOT H4 eco product group:

EJOT combi washer **VT 90** and **SBL 140 plus**



#### Product range

Use categories A-C Insulation (mm)		Use categories D-E Insulation (mm)		Product name and length (mm)	Product code	Packaging (pieces)	Pallet quantity (pieces)
New build. <sup>1)</sup>	Renovation <sup>2)</sup>	New build. <sup>1)</sup>	Renovation <sup>2)</sup>				
120	100	80	-	EJOT H4 eco 155	8748 155 460	100	3.000
140	120	100	80	EJOT H4 eco 175	8748 175 460	100	3.000
160	140	120	100	EJOT H4 eco 195	8748 195 460	100	3.000
180	160	140	120	EJOT H4 eco 215	8748 215 460	100	3.000
200	180	160	140	EJOT H4 eco 235	8748 235 460	100	2.000
220	200	180	160	EJOT H4 eco 255	8748 255 460	100	2.000
240	220	200	180	EJOT H4 eco 275	8748 275 460	100	2.000
260	240	220	200	EJOT H4 eco 295	8748 295 460	100	2.000

<sup>1)</sup> 10 mm adhesive

<sup>2)</sup> 10 mm adhesive and 20 mm old render