

# MB SDR 11

## Coupler with easily removable inner stop, SDR 11

Coupler MB SDR 11 with inner stop

- Gas, water and H2
- Maximum pressure: Gas 10 bar, Water 16 bar
- Material: PE 100
- Easily removable inner stop
- Safety technology
- Large insertion depth for good pipe routing (no holding devices required)
- DVGW test mark: DV-8601AU2248 and DV-8606AU2249

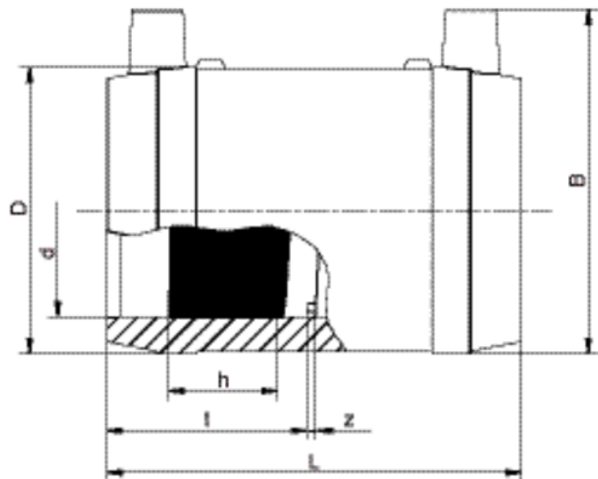

PE 100 SDR 11

Maximum permissible working pressure 16 bar (water) / 10 bar (gas)



Reference	d	SDR range	B	D	h	L	t	z	Weight kg	BX	PU
612680	20	11	49	33	17	60	29	2	0,040	110	3520
612681	25	11	54	38	17	66	32	2	0,047	90	2880
612682	32	11	61	45	21	78	38	2	0,064	60	1920
612683	40	11	71	54	23	86	42	2	0,100	40	1280
612684	50	11 - 17,6	82	68	27	98	48	2	0,150	25	800
612685	63	11 - 17,6	96	82	29	110	55	2	0,221	15	480
612686	75	11 - 17,6	110	98	32	122	60	3	0,360	50	400
612687	90	11 - 17,6	127	114	51	157	77	3	0,510	30	240
612688	110	11 - 17,6	152	137	49	159	78	3	0,710	24	192
612689	125	11 - 17,6	169	156	51	172	85	3	0,950	16	128
612690	140	11 - 17,6	185	174	52	184	91	3	1,270	12	96
612691	160	11 - 17,6	207	199	52	190	94	3	1,770	8	64



# MB SDR 11

## Coupler with easily removable inner stop, SDR 11

FRIALEN safety fittings can be fused with SDR11 - SDR17.6 pipes. Other levels of SDR can be processed on request. Please note the mandatory labels directly on the product. DVGW test marks issued: DV-8601AU2248 and DV-8606AU2249

# MB SDR 11

## Coupler with easily removable inner stop, SDR 11

### Areas of Application

The FRIALEN-coupler MB is used for pipe connections when laying long runs. Additional areas of application:

- Integration of adapters into an existing pipe-line
- Connection of pipelines with fixed or restraint points
- Reinforcement / sealing of localised pipe damage
- Reinforcement of pinch points

### Assembly Instructions

The fusion of pipe ends with the FRIALEN-coupler MB takes place using FRIALEN-fusing – leakproof and longitudinally strong.

The pipe ends are prepared according to the general installation instructions (see "Assembly Instructions" for "FRIALEN-Safety Fittings for house connections and distribution pipes up to d 225"). This involves removing the oxide skin and cleaning the pipe ends. Please note that spigot of valves must be at least half as long as the coupler.

### Good reasons for using the FRIALEN Coupler MB:

- Large coupler depth for ease of pipe guiding (no holding clamps required)
- Extra wide fusion zones
- Maximum stability through great wall thickness
- Cold zones at the front side and in the middle of the coupler
- Exposed heating coil for direct heat transmission to the pipe
- Small annular gap for build-up of optimum joining pressure in the fusion zone
- Touch proof electric contacts
- Fusion indicator for visual fusion control
- Durable batch marking
- Individually wrapped for dirt protection
- Additional barcode for tracing back the fitting (Traceability-Coding)