

# UB SDR 17

## Coupler without inner stop, SDR 17

Coupler UB SDR 17 without inner stop

- Gas and water
- Maximum pressure: Gas 5 bar, Water 10 bar
- Material: PE 100
- Safety technology
- Separate fusion zone from d 400
- Large insertion depth for good pipe routing (no holding devices required)
- DVGW test mark: DV-8611AU2250 and DW-8610CN0420

**Note**

From nominal size 560 with preheating technology and from nominal size 1000, only one FRIAMAT XL is to be utilised, which is available as a loan device under Order No. 613091.

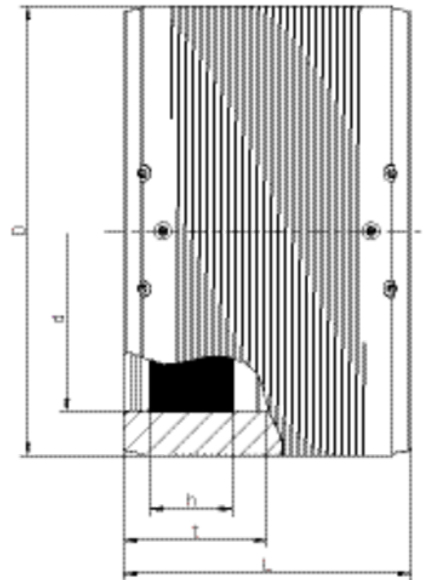

PE 100 SDR 17

Maximum permissible working pressure 10 bar (water) / 5 bar (gas)



Reference	d	SDR range	B	D	h	L	t	Weight kg	BX	PU
616529	315	17 - 26	358	356	72	280	140	5,880	1	18
616530	355	17 - 26	402	400	70	290	145	7,600	1	18
616531	400	17 - 26	452	450	78	300	150	10,100	1	9
616532	450	17 - 26	508	506	87	320	160	13,650	1	4
616533	500	17 - 26	564	562	85	350	175	18,250	1	4
615706	560	11-33	632	630	77	380	190	24,190	1	2
615726	630	11-33	712	710	101	420	210	34,870	1	2
615994	710	17-33	802	800	112	442	221	46,000	1	2

# UB SDR 17

## Coupler without inner stop, SDR 17

Reference	d	SDR range	B	D	h	L	t	Weight kg	BX	PU
616290	800	17-33	902	900	137	500	250	65,900	1	1
616345	900	17-33	1026	1024	110	500	250	91,500	1	1
616403	1000	17-33	1132	1130	129	610	305	128,000	1	1
616416	1200	17-33	1358	1356	155	670	335	205,000	1	1

Please note the mandatory labels directly on the product. DVGW test marks issued:

DV-8611AU2250 and DW-8610CN0420

# UB SDR 17

## Coupler without inner stop, SDR 17

### Areas of Application

The FRIALEN-Coupler UB is used for cut and lay pipe connections.

Additional areas of application:

- Integration of adapters into an existing pipeline
- Connection of pipelines with fixed or restraint points
- Reinforcement / sealing of localised pipe damage
- Reinforcement of pinch points on small dimensions

### Assembly Instructions

The fusion of pipe ends with the FRIALEN-Coupler UB takes place using FRIALEN-fusing – leakproof and longitudinally strong.

The pipe ends are prepared according to the general installation instructions (see "Assembly Instructions" for "FRIALEN-Safety Fittings for house connections and distribution pipes up to d 225" and "FRIALEN-Special Technology for laying large bore pipes and relining pipe networks"). This involves removing the oxide skin and cleaning the pipe ends. Please note that spigot of valves must be at least half as long as the coupler.

To compensate a larger annular gap (> 1 mm, max. 3 mm) between coupler and pipe, the pre-heating barcode can be used for couplers UB from d 560 (see instructions packed up with the coupler). Preheating is already integrated in the two-phase fusion process of the couplers UB-XL from d 1000.

For removal of the oxide layer, FWSG scraper tools are available which facilitate a uniform swarf removal and a reproducible quality of the fusion area preparation.

For large couplers UB-XL from d 1000, the powerful fusion unit FRIAMAT XL is to be used. The FRIAMAT XL is an all-purpose unit and operates with an input voltage of 400V, output voltage of max. 80V.

### Good reasons for using the FRIALEN-Slide-over Coupler UB:

- Large coupler depth for ease of pipe guiding (no holding clamps required)
- Extra wide fusion zones
- Maximum stability through great wall thickness
- Cold zones at the front side and in the middle of the coupler
- Exposed heating coil for direct heat transmission to the pipe
- Small annular gap for build-up of optimum joining pressure in the fusion zone
- Touch proof electric contacts
- Fusion indicators for visual fusion control
- From d 560: pre-heating technique for a optimal gap-bridging
- From d 315: External reinforcement for an ideal fusion pressure
- Durable batch marking
- Individually wrapped for dirt protection
- Additional barcode for tracing back the fitting (Traceability-Coding).