

TRANSITION PIECE WITH FEMALE THREAD

round

Systems: aquatherm green pipe,
aquatherm blue pipe,
aquatherm lilac pipe

Material: Fusiolen® PP-R, brass
Fusiolen® PP-R, stainless steel

Standard: DIN 16962, DIN EN ISO 15874

Colour: green

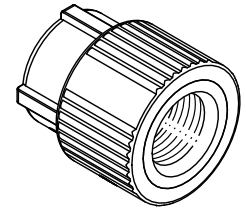
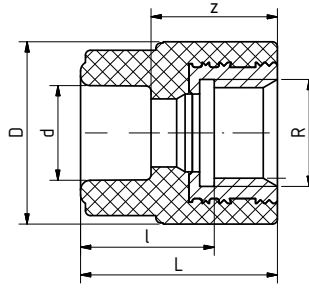

SDR	Art.-No.	d	R	l	z	D	L	Weight [kg]	System	PU	Box unit
brass											
6 7,4 9 11	21006	16	1/2"	28,00	28,00	38,50	41,00	0,066	•	10	
	21008	20	1/2"	27,50	26,00	37,50	40,50	0,064	• • •	10	400
	21010	20	3/4"	27,50	26,00	43,50	40,50	0,089	• • •	10	300
	21011	25	1/2"	29,50	26,50	38,50	42,50	0,065	• • •	10	400
	21012	25	3/4"	27,50	24,50	43,50	40,50	0,087	• • •	10	300
	21013	32	3/4"	30,50	25,50	43,50	43,50	0,092	• • •	5	250