

BGA 2"

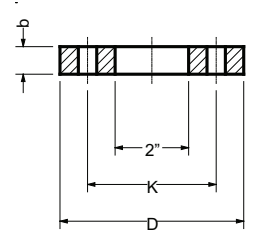

Blindfläns Galv med 2" gänga

Lev nr	RSK-nr	d (PE)	DN	D	K	b	Borrad PN	Bult	Status
BGA80	2420082	90mm	80	200	160	20	10-16	8xM16	✓
BGA100	2420083	110-125mm	100	220	180	20	10-16	8xM16	✓
BGA125	2420084	140mm	125	250	210	22	10-16	8xM16	✓
BGA150	2420085	160-180mm	150	285	240	22	10-16	8xM20	✓
BGA200	2420086	200-225mm	200	340	295	25	10	8xM20	✓
BGA250	2420087	250-280mm	250	395	350	27	10	12xM20	✓
BGA300	2420088	315mm	300	463	400	27	10	12xM20	✓
BGA350	2420089	355mm	350	515	460	27	10	16xM20	✓
BGA400	2420090	400mm	400	575	515	27	10	16xM24	✓
BGA500	2420091	450-500mm	500	675	620	30	10	20xM24	✓
BGA600	2420092	560-630mm	600	790	725	33	10	20xM27	✓
BGA700	2420448	710mm	700	895	840	38	10	24xM27	✓

D, K och b = mått i mm. DN = nominell diameter 2" = G50

BGA16 2"

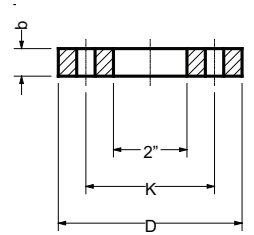

Blindfläns Galv med 2" gänga, PN16

Lev nr	RSK-nr	d (PE)	DN	D	K	b	Borrad PN	Bult	Status
BGA16200	2820289	200-225mm	200	340	295	25	16	12xM20	✓
BGA16250	2820290	250-280mm	250	409	355	27	16	12xM24	✓
BGA16300	2820291	315mm	300	463	410	27	16	12xM24	✓
BGA16350	2820292	355mm	350	515	470	27	16	16xM24	✓
BGA16400	2820293	400mm	400	574	525	27	16	16xM27	✓

D, K och b = mått i mm. DN = nominell diameter 2" = G50