

**Furniture handrinse basin # 070445..00 / 070445..60**

|&lt; 450 mm &gt;|

Vero

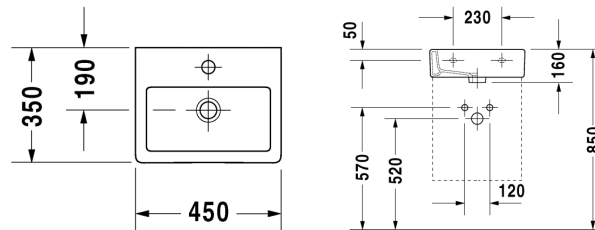

Furniture handrinse basin	Dimension	Weight	Order number
with overflow, with tap platform, 450 mm			
450 mm ●	450 x 350 mm	11,500 kg	070445..00
450 mm(Kopie) ☒	450 x 350 mm	11,500 kg	070445..60
<b>Colors</b>			
00 White(Alpin), 08 #general.ColorName_08			
<b>Accessories</b>			
Fixing	ø 10 x 140 mm	0,200 kg	695100
Space saving siphon	1 1/4" mm	0,400 kg	005013

All drawings contain the necessary measurements which are subject to standard tolerances. They are stated in mm and are non-binding. Exact measurements, in particular for customised installation scenarios, can only be taken from the finished ceramic piece.